



## Engineering Change Order 0410 – Swivel Balls & U-Bolt Modules

Applies from Serial Number 2190300

Date of Change January 2019

### Change Summary

#### 0830-03 (US Only)

- Swivel balls added to centre frame pivot points
- Module mount plates deleted (move to u-bolt mounting of modules)

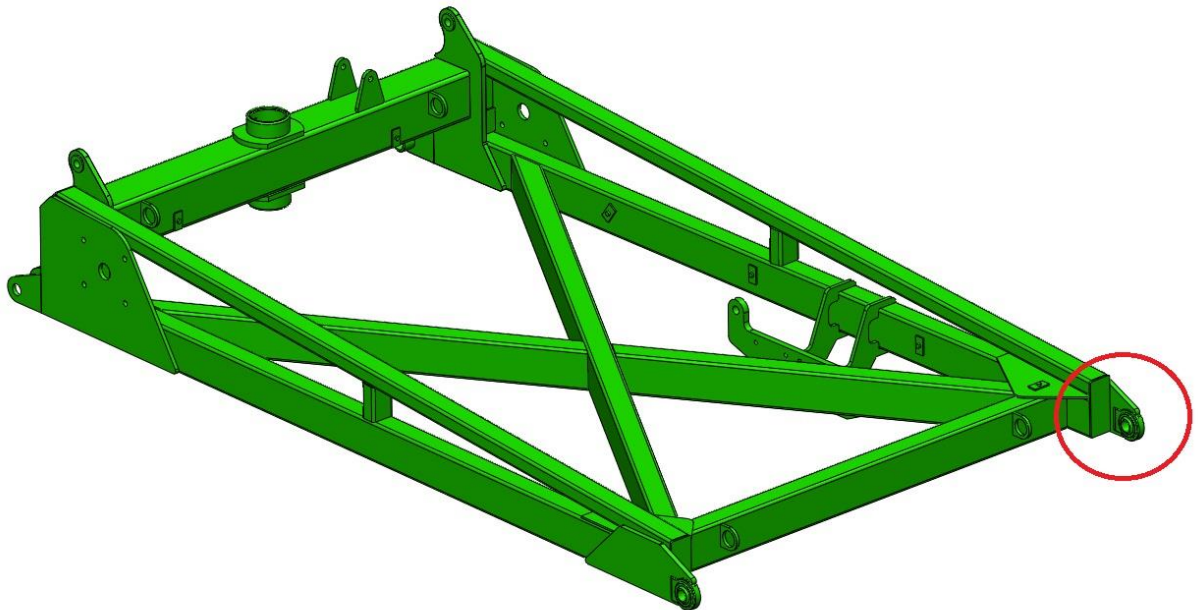

Replaces:	n/a
Machines Affected:	30'
Assembly Manuals Changed	Y
Technical Bulletin	n/a



## Engineering Change Order 0410 – Swivel Balls & U-Bolt Modules

### 0830-10E (US only)

- Swivel balls added to rear A-frame pivot points

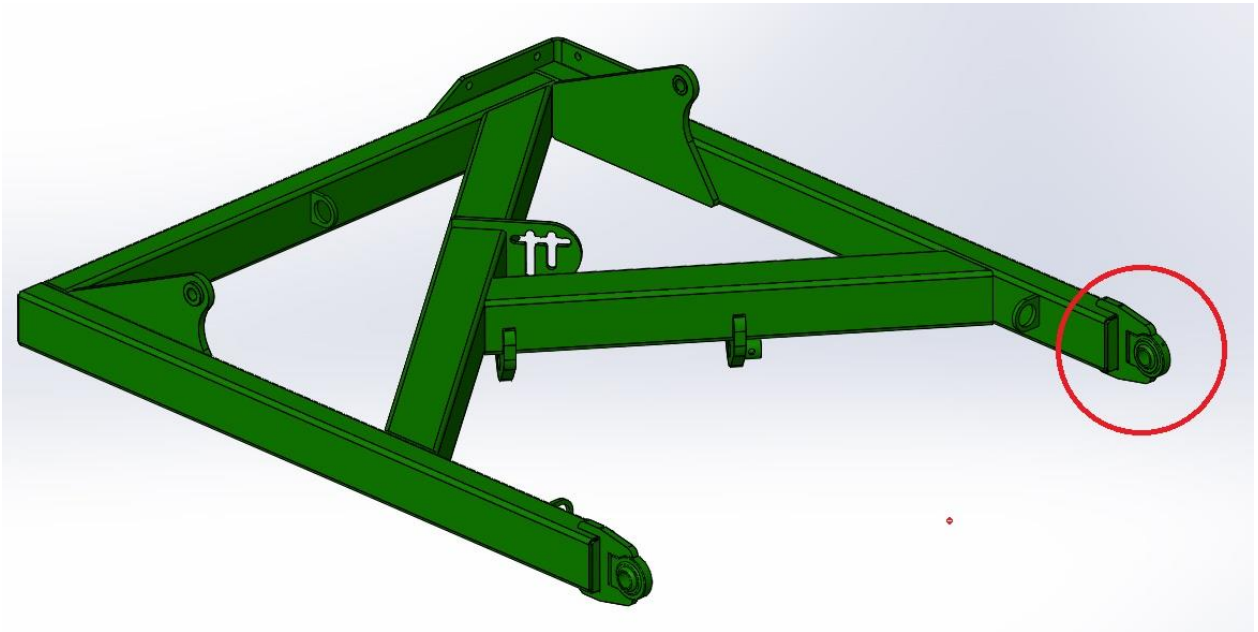

Replaces:	n/a
Machines Affected:	30'
Assembly Manuals Changed	Y
Technical Bulletin	n/a



## Engineering Change Order 0410 – Swivel Balls & U-Bolt Modules

### 0810-28-30 (US only)

- Module mount plates modified to u-bolt configuration
- Fastener kit modified to u-bolts

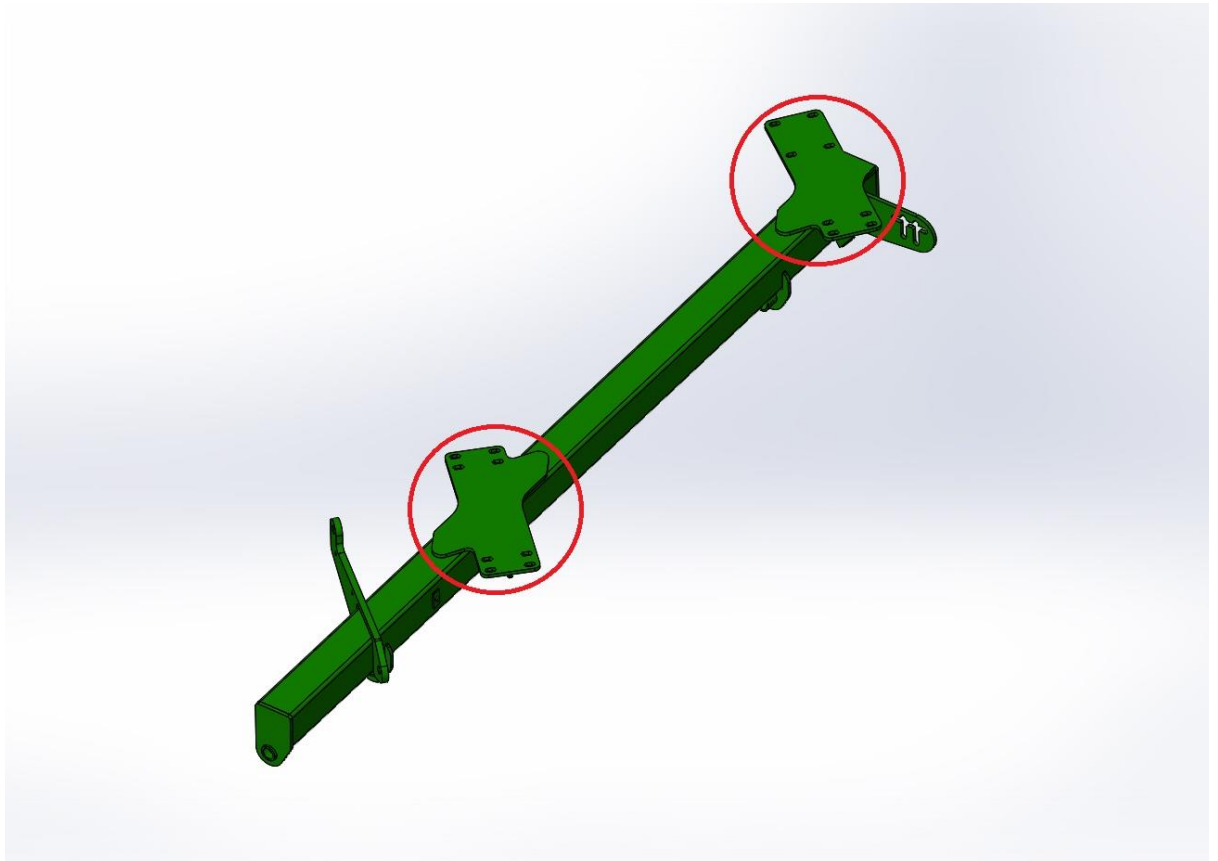

Replaces:	n/a
Machines Affected:	30'
Assembly Manuals Changed	Y
Technical Bulletin	n/a



## Engineering Change Order 0410 – Swivel Balls & U-Bolt Modules

### 0810-29-30 (US only)

- Module mount plates modified to u-bolt configuration
- Fastener kit modified to u-bolts

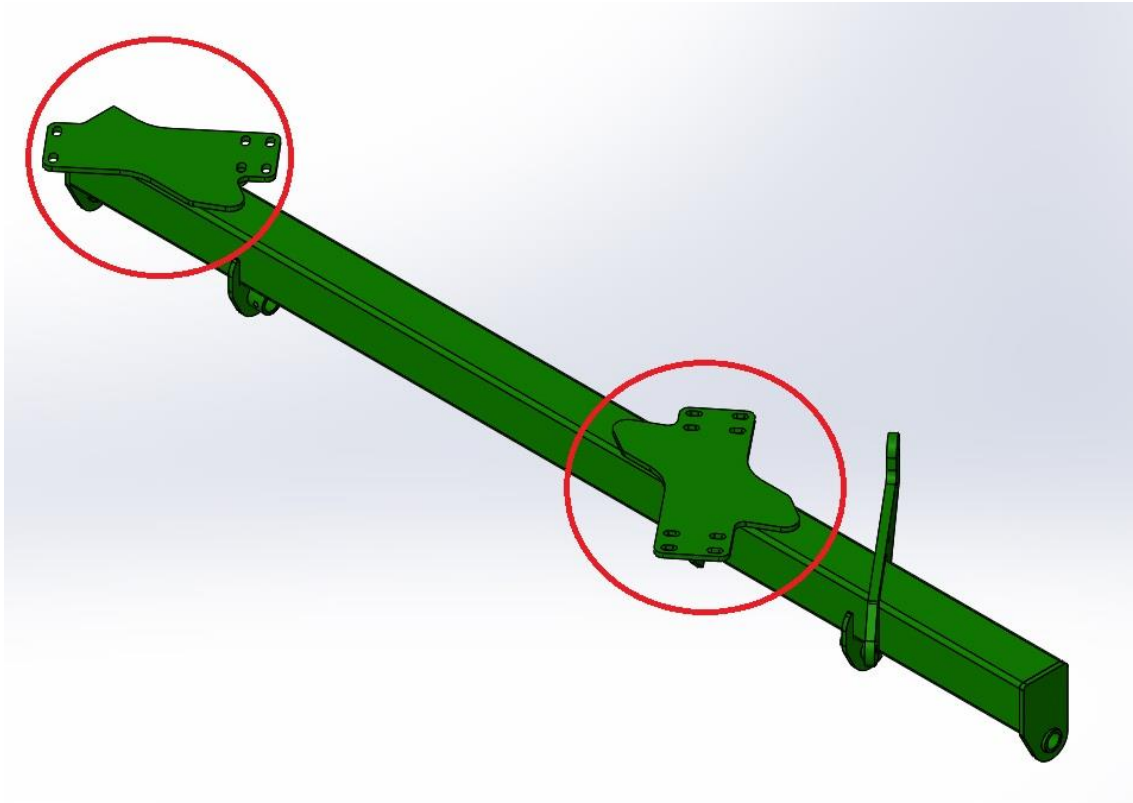

Replaces:	n/a
Machines Affected:	30'
Assembly Manuals Changed	Y
Technical Bulletin	n/a



## Engineering Change Order 0410 – Swivel Balls & U-Bolt Modules

1646-03-1

- Swivel balls added to centre frame pivot points

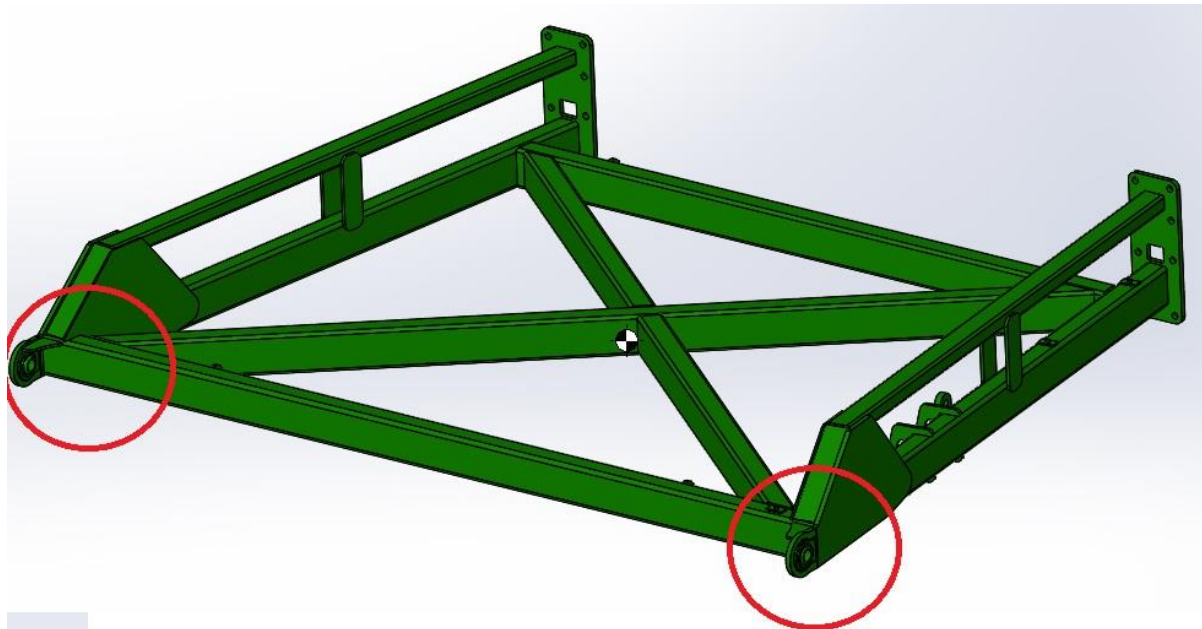

Replaces:	n/a
Machines Affected:	Model 46
Assembly Manuals Changed	Y
Technical Bulletin	n/a



## Engineering Change Order 0410 – Swivel Balls & U-Bolt Modules

### 1610-10S-REM

- Swivel balls added to rear A-frame pivot points

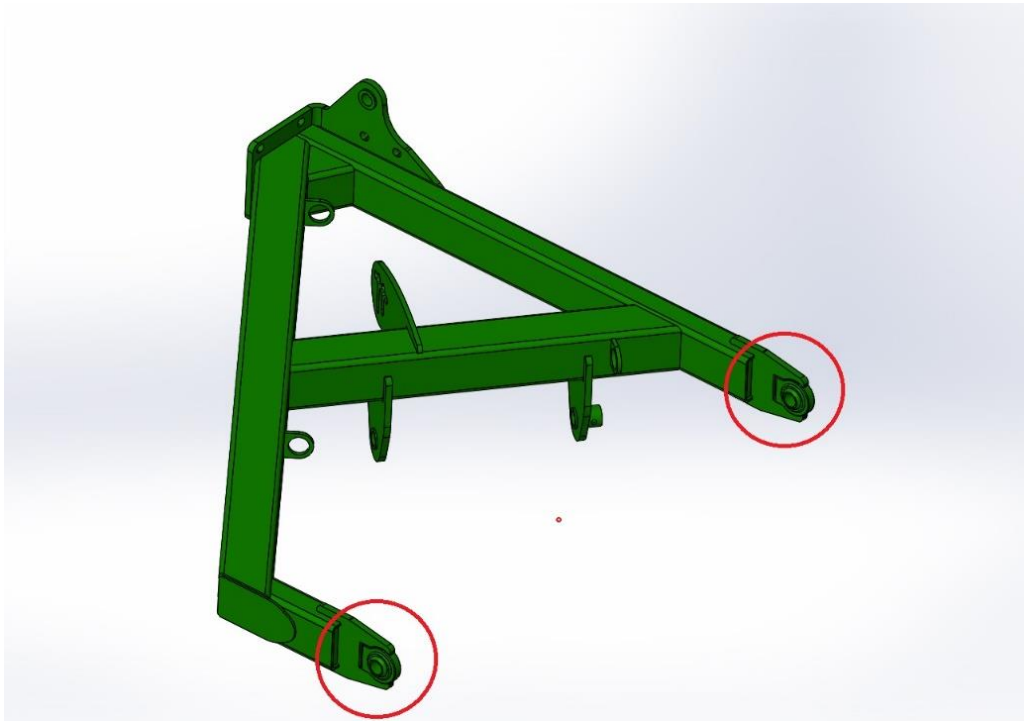

- Swivel balls added to rear A-frame pivot points

Replaces:	n/a
Machines Affected:	Model 46
Assembly Manuals Changed	Y
Technical Bulletin	n/a