

# Kelly Seeder

Kelly

## Kelly Seeder Assembly Manual

Revision B - September 2020

Serial Number:



Kelly Tillage  
PO Box 100  
Booleroo Centre  
South Australia 5482  
P +61 8 8667 2253  
W [kellytillage.com](http://kellytillage.com)

# Thank you for choosing a Kelly Seeder system

We trust that you find the following manual clear and easy to follow. However, should you require additional customer support or assistance, please do not hesitate to contact us.

Spare parts can be purchased, as required, through your local dealer or by contacting Kelly directly.

Kelly welcomes feedback. Should you have any difficulties that you wish to raise, suggestions for improvement or modifications that you feel would enhance our products, we look forward to hearing from you.

## Contact Information

**Australia**  
**Kelly Tillage**  
**PO Box 100**  
**Booleroo Centre SA**  
**Australia 5482**

**Phone:** + 61 8 8667 2253  
**Email:** [sales@kellytillage.com](mailto:sales@kellytillage.com)  
**Spare Parts:** [parts@kellytillage.com](mailto:parts@kellytillage.com)  
**Website:** [www.kellytillage.com](http://www.kellytillage.com)

**USA**  
**Hood & Company Inc**  
**Springfield MO**  
**Phone:** +1 417 865 2100  
**Email:** [hoodco@hoodco.com](mailto:hoodco@hoodco.com)

**Canada**  
**Adair Sales & Marketing Company Inc**  
**Swift Current SK**  
**Phone:** +1 306 773 0996  
**Email:** [info@adairreps.com](mailto:info@adairreps.com)



# Contents

<b>Section 1: Assembly</b>	<b>Page no</b> <b>4</b>
<b>Section 2: Diagrams &amp; Specifications</b>	<b>31</b>

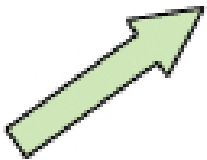

This symbol indicates which way the machine is travelling

# Section 1

Assembly

Item No.	Number	Description	Qty
1	0212-5-161	5/16 x 1" G8 ZP Bolt	4
2	0232-F5-16	Washer Flat 5/16"	20
3	0231-S516	Washer Spring 5/16"	8
4	0222-5-16	5/16" ZP Hex Nut	10
6	0212-5-1634	5/16 x 3/4" G8 ZP Bolt	6
7	1700-08	Tarp Bracket	2
8	1700-42	Tarp Holder Back	1
9	1710-30	Corner Protector	1
10	1701-32	Mesh	1

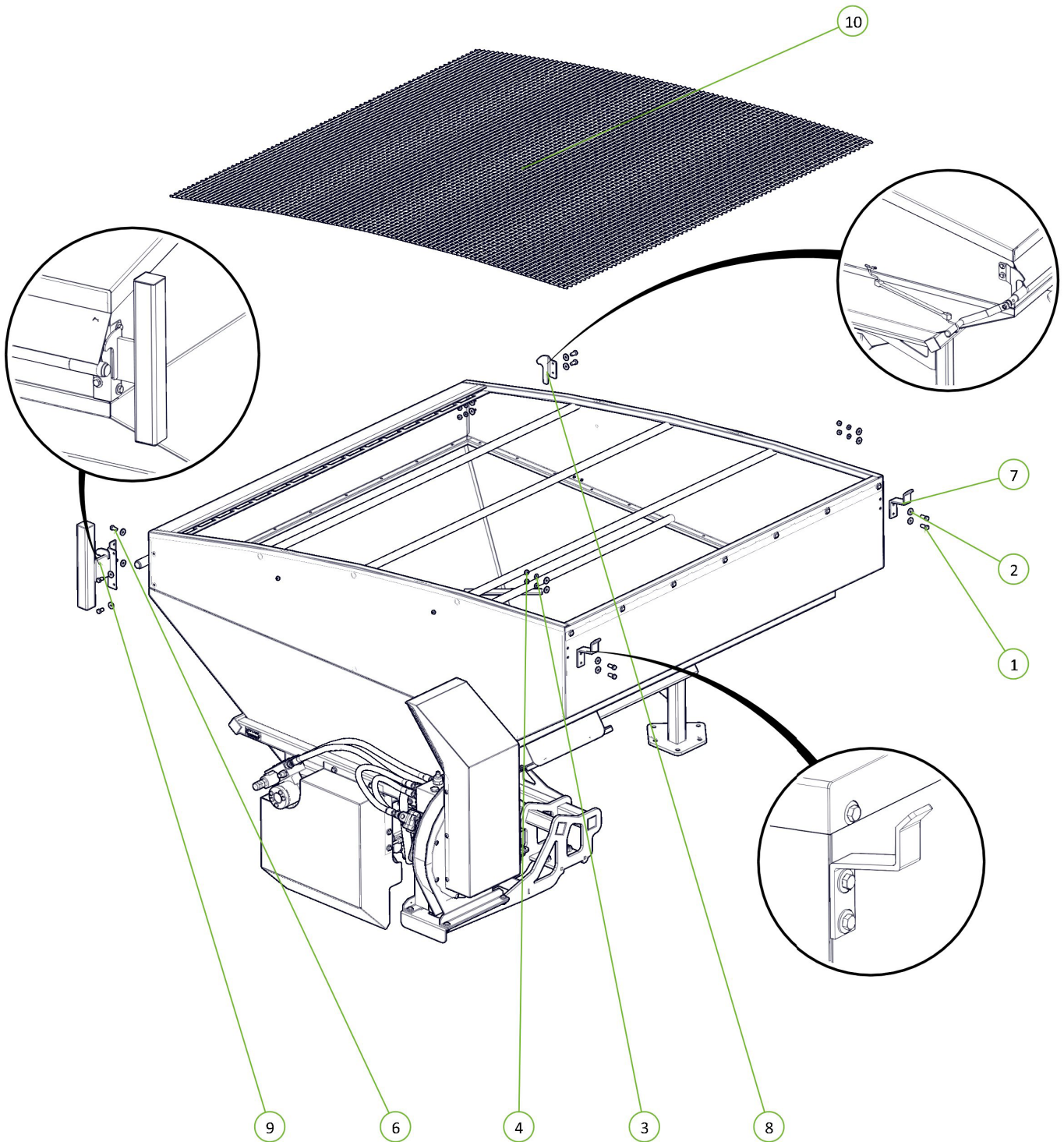
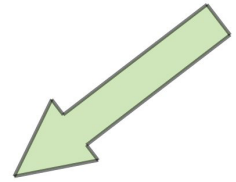

Item No.	Number	Description	Qty
1	0271-16185104	U-Bolt M16 x 190 Deep X 106 Wide	7
2	0221-NYL16	Nyloc Nut M16	14

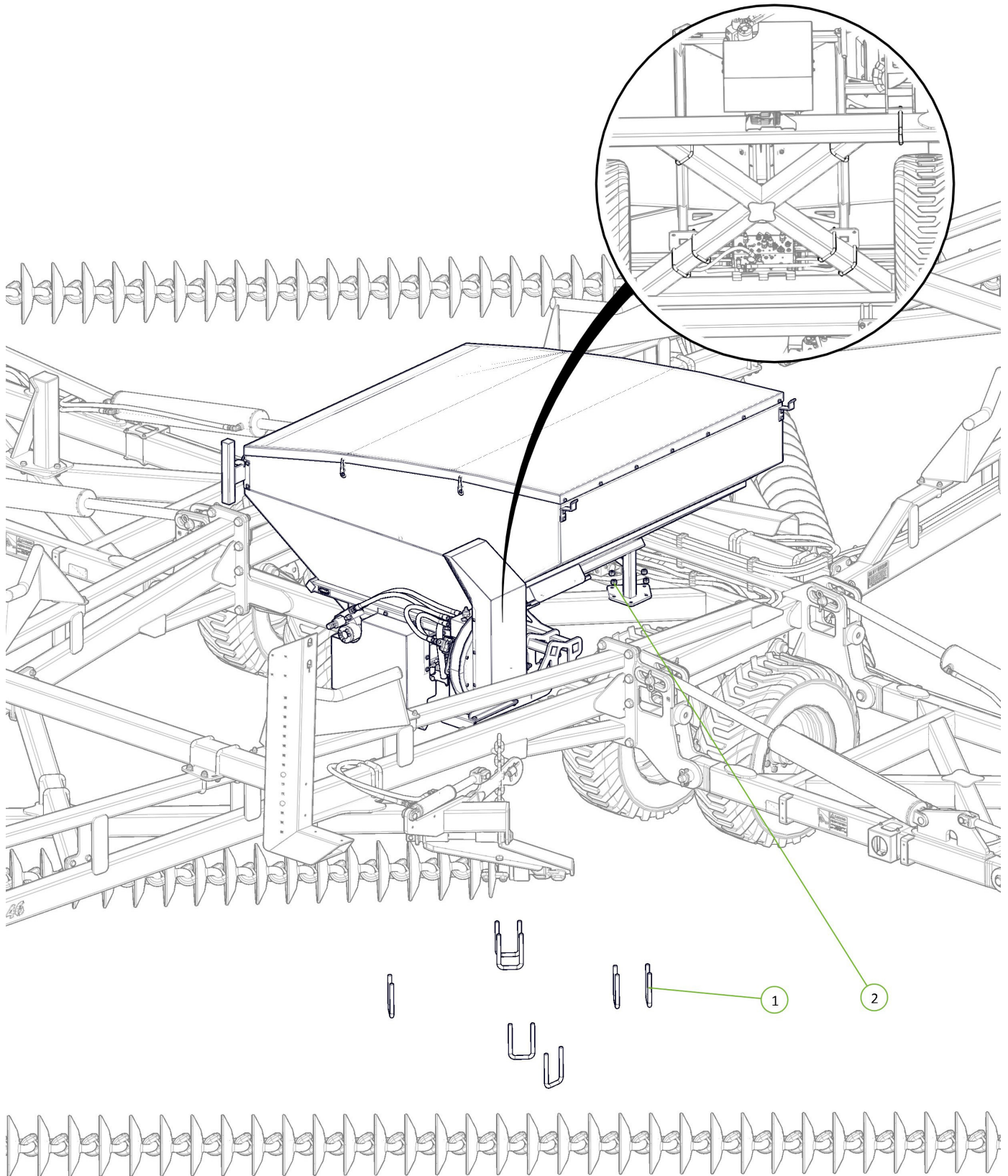
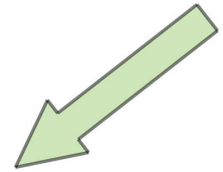



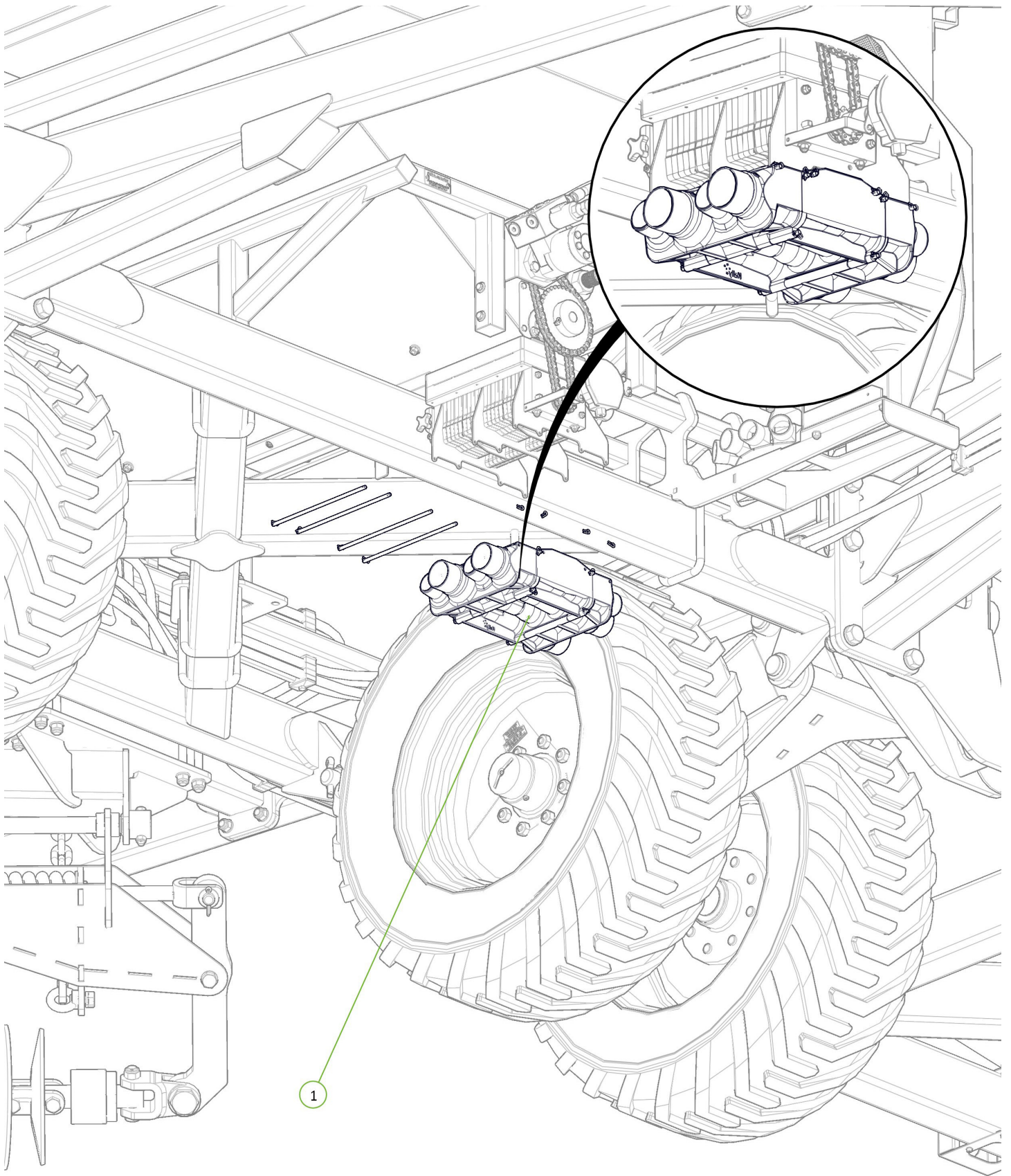

Item No.	Number	Description	Qty
1	1710-37	4 Section Venturi Manifold	1

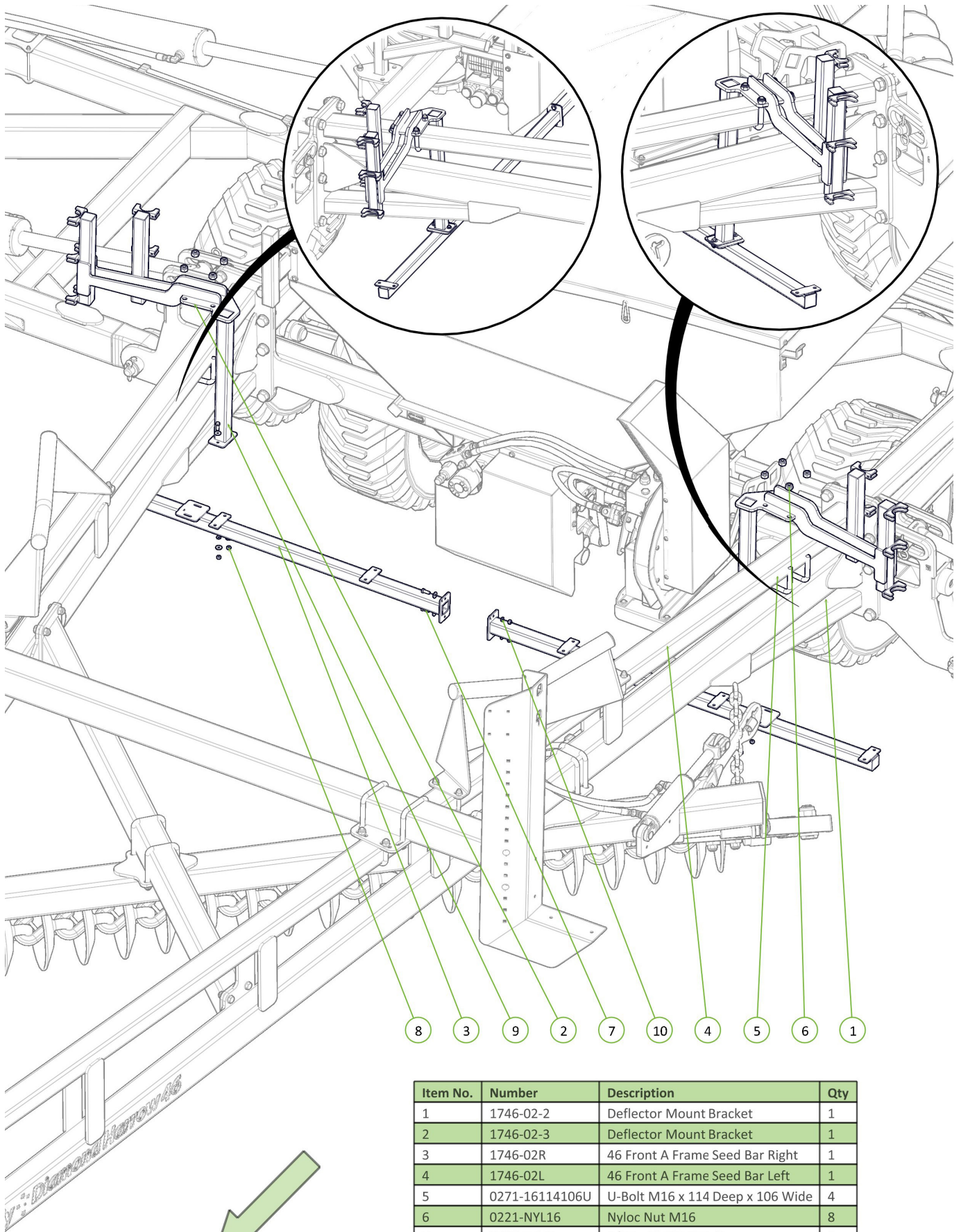

Item No.	Number	Description	Qty
1	1746-02-2	Deflector Mount Bracket	1
2	1746-02-3	Deflector Mount Bracket	1
3	1746-02R	46 Front A Frame Seed Bar Right	1
4	1746-02L	46 Front A Frame Seed Bar Left	1
5	0271-16114106U	U-Bolt M16 x 114 Deep x 106 Wide	4
6	0221-NYL16	Nyloc Nut M16	8
7	0212-5-161	5/16 x 1" G8 ZP Bolt	6
8	0222-5-16	5/16" ZP Hex Nut	6
9	0232-F5-16	Washer Flat 5/16"	10
10	0232-S516	Washer Spring 5/16"	6



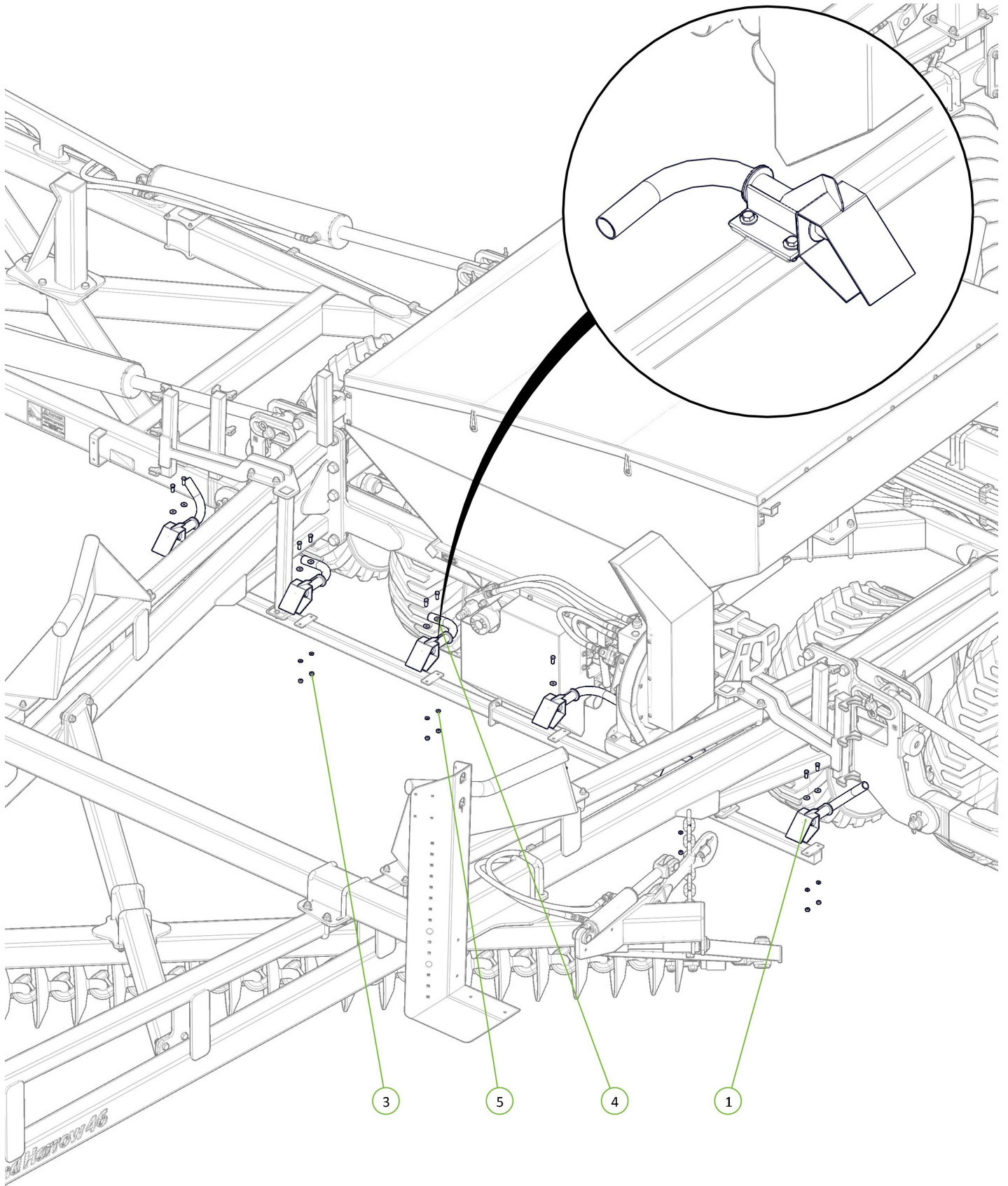

Item No.	Number	Description	Qty
1	1710-01	Deflector - Weldment	6
3	0222-5-16	5/16" ZP Hex Nut	12
4	0232-F5-16	Washer Flat 5/16"	12
5	0231-S516	Washer Spring 5/16"	12

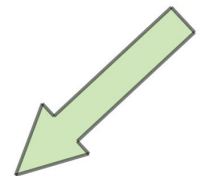

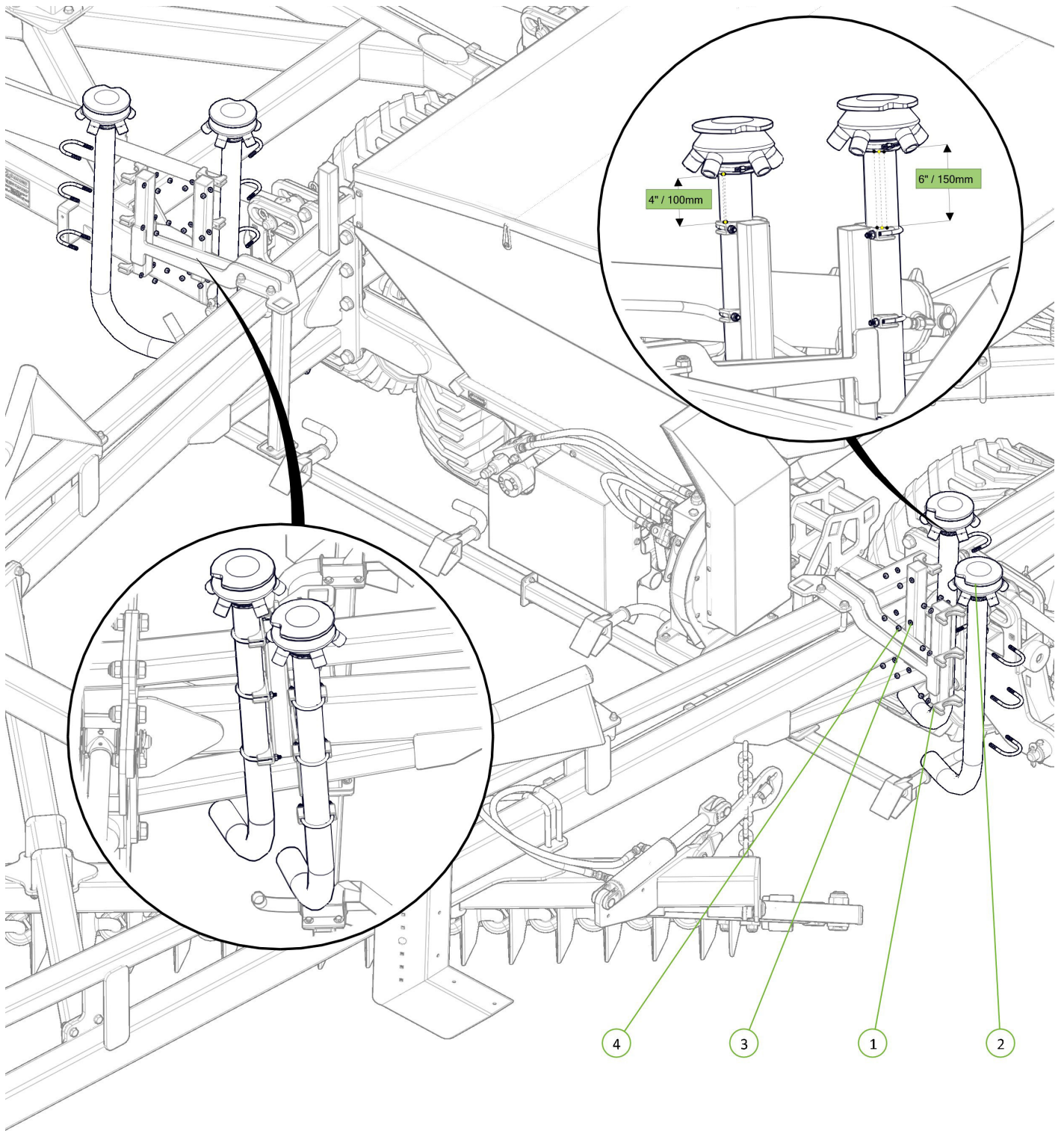

Item No.	Number	Description	Qty
1	1710-39A	2.5" Seed Head Assembly	4
2	0274-5163525	5/16 x 3.5 x 2.5" Ubolt	12
3	0232-S516	Washer Spring 5/16"	24
4	0222-5-16	5/16" ZP Hex Nut	24

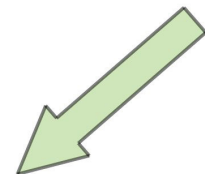



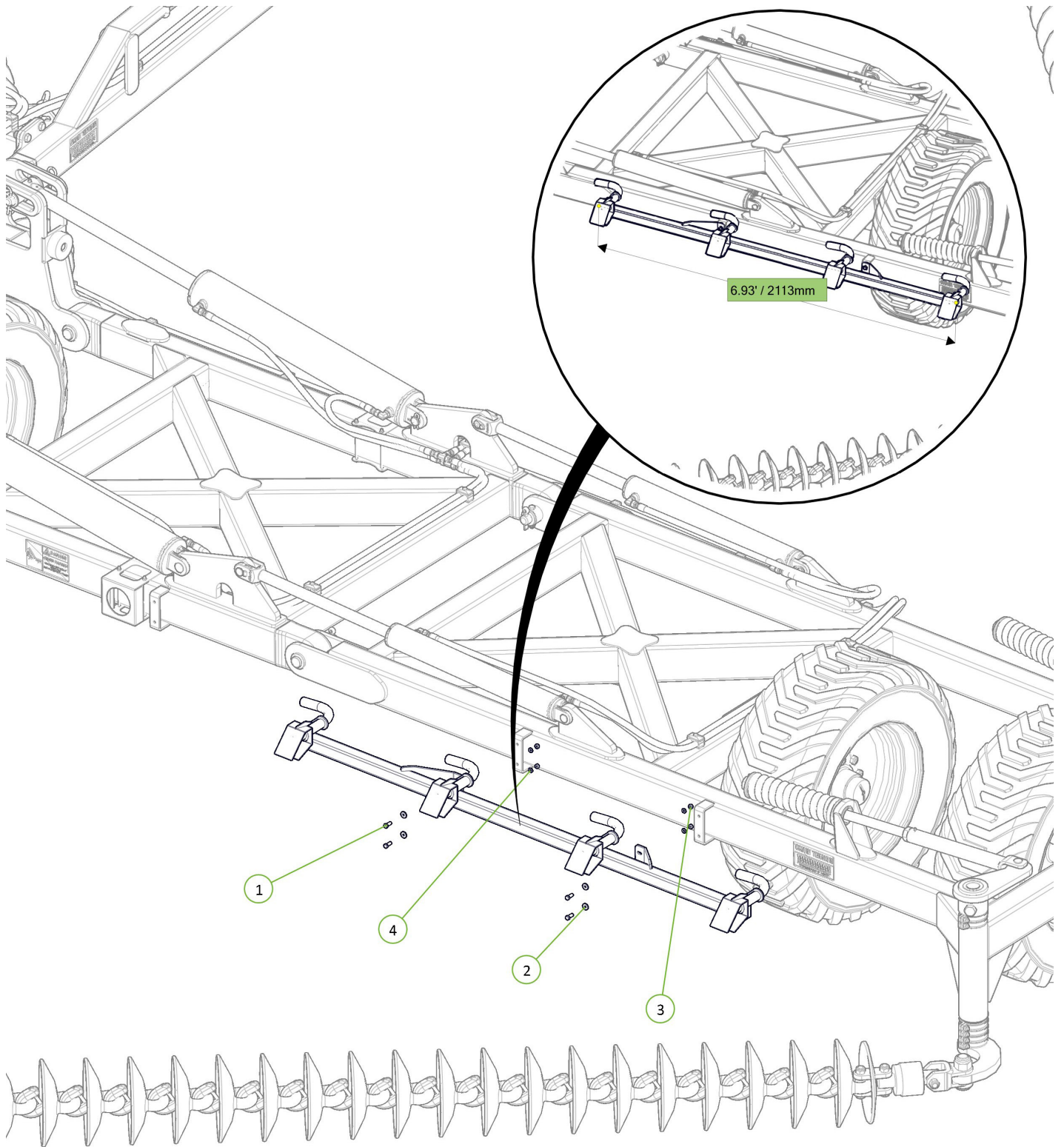

Item No.	Number	Description	Qty
1	0212-5-161	5/16 x 1" G8 ZP Bolt	4
2	0232-F5-16	Washer Flat 5/16"	4
3	0222-5-16	5/16" ZP Hex Nut	4
4	0231-S516	Washer Spring 5/16"	4

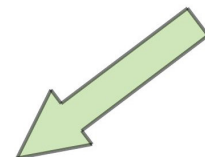

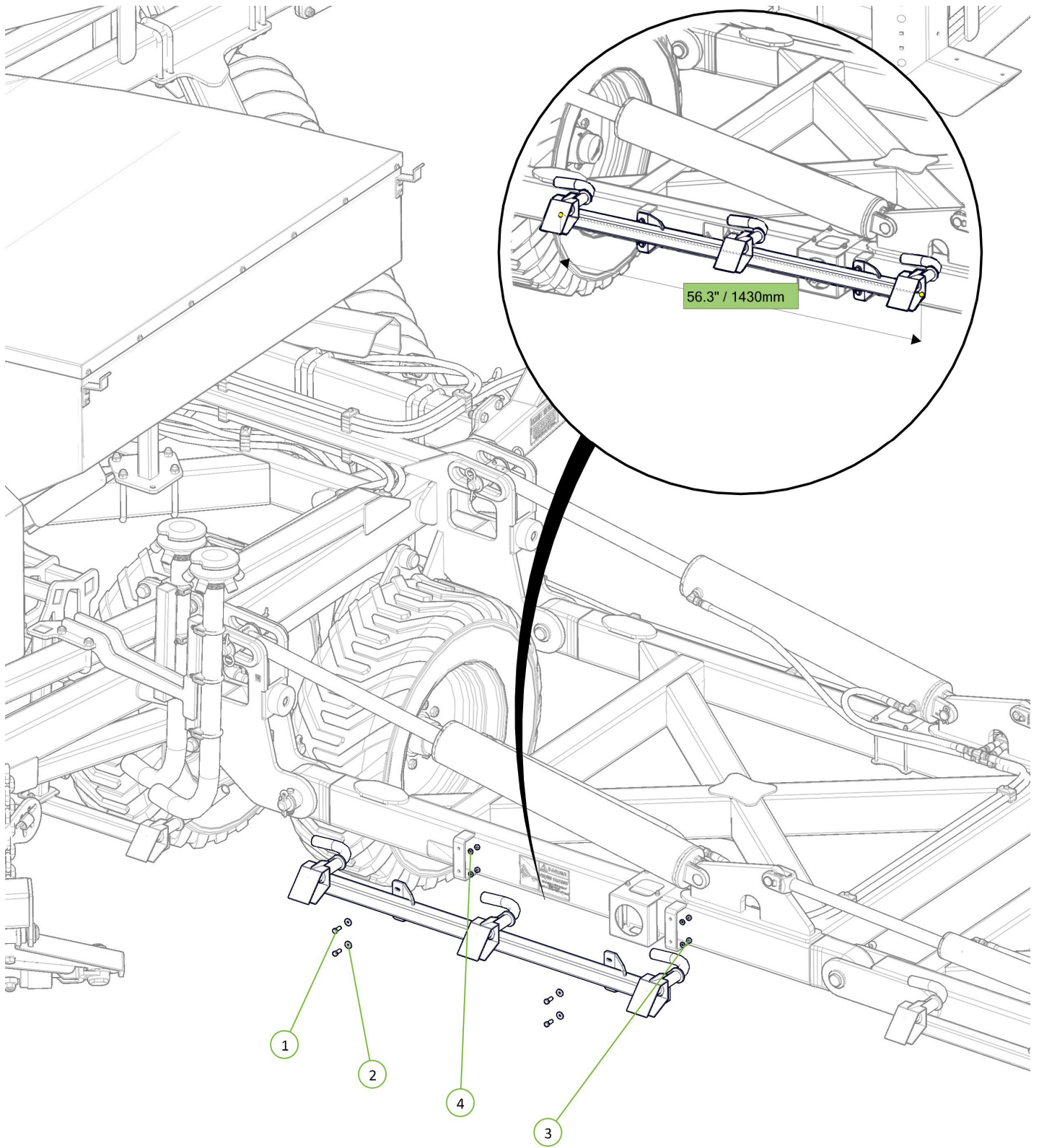

Item No.	Number	Description	Qty
1	0212-5-161	5/16 x 1" G8 ZP Bolt	4
2	0232-F5-16	Washer Flat 5/16"	4
3	0222-5-16	5/16" ZP Hex Nut	4
4	0232-S516	Washer Spring 5/16"	4

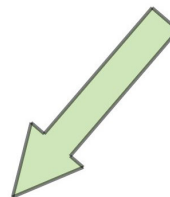



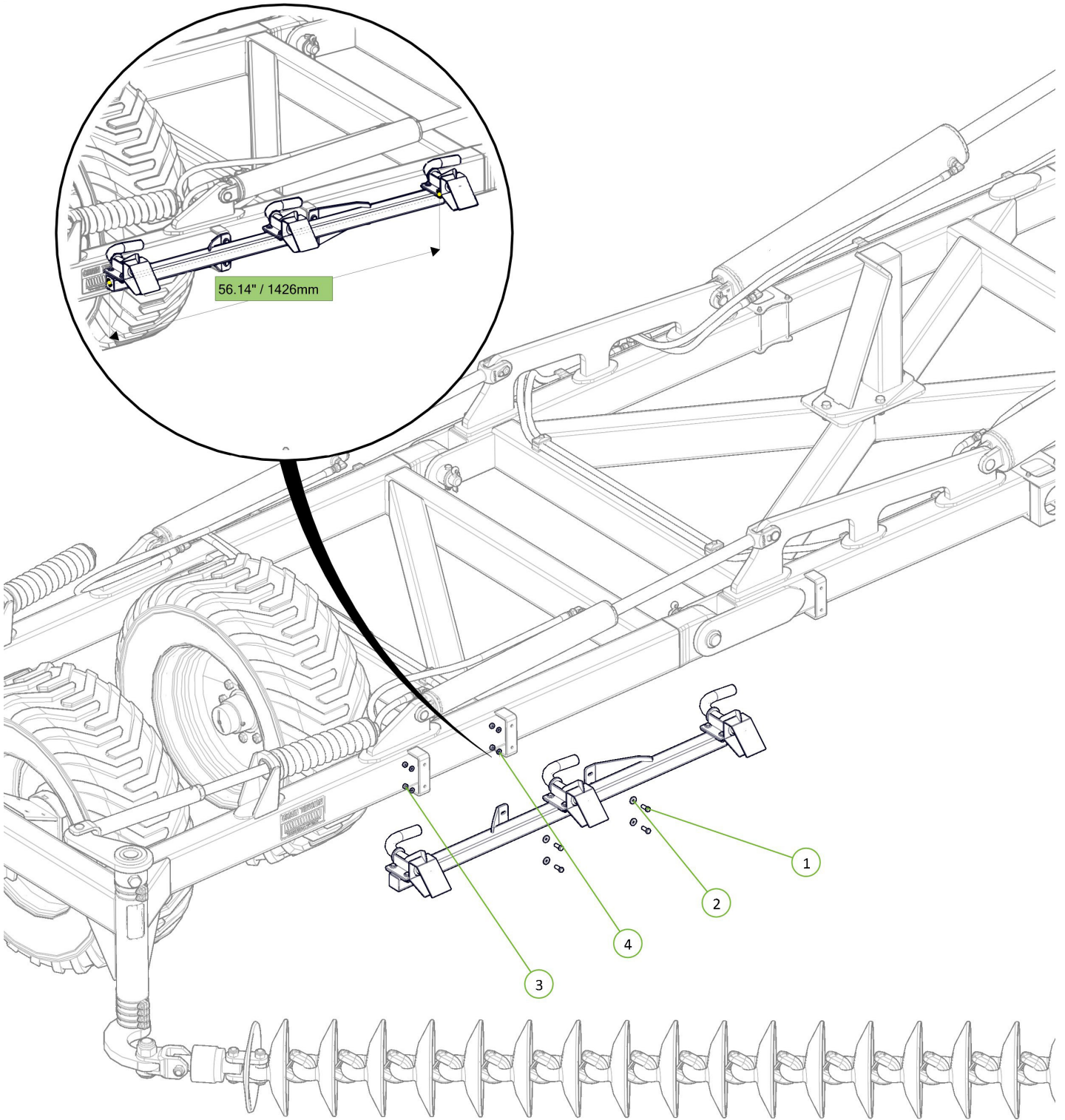

Item No.	Number	Description	Qty
1	0212-5-161	5/16 x 1" G8 ZP Bolt	4
2	0232-F5-16	Washer Flat 5/16"	4
3	0222-5-16	5/16" ZP Hex Nut	4
4	0232-S516	Washer Spring 5/16"	4

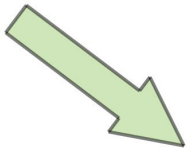

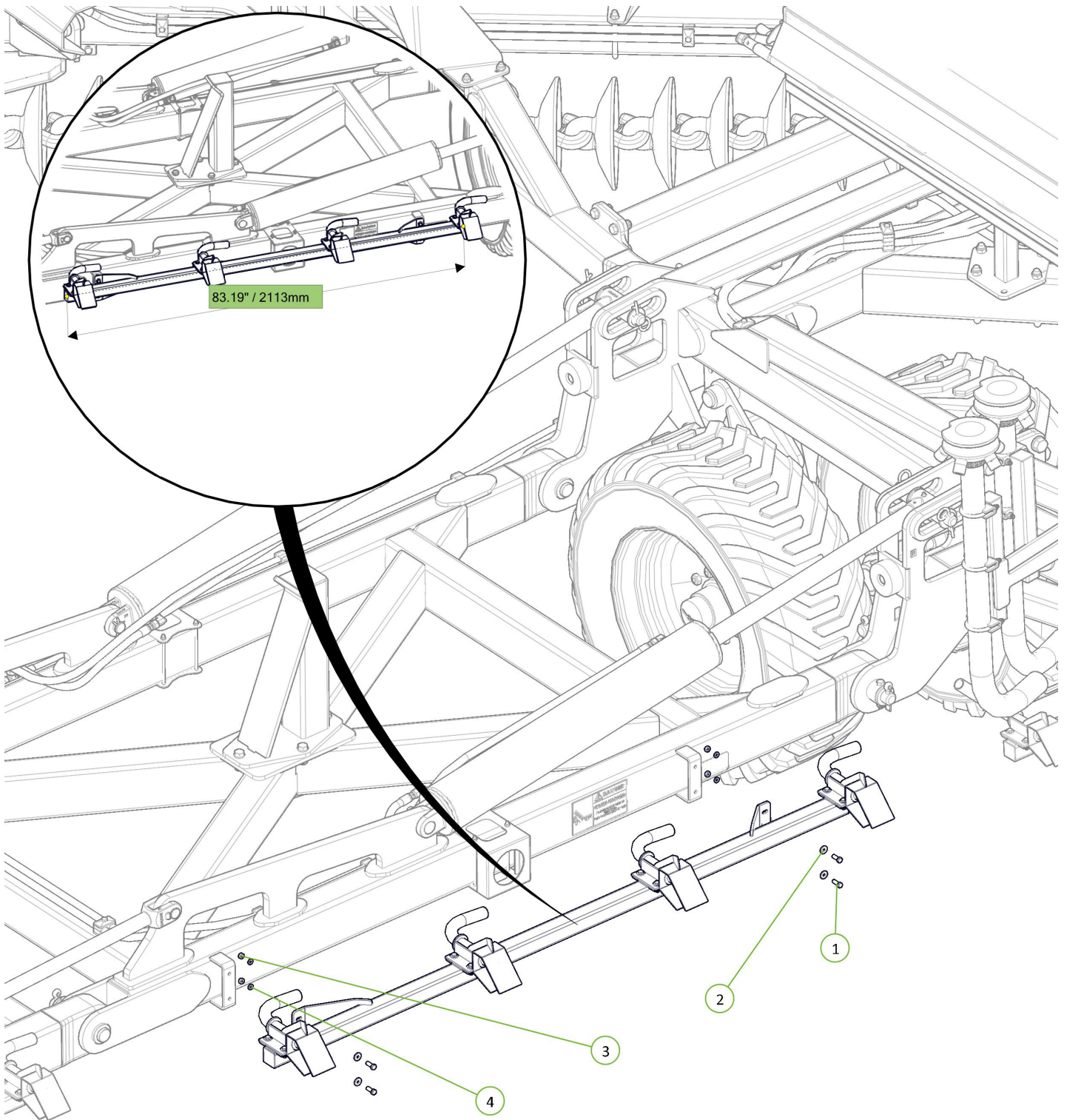

Item No.	Number	Description	Qty
1	0212-5-161	5/16 x 1" G8 ZP Bolt	4
2	0232-F5-16	Washer Flat 5/16"	4
3	0222-5-16	5/16" ZP Hex Nut	4
4	0232-S516	Washer Spring 5/16"	4

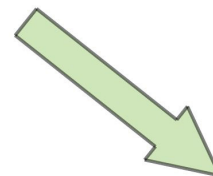



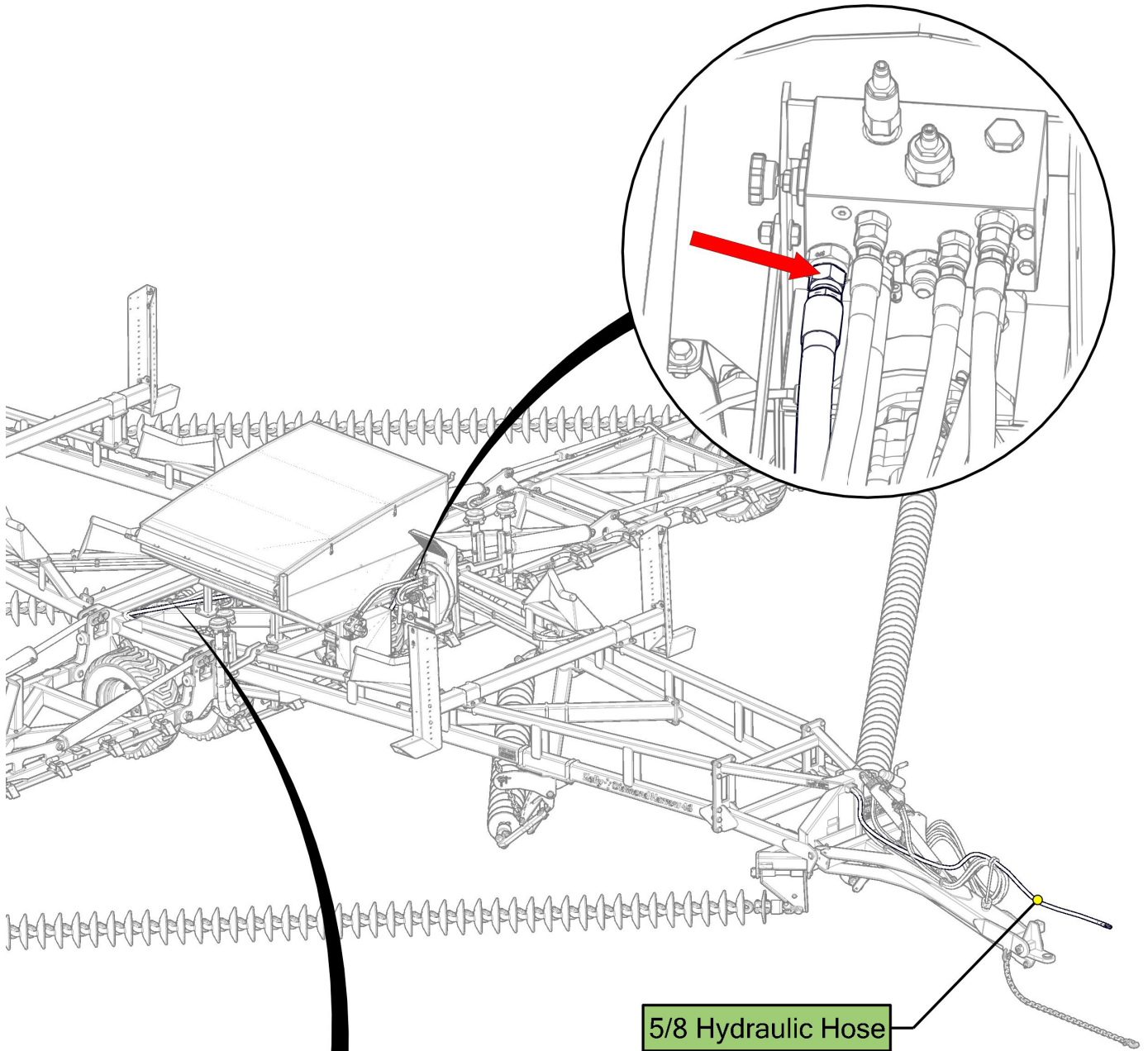

5/8 Hydraulic Hose

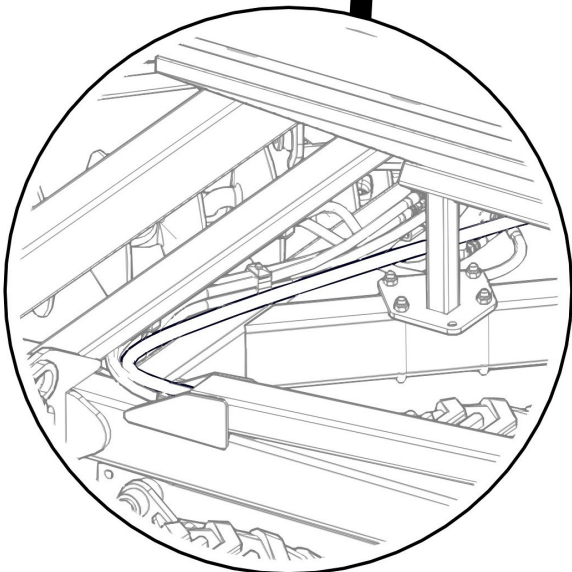

It may be necessary to relocate the existing hydraulic hoses to the left-hand side of the machine in order to run the seeder hydraulic hoses and cabling down the right-hand side of the machine.

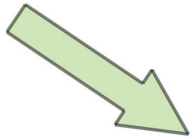

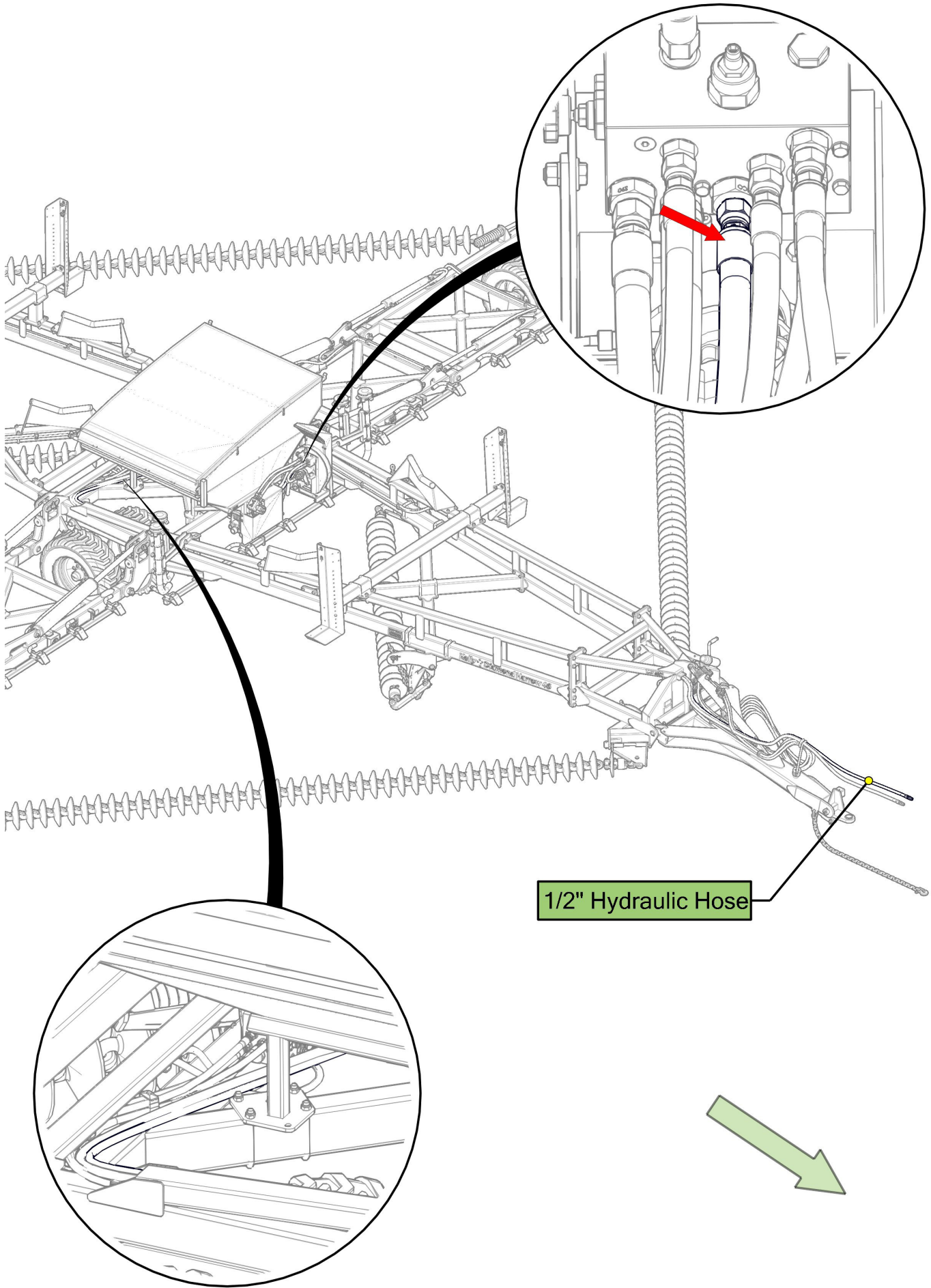

1/2" Hydraulic Hose



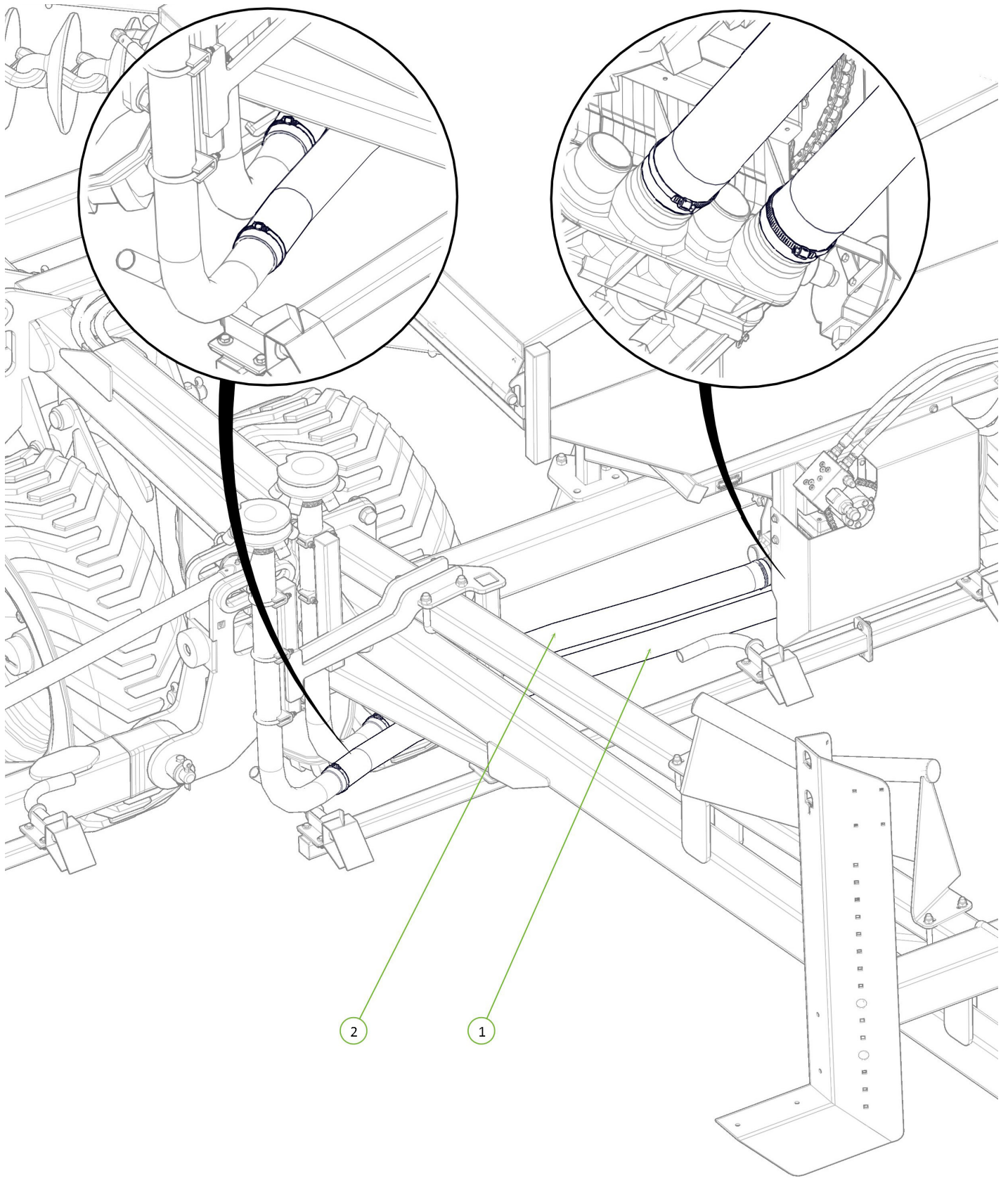

Item No.	Number	Description	Qty	Length
1	1701-266OA-63	2-1-2" Air Seeder Hose	1	60.6' / 1540mm
2	1701-266OA-63	2-1-2" Air Seeder Hose	1	51.18" / 1300mm

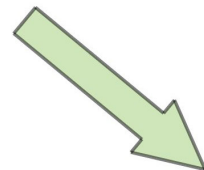

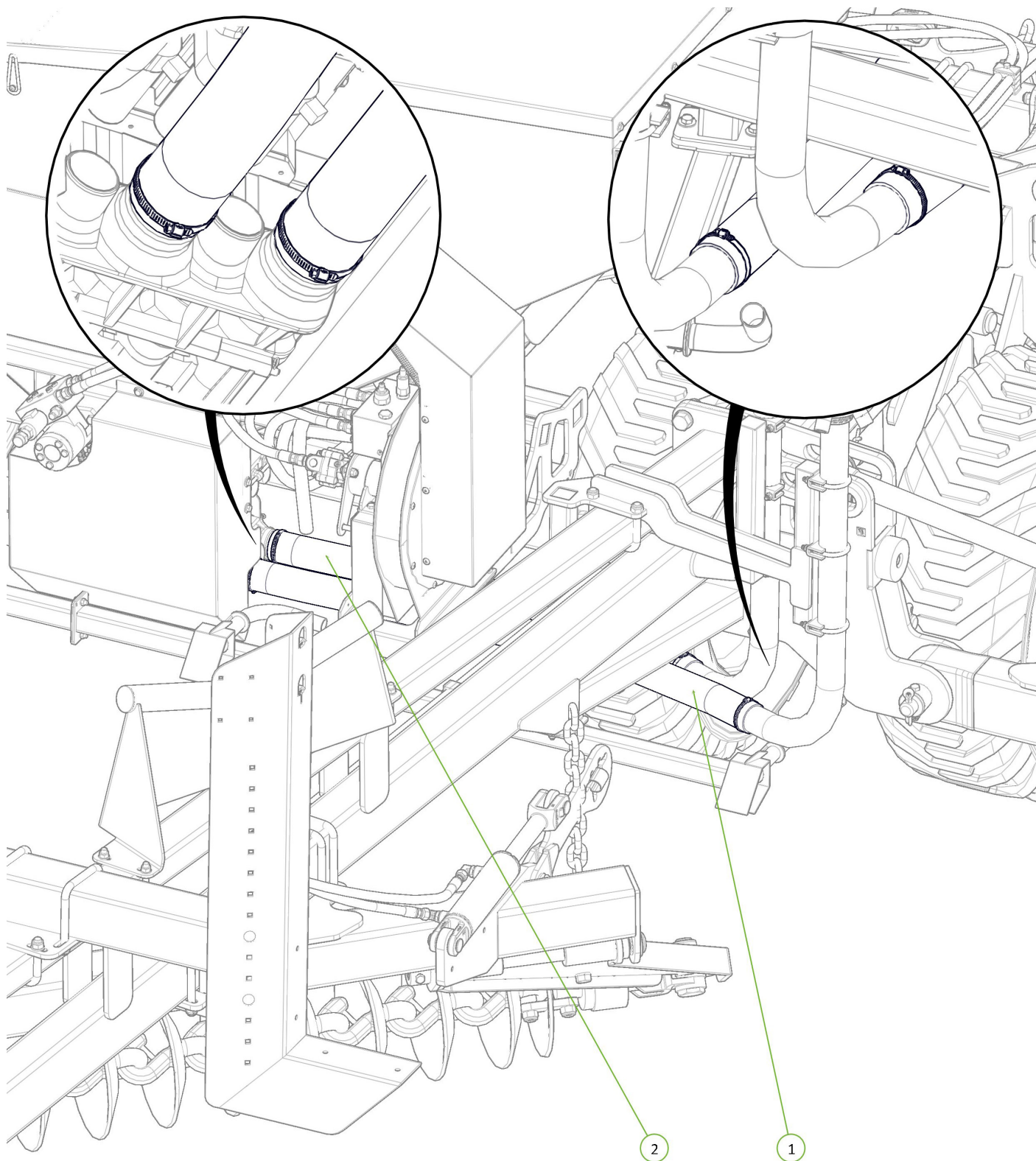

Item No.	Number	Description	Qty	Length
1	1701-266OA-63	2-1-2" Air Seeder Hose	1	55.5" / 1410mm
2	1701-266OA-63	2-1-2" Air Seeder Hose	1	46" / 1170mm

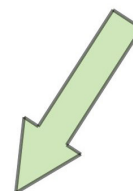



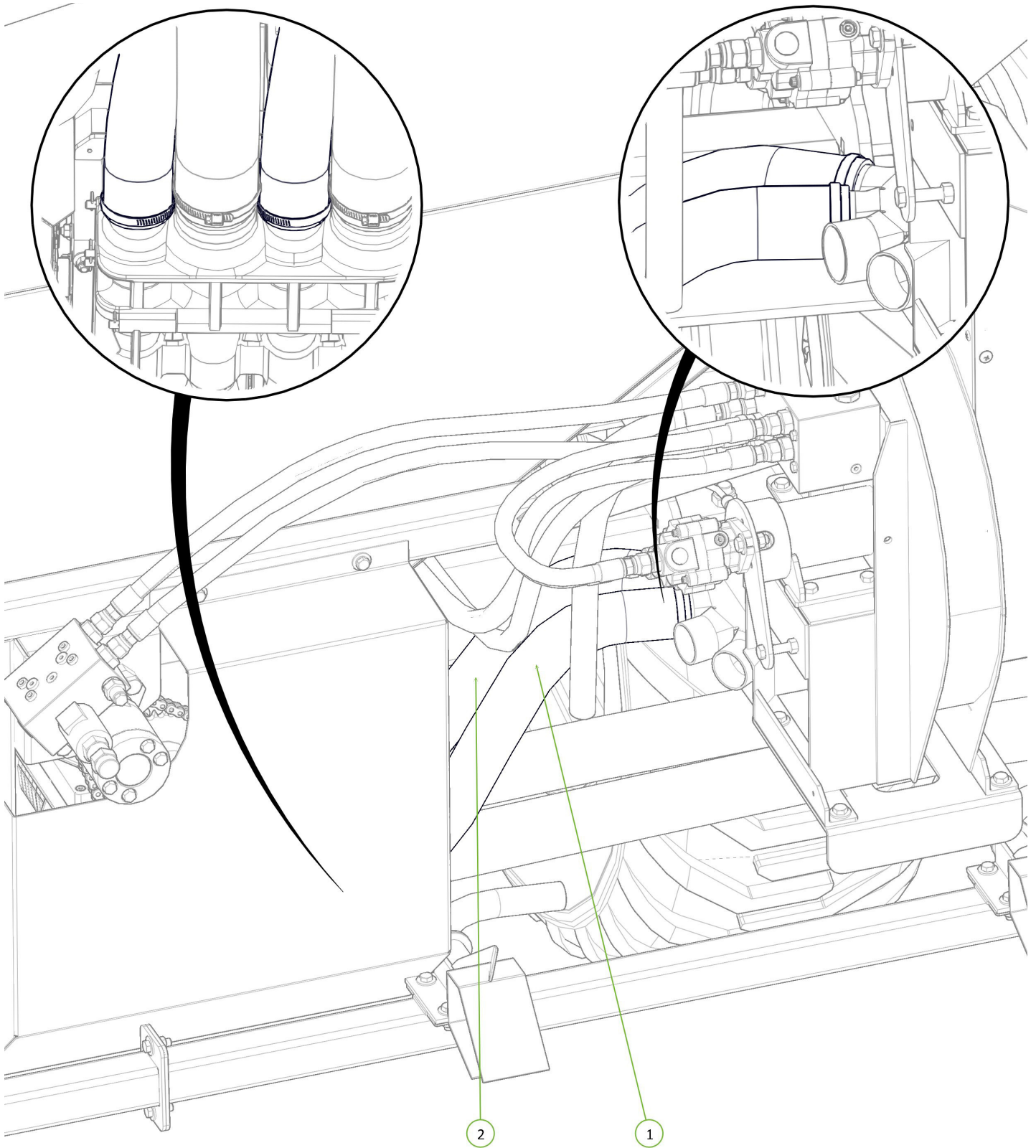

Item No.	Number	Description	Qty	Length
1	1701-163AL-51	2" Air Seeder Hose	1	22.6" / 574mm
2	1701-163AL-51	2" Air Seeder Hose	1	23.62" / 600mm



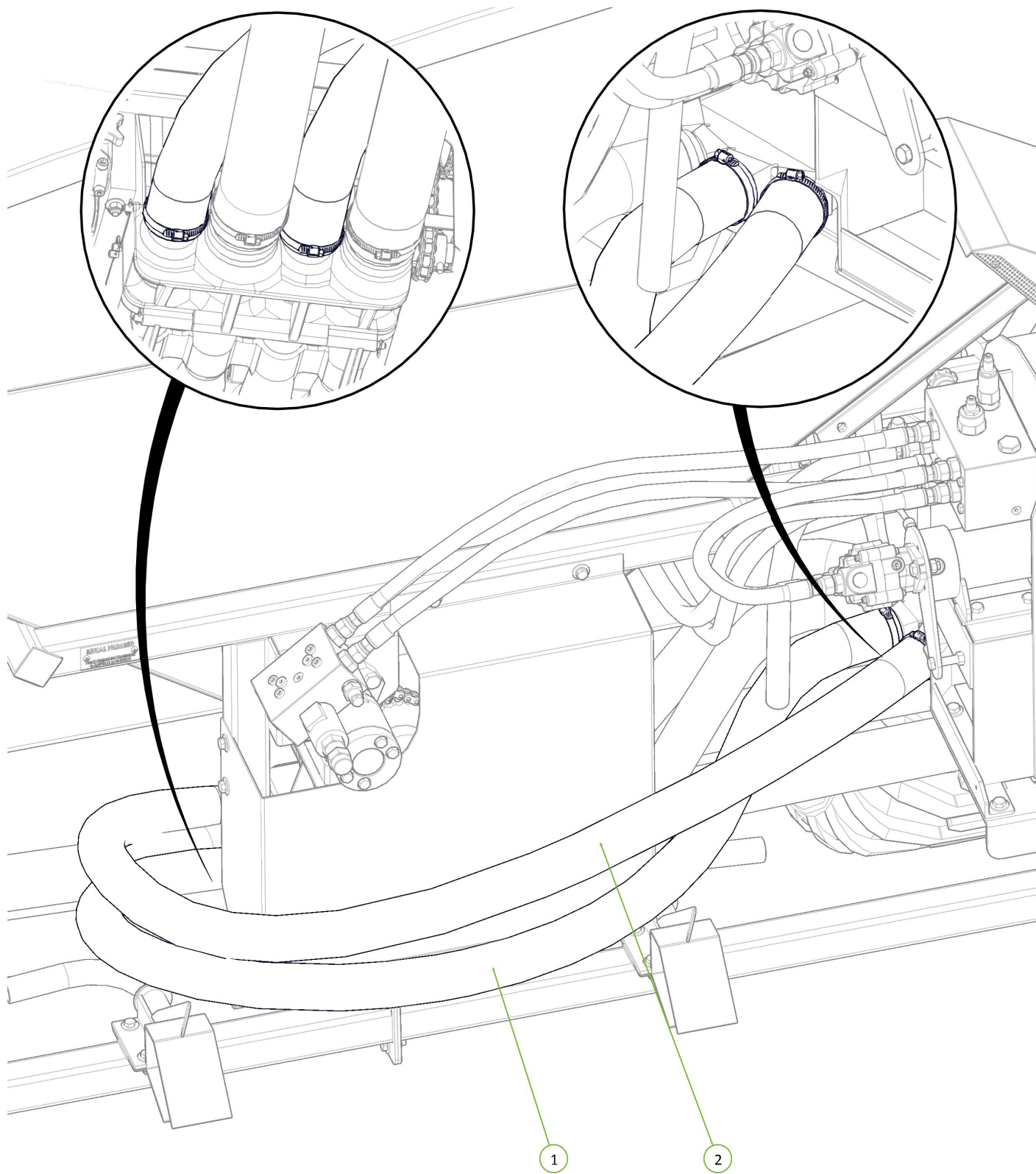

Item No.	Number	Description	Qty	Length
1	1701-163AL-51	2" Air Seeder Hose	1	67.72" / 1720mm
2	1701-163AL-51	2" Air Seeder Hose	1	68.11" / 1729mm

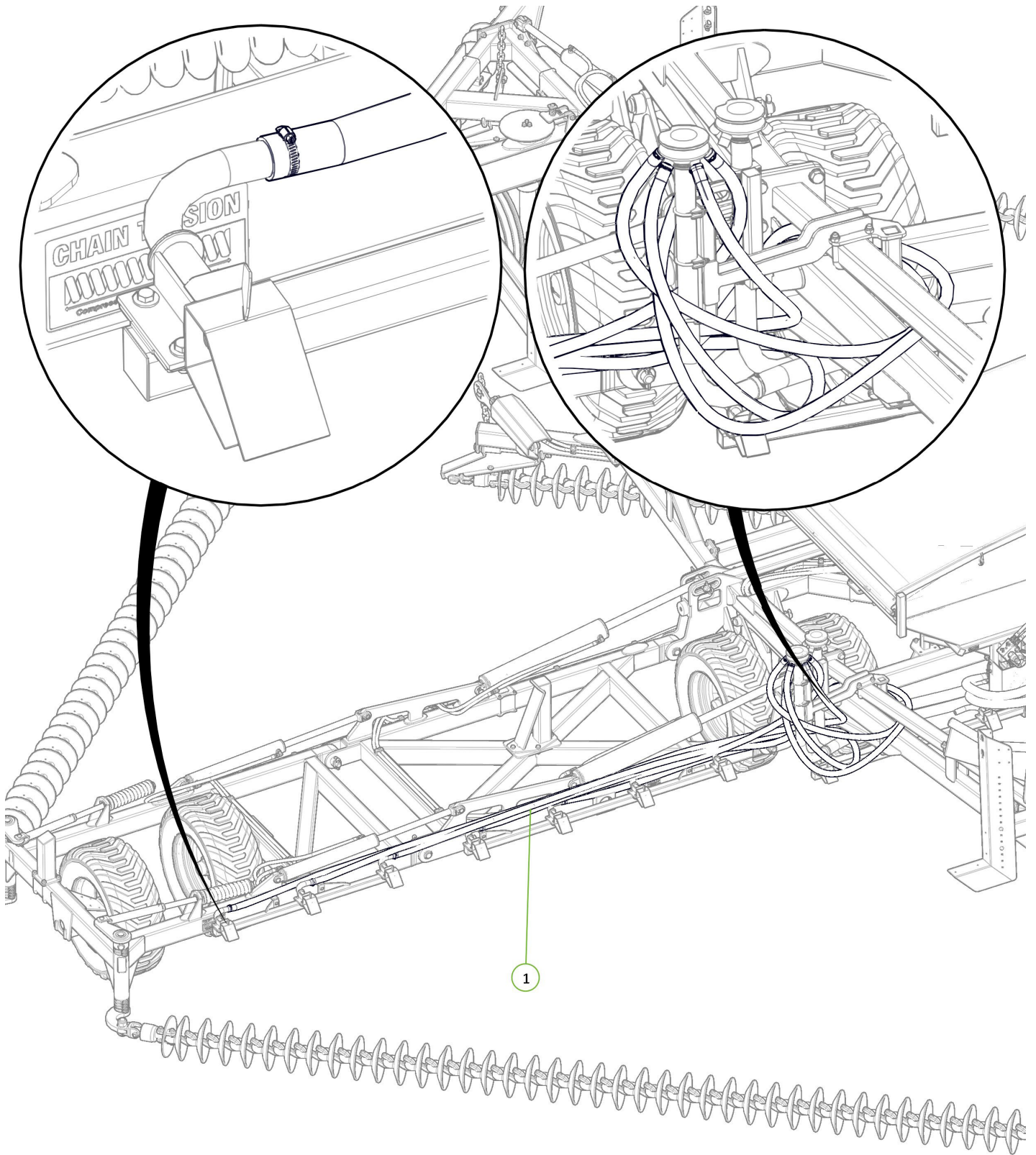

Seed hoses to each head should be the same length to ensure even seed flow

Item No.	Number	Description	Qty	Length
1	1701-2660A-32	1-1/4" Air Seeder Hose	5	17' 7.92" / 5400mm

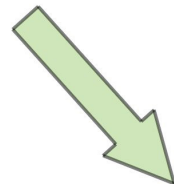



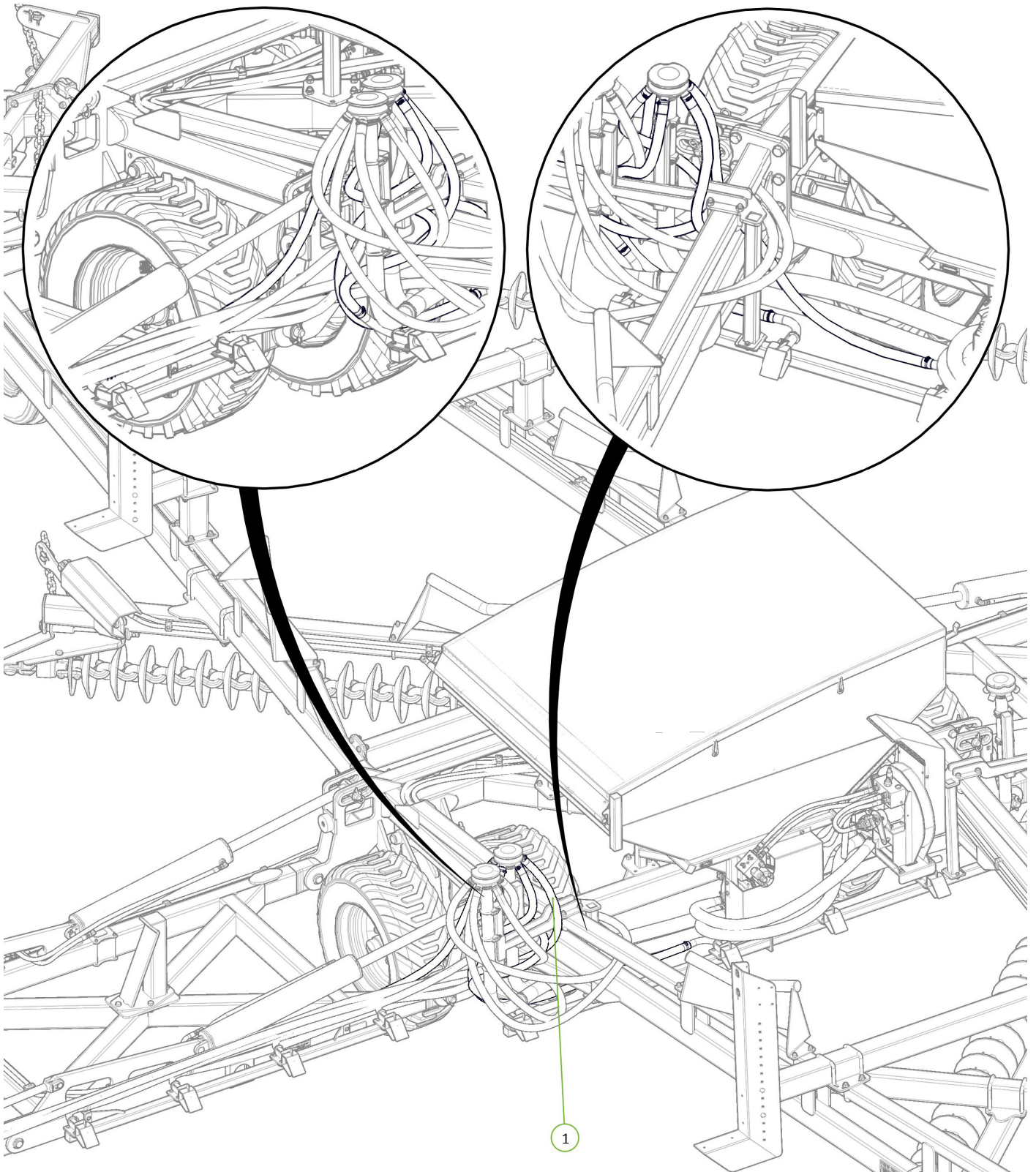

Seed hoses to each head should be the same length to ensure even seed flow

Item No.	Number	Description	Qty	Length
1	1701-2660A-32	1 1-4" Air Seeder Hose	5	5.83' / 1800mm

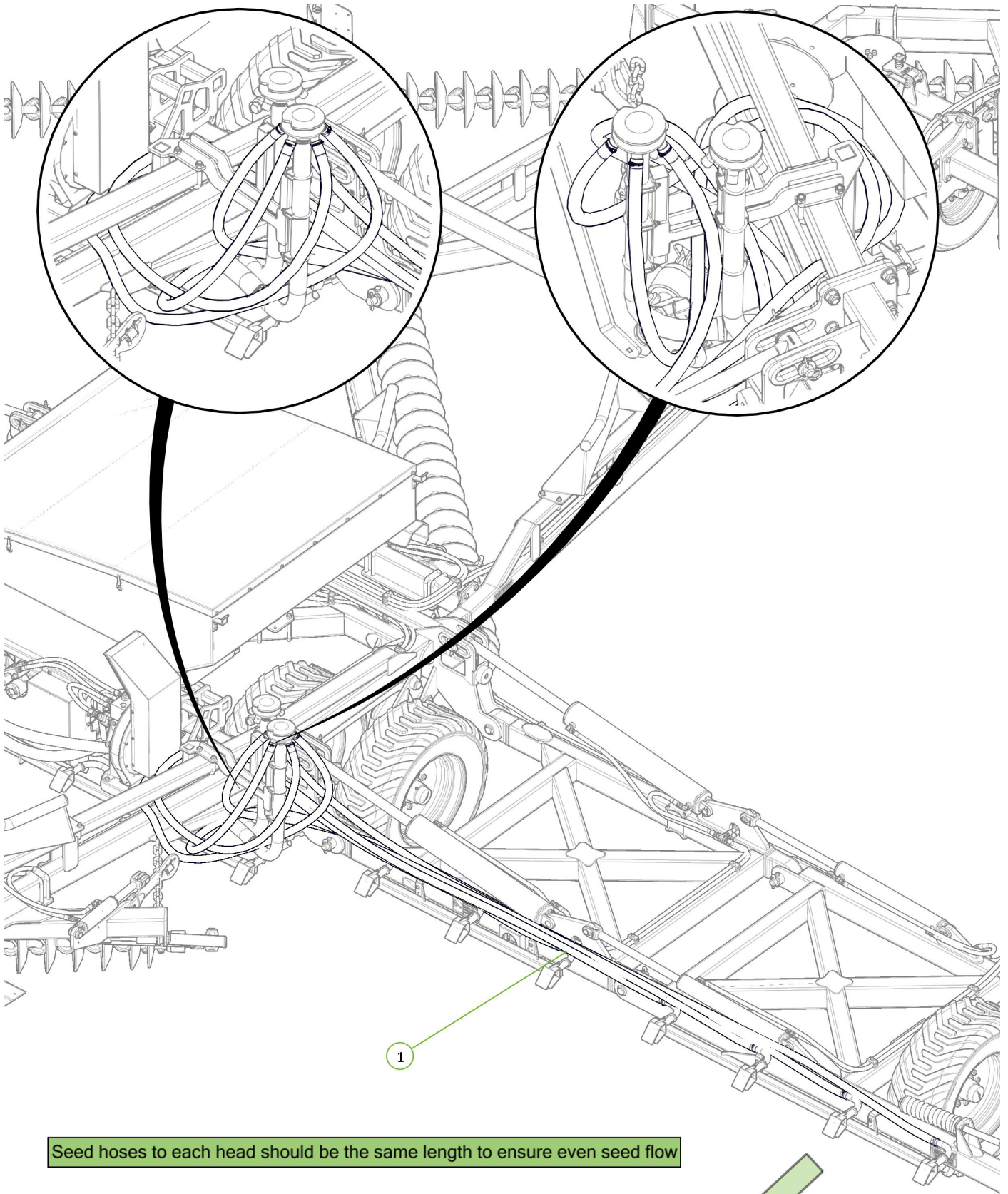

Seed hoses to each head should be the same length to ensure even seed flow

Item No.	Number	Description	Qty	Length
1	1701-2660A-32	1 1-4" Air Seeder Hose	5	17' 7.92" / 5400mm

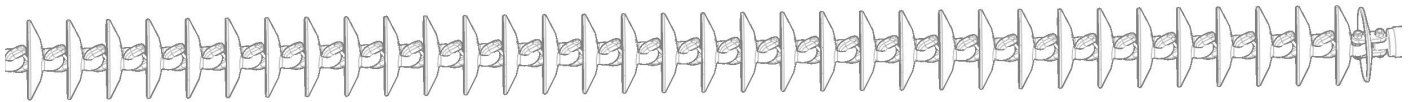
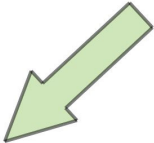



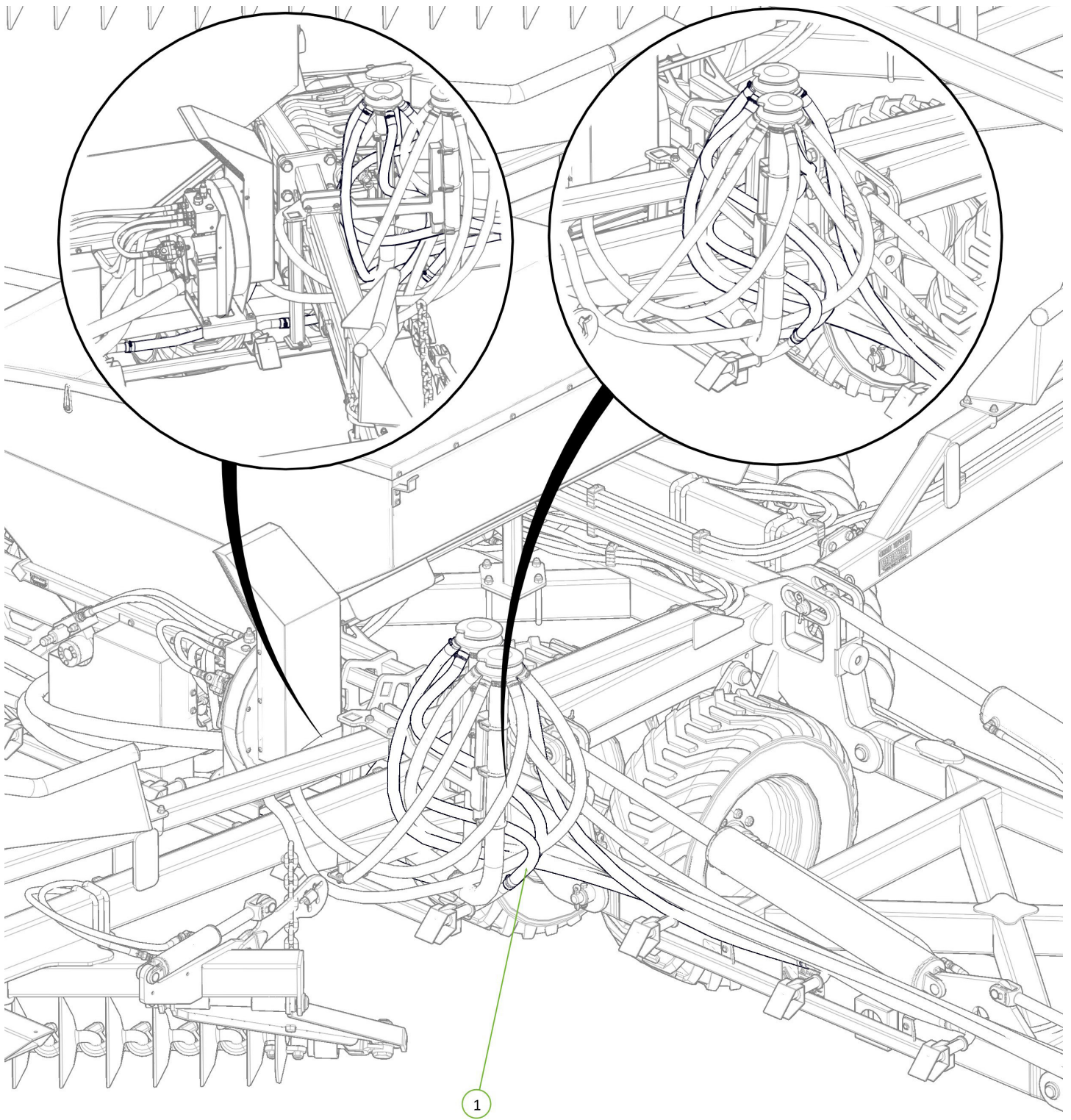

Seed hoses to each head should be the same length to ensure even seed flow

Item No.	Number	Description	Qty	Length
1	1701-2660A-32	1 1-4" Air Seeder Hose	5	5.83' / 1800mm

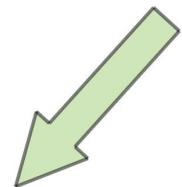

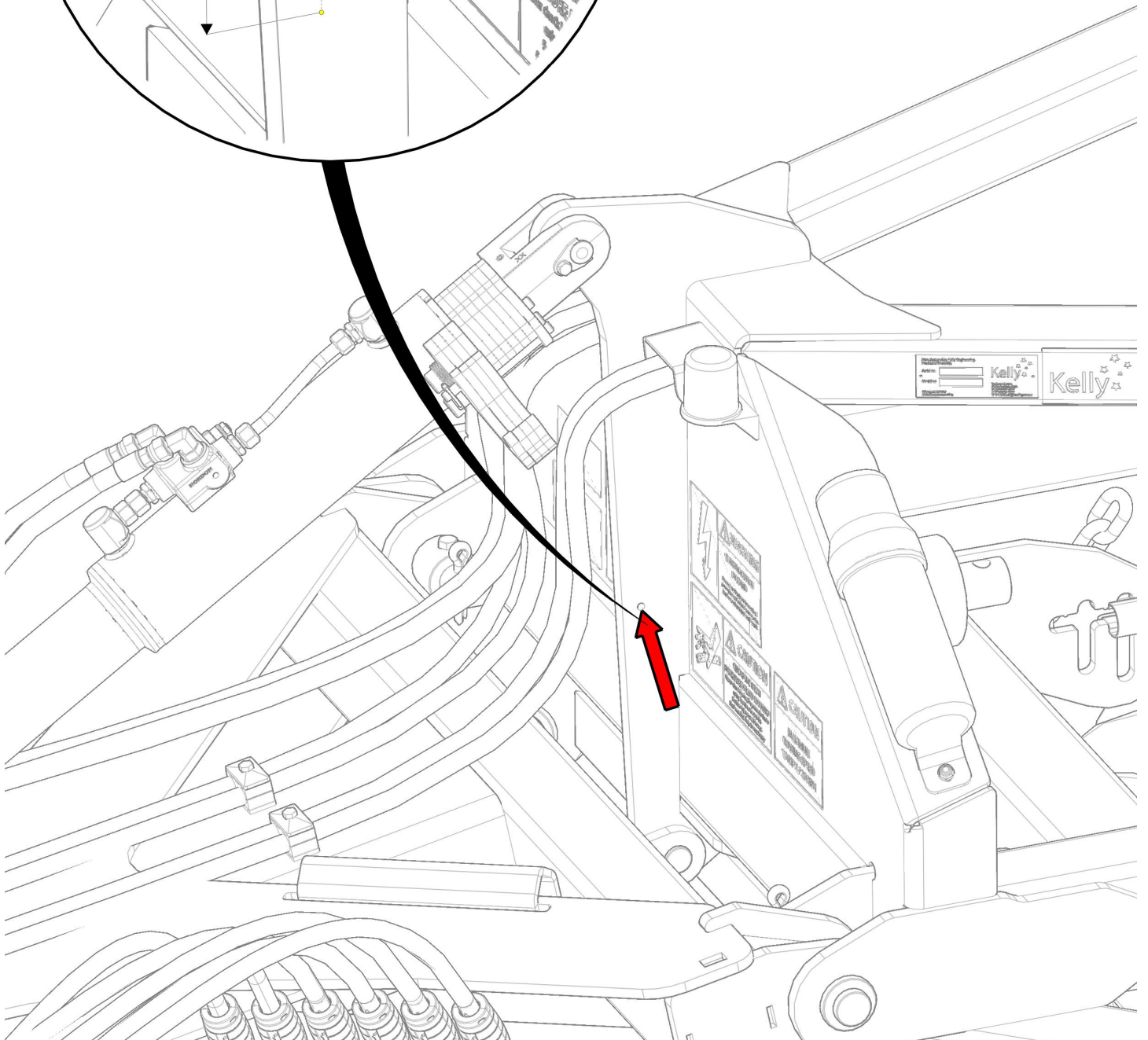
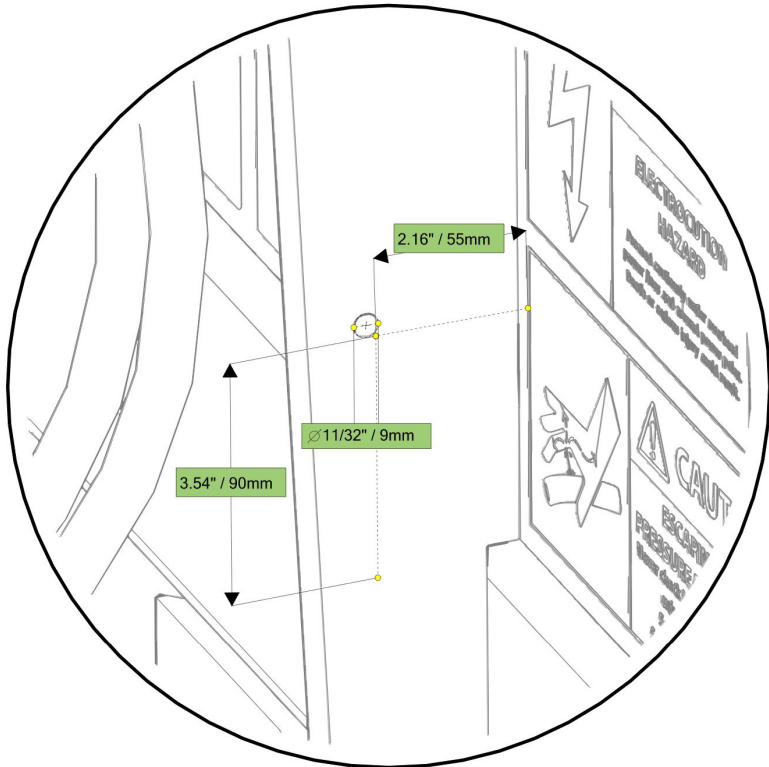



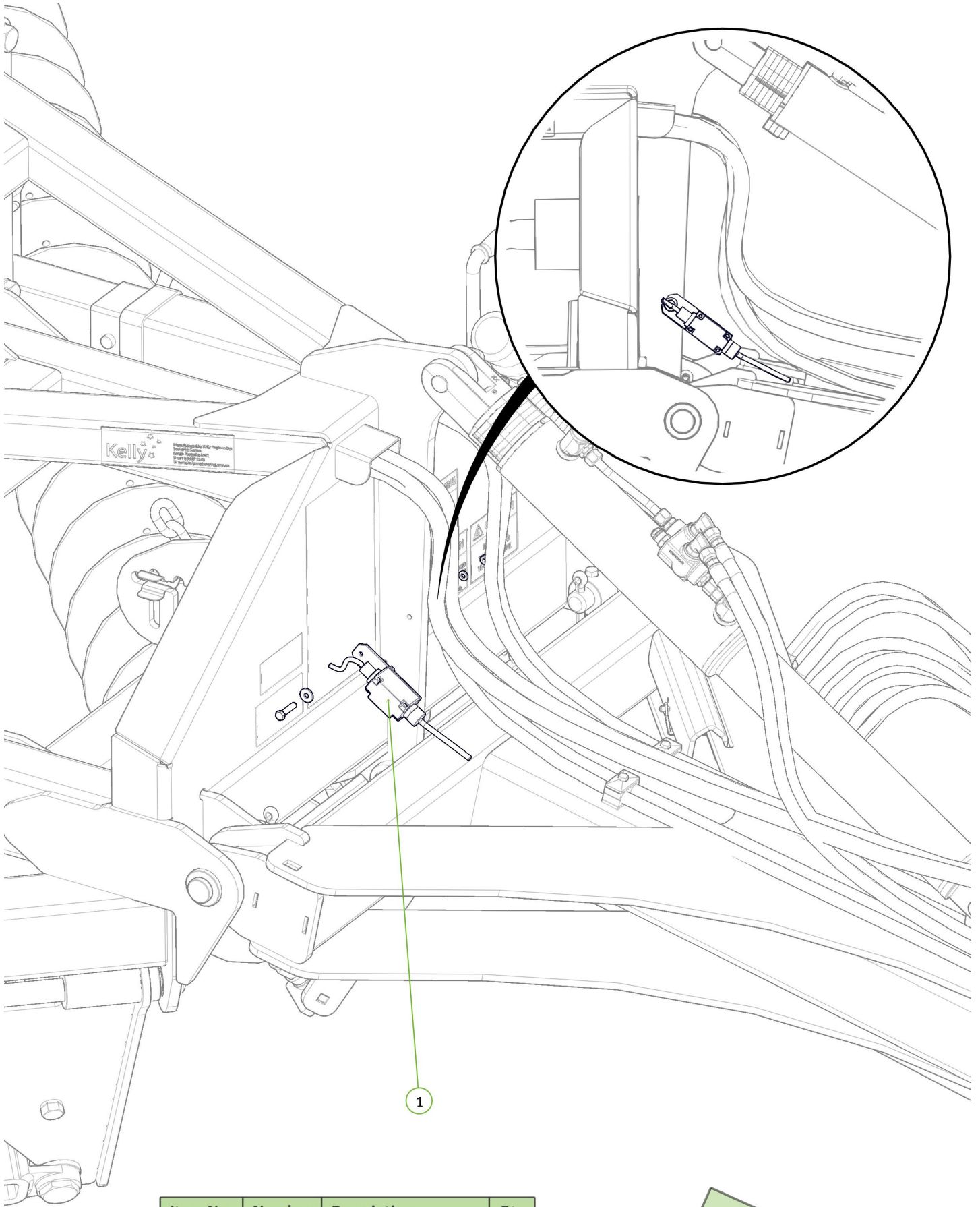

Item No.	Number	Description	Qty
1	1710-27	Lift Switch Mounting	1

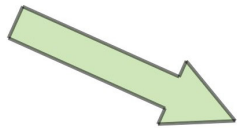



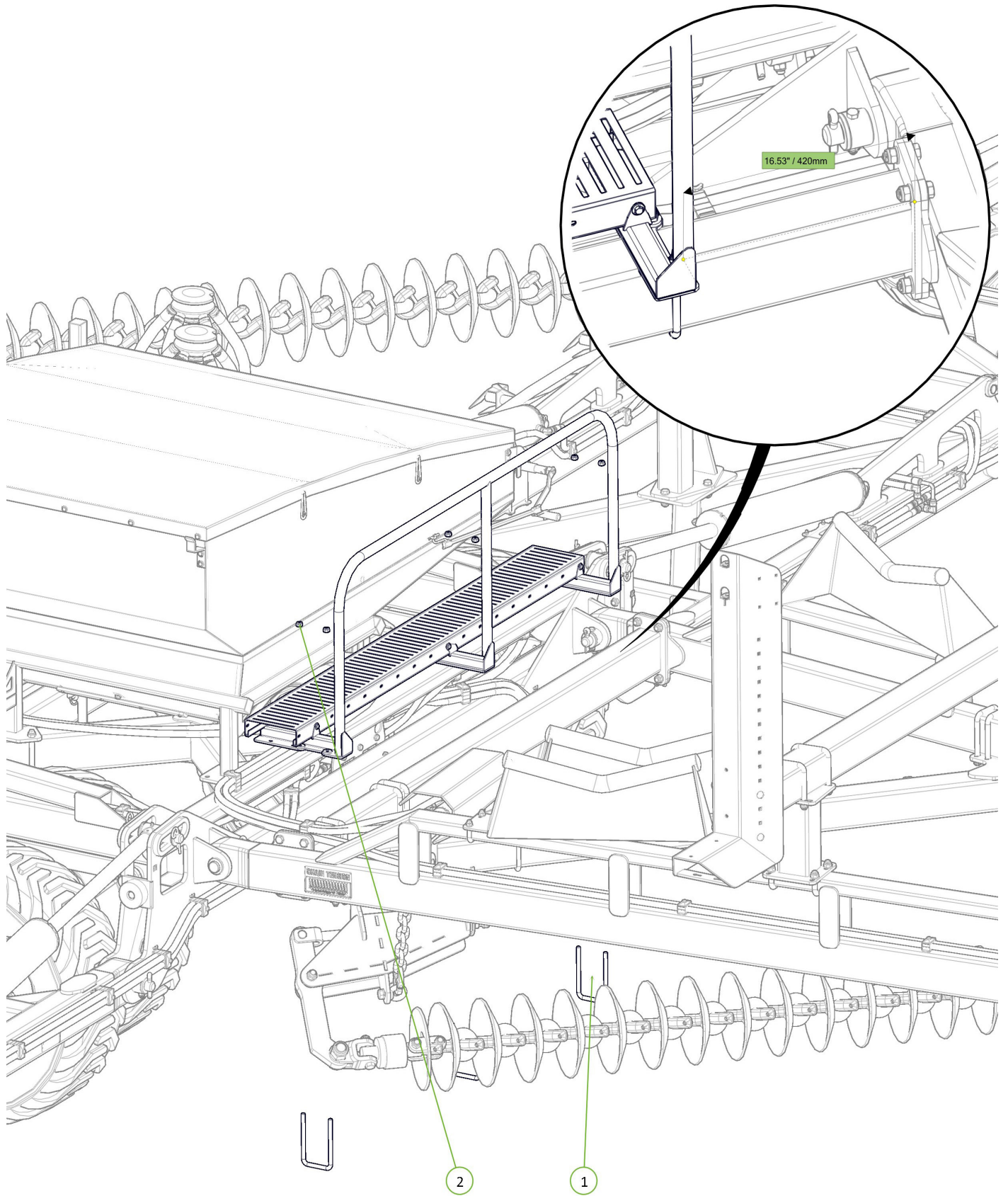

Item No.	Number	Description	Qty
1	0271-12185104	U-Bolt M12 x 188 Deep x 106 Wide	3
2	0221-NYL12	Nyloc Nut M12	6

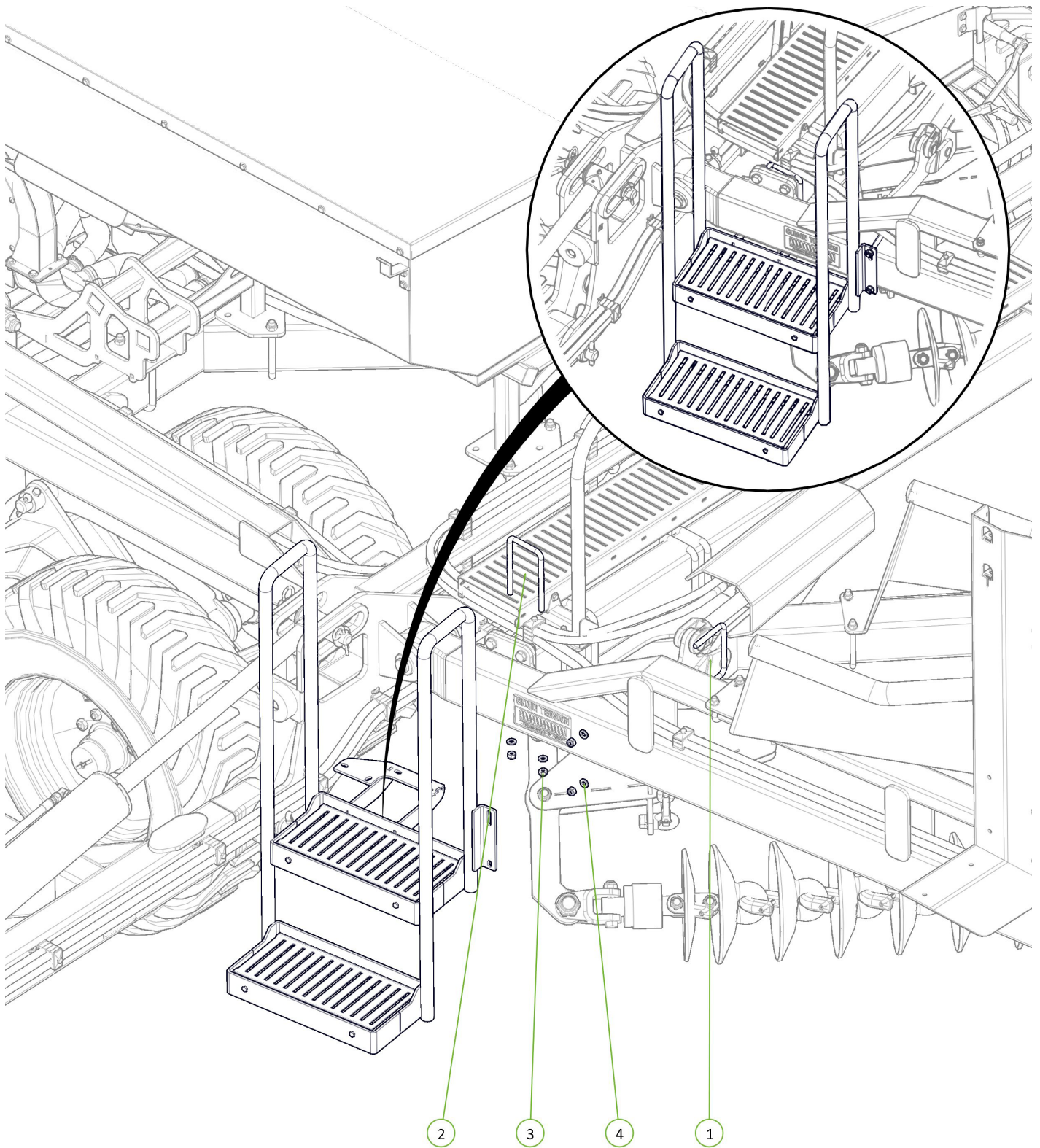

Item No.	Number	Description	Qty
1	0271-12125152	U-Bolt M12 x 125 Deep x 152 Wide	1
2	0271-12185104	U-Bolt M12 x 185 Deep x 104 Wide	1
3	0221-NYL12	Nyloc Nut M12	4
4	0231-F12	Washer Flat M12	4

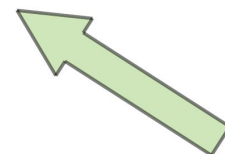



Item No.	Number	Description	Qty
1	0271-12188106U	U-Bolt M12 x 188 Deep x 106 Wide	2
2	0221-NYL12	Nyloc Nut M12	4
3	0231-F12	Washer Flat M12	4

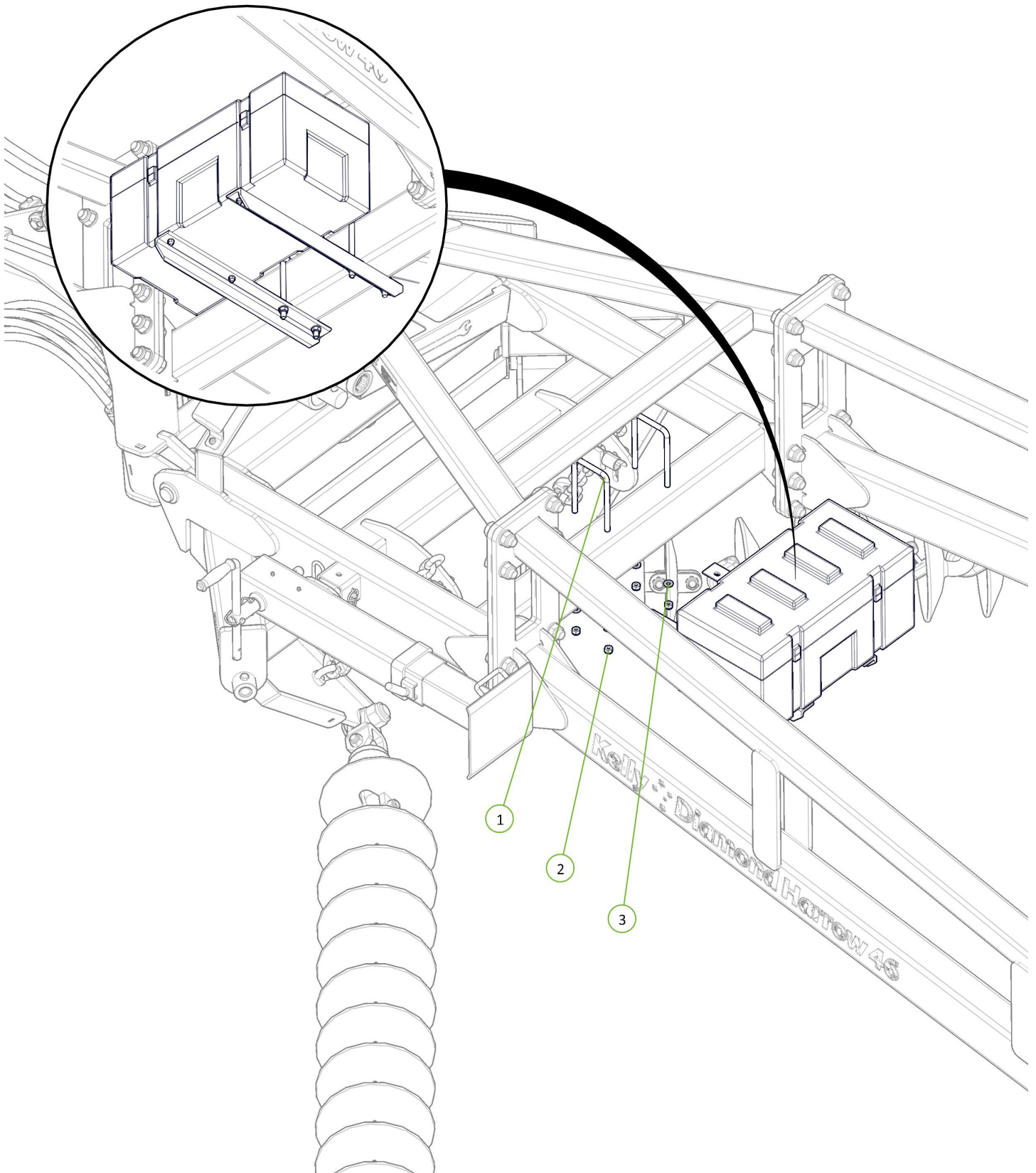
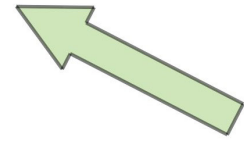

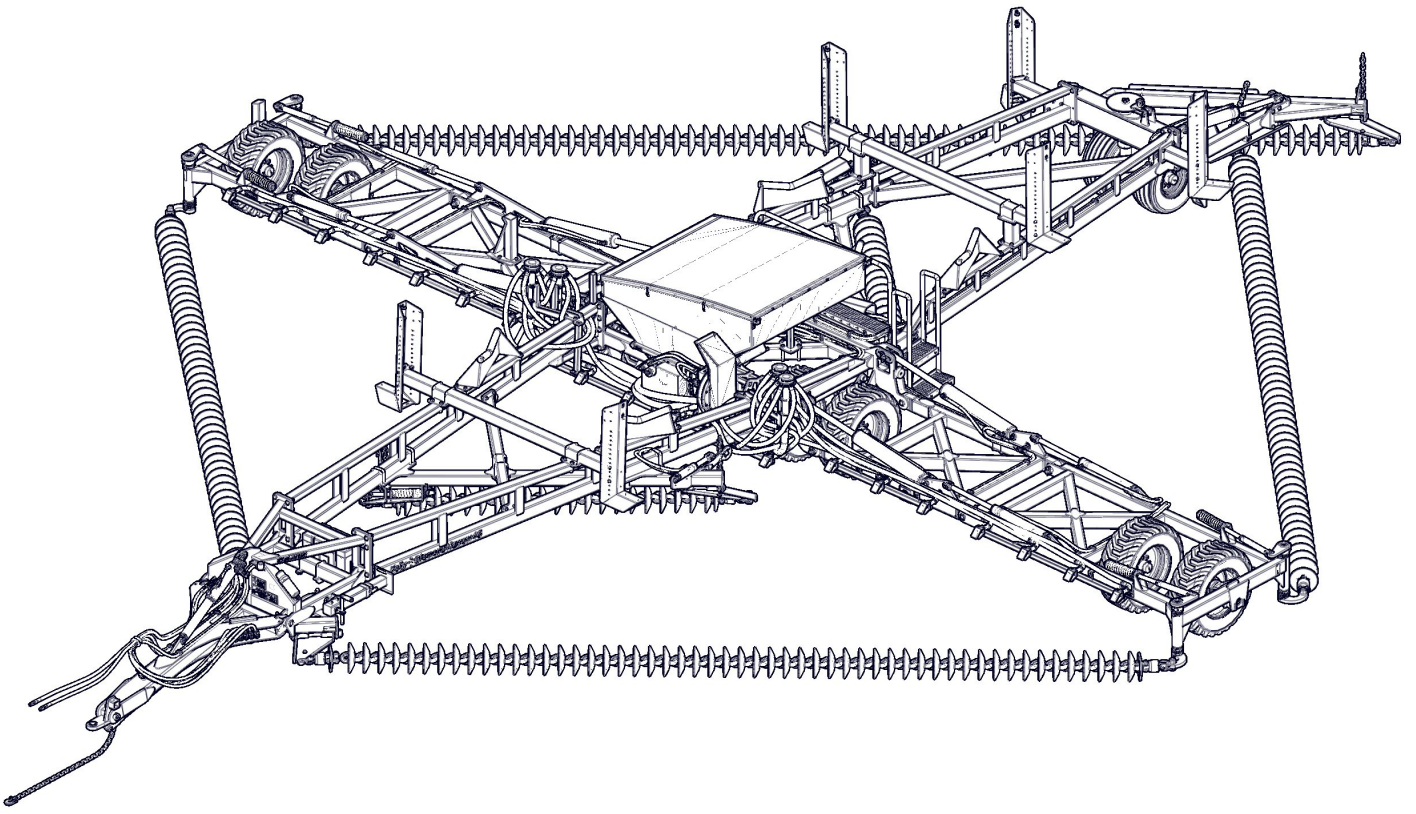

# Section 2

## Diagrams & Specifications

# Wiring Diagram

