



Technical Bulletin 084 Section A

46 Center Frame Brace Installation

Priority:

High Priority Installation

Overview:

Kelly is always seeking to improve its machines and designs in collaboration with our customers.

Commencing July 2021 all new Model 4614 machines will be shipped with a strengthened structural design of the Center Frame.

Existing Machine Solution:

Technical Bulletin 084 is being prescribed to all existing Model 46 machines.

To avoid possible damage to the Model 46 Center Frame or failure of the Model 46 Center Frame we strongly recommend the installation of the supplied components as per the following instruction.

Technical Bulletin 084 Section A

46 Center Frame Brace Installation

Supplied:

The supplied upgrade kit will include the following components. Refer Fig.1

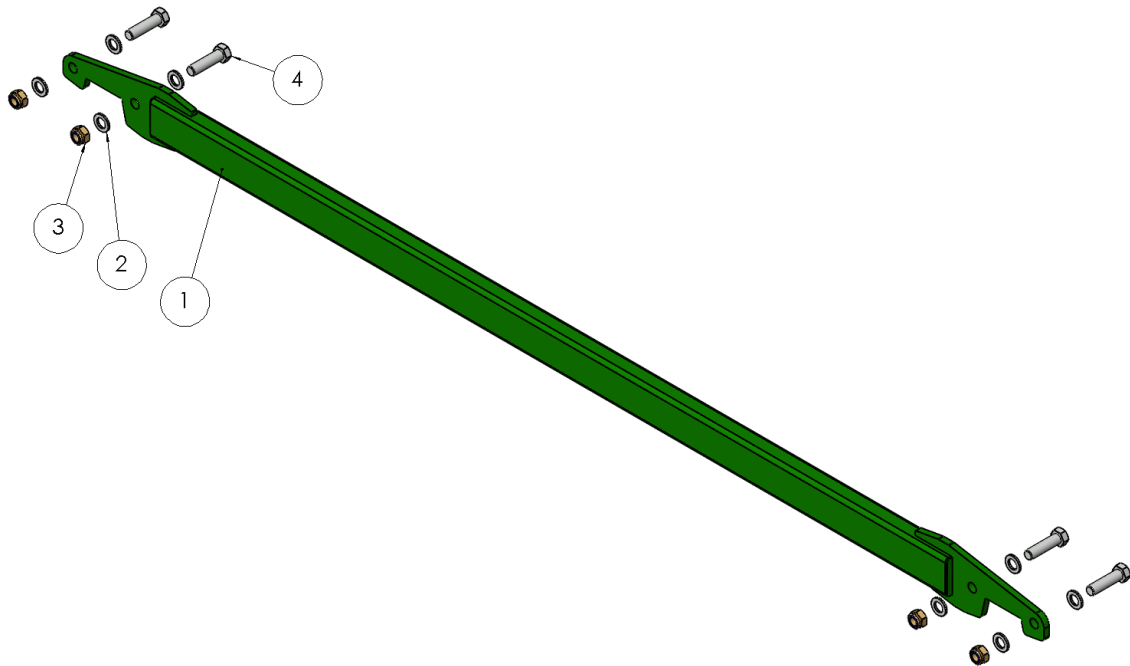

Figure 1 - 46 Center Frame Brace

ITEM NO.	PART NUMBER	REVISION	DESCRIPTION	QTY.
1	KE-1610-192	B-0	46 Center Frame Brace	1
2	0231-F24		Washer Flat M24	8
3	0221-NYL24		Nyloc Nut M24	4
4	0211-2490		M24 x 90 Class 8.8 ZP Bolt	4



Technical Bulletin 084 Section A

46 Center Frame Brace Installation

Installation:

1. Position your Kelly Diamond Harrow on firm and even ground. Ensure safe access to the center of machine.

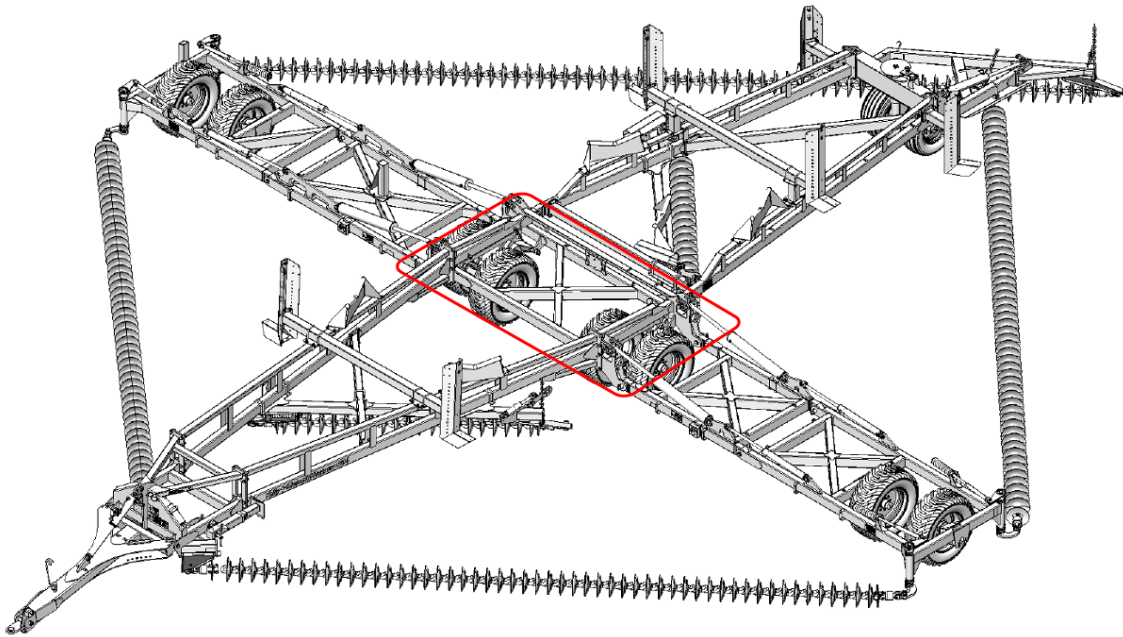

Figure 2 – Model 46 Unfolded

2. Unfold machine to working position.
3. Ensure main cylinders pins are centered in float slots.
4. Turn off tractor Ensure park lock is engaged.
5. Inspection:
 - 5.1. Prior to installing the 46 Center Frame Brace clean and inspect the Center Frame carefully this must include the underside of the Center Frame. Refer Figure 3.
 - 5.2. If any cracking is found, please contact Hood & Company as soon as possible. **Provide machine serial number and images of findings.** Weld on repair kit will be provided.

Hood & Company, Inc

Phone: 417-865-2100

Email: parts@hoodco.com

46 Center Frame Brace Installation

6. Proceed with installation of 46 Center Frame Brace. This is required whether or not cracks have developed.

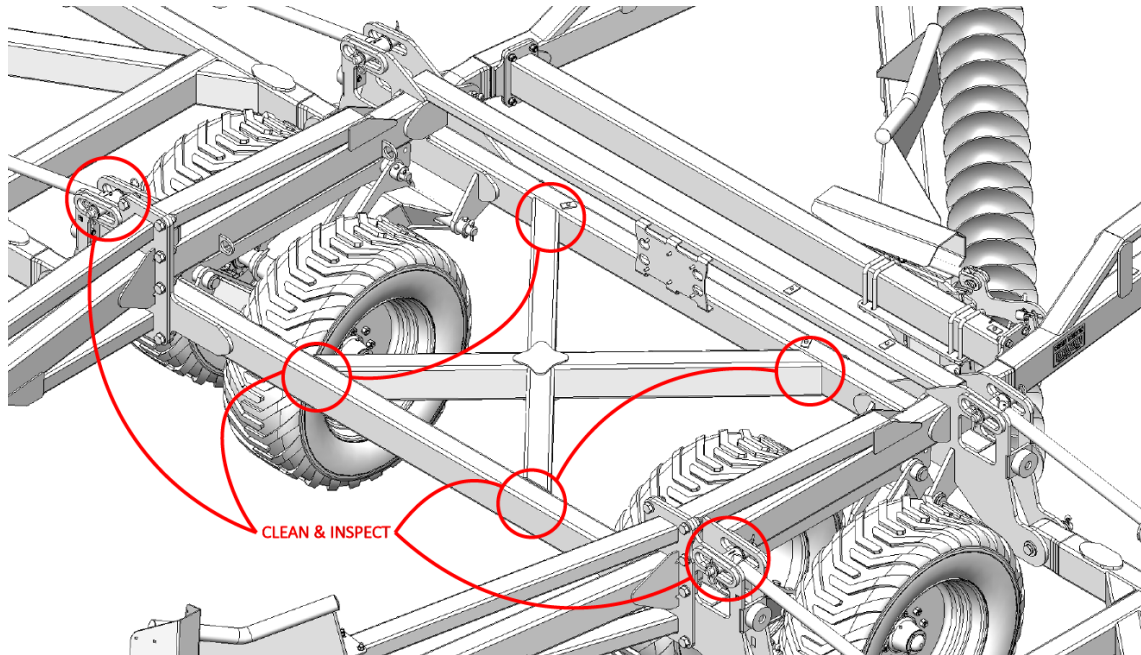

Figure 3 – Clean & Inspect: 46 Center Frame

7. Scan Figure 4 QR Code to watch 46 Center Frame Brace installation demonstration video:

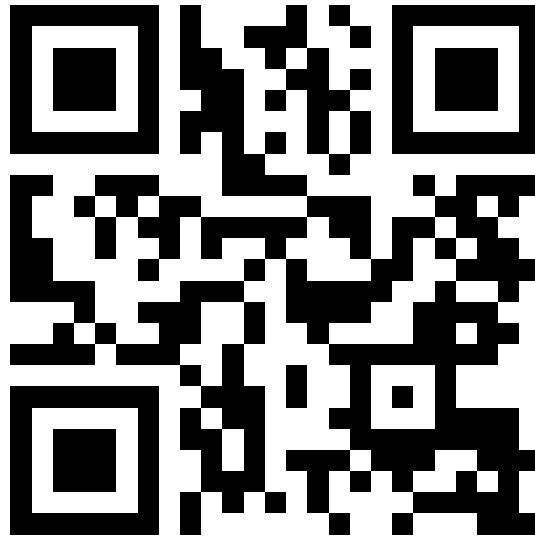

Figure 4 - 46 Center Frame Brace Installation Video Link

8. Locate, remove and discard the top two fasteners from the front left and front right positions of the Center Frame. Refer Figure 4.

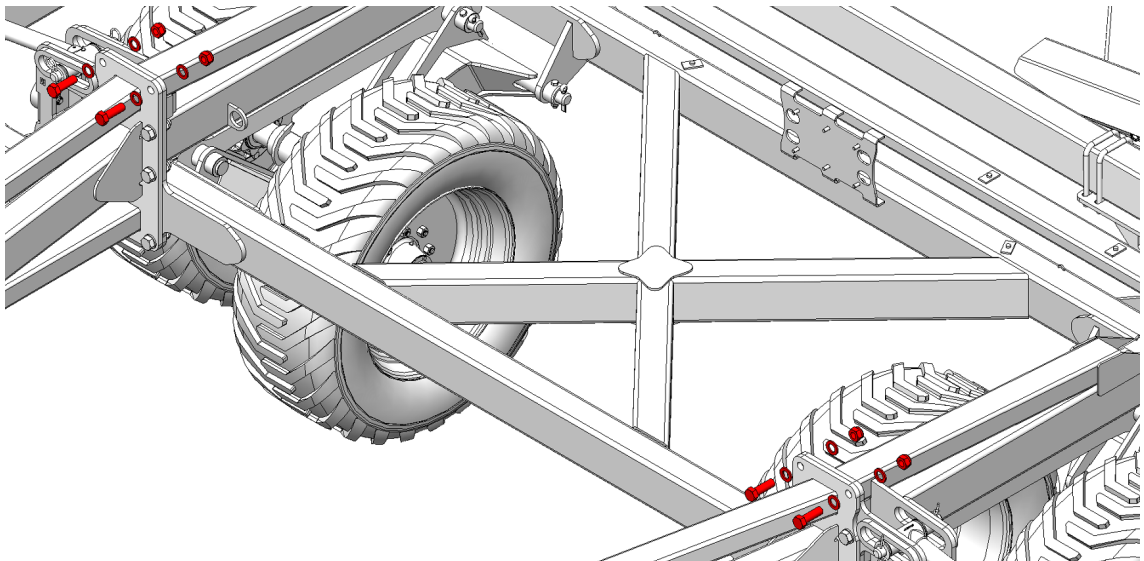

Figure 5 – Discard Fasteners

Technical Bulletin 084 Section A

46 Center Frame Brace Installation

9. Position 46 Center Frame Brace on Center Frame on the backside of the connection to the Front A-Frame. Confirm hole alignment prior to installing fasteners. It may be necessary to align bolt holes using pry bar or ratchet strap. Refer Figure 5.

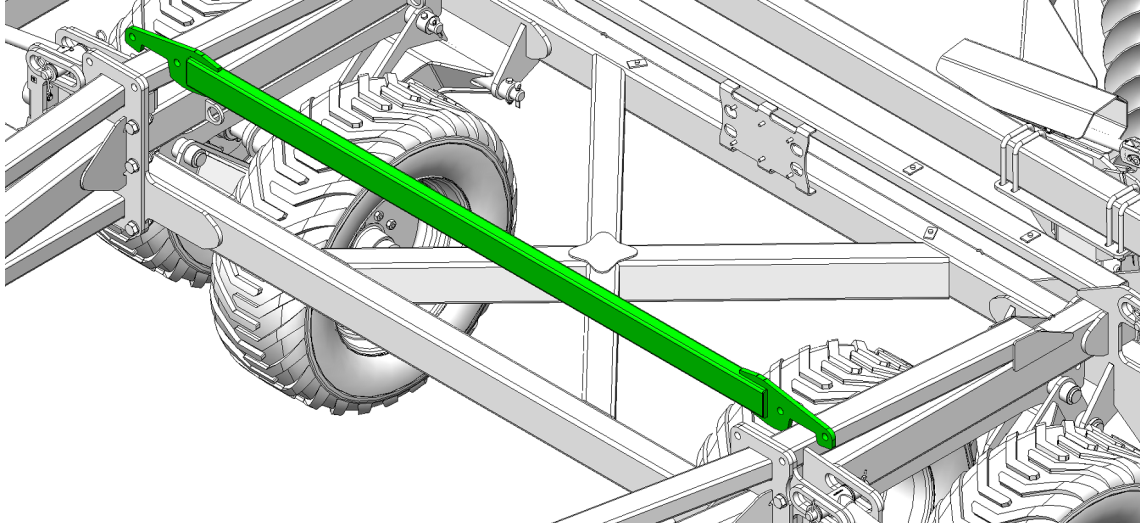

Figure 6 - Positioned: 46 Center Frame Brace

Technical Bulletin 084 Section A

46 Center Frame Brace Installation

10. Install replacement fasteners. Refer to Figure 6, Figure 7, Figure 8

WARNING: IT IS CRITICAL the bolts are installed from the rear with nuts on the Front side of the connection and that washers are under the nuts and the heads of the bolts. This is to ensure that any side load is carried by the shank of the bolt, not the thread.

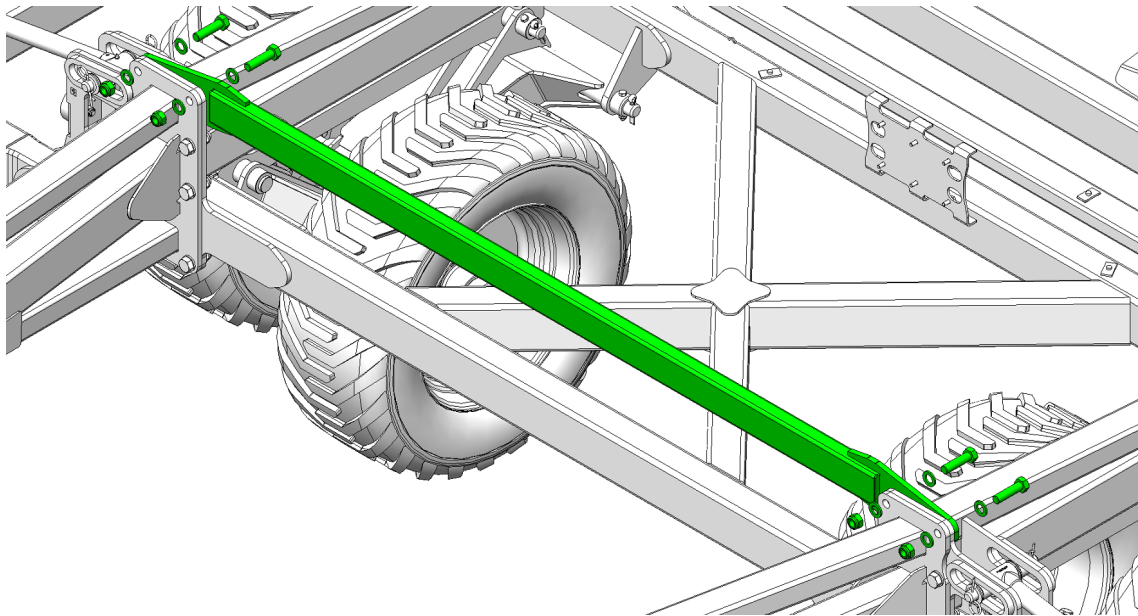

Figure 7 - Install Fasteners

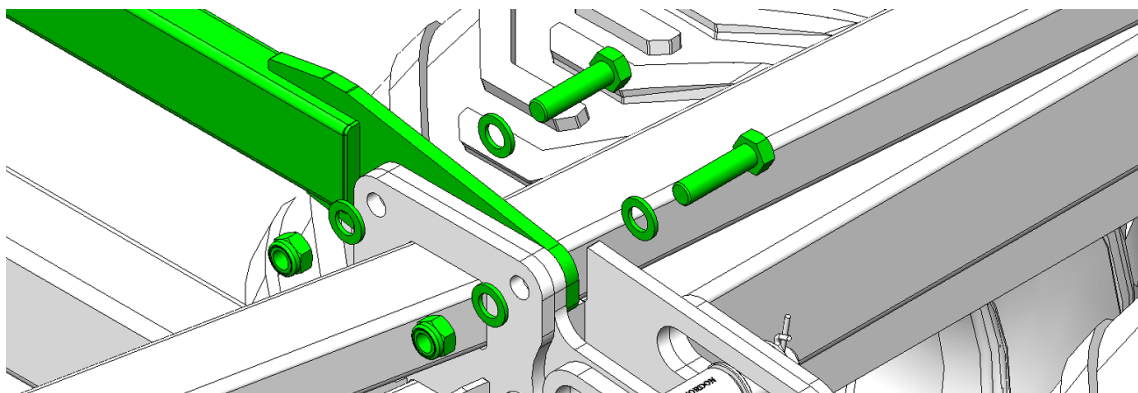

Figure 8 - Install Fasteners: Detail - Left Hand Side

Technical Bulletin 084 Section A

46 Center Frame Brace Installation

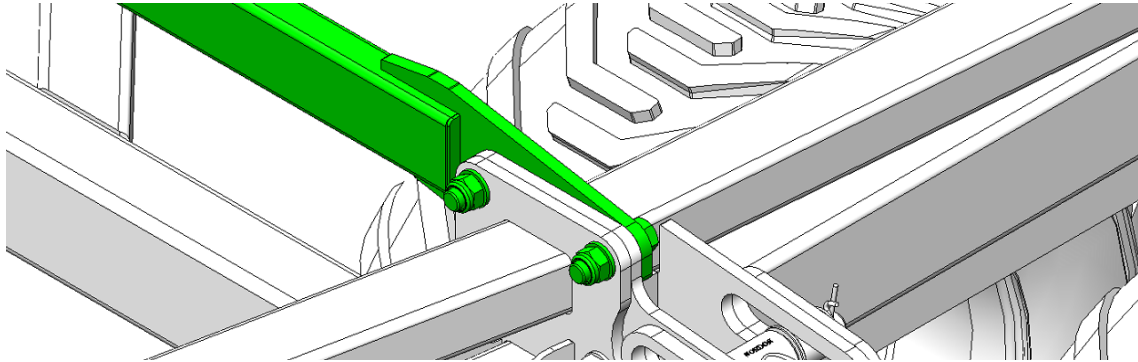

Figure 9 - Install Fasteners: Detail - Left Hand Side Tightened

11. Torque fasteners to 800Nm/590ft-lb.
12. Installation of 46 Center Frame Brace is now complete.

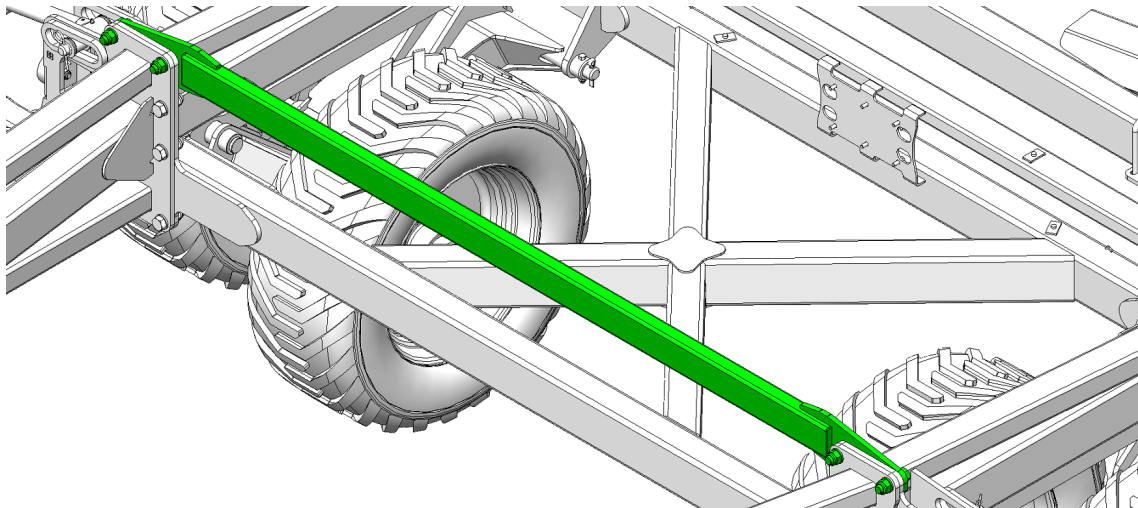

Figure 10 - 46 Center Frame Brace Correctly Installed



Technical Bulletin 084 Section A

46 Center Frame Brace Installation

Completion Confirmation:

Upon the completion of the installation, scan Figure 11 QR Code below, follow the prompts to complete the questionnaire.

An additional 12-month warranty on your Model 46 will be guaranteed upon completion of the questionnaire.



Figure 11 - 46 Center Frame Brace - Installation Confirmation Link

Do not hesitate to contact our Kelly Warranty team directly with any questions:

Kelly Australia

Phone: +61 8 8667 2253

Email: warranty@kellytillage.com

Hood & Company, Inc

Phone: 417-865-2100

Email: parts@hoodco.com

Important Warranty Information:

This fix is crucial in maintaining the integrity and quality of the machine and to avoid costly breakdown and repairs. Failure on the part of the dealer and/or the customer to make or arrange that fix could, under the terms of the Kelly warranty policy result in the warranty of the machine being null and void. Moreover, the fix must be performed with parts or components supplied by Kelly. Failure to do so, under the terms of the policy, would mean the warranty would be void.