

Bull Pull Tow Hitch – Correct Mount

Priority:

High Priority Check

Overview:

Correct Tow Hitch orientation on all models.

Kelly recommends all customers complete the following check prior to using their machine, to ensure the tow hitch is positioned and mounted correctly. This technical bulletin shows how our customers can verify this is correct, as shown in Figure 1.

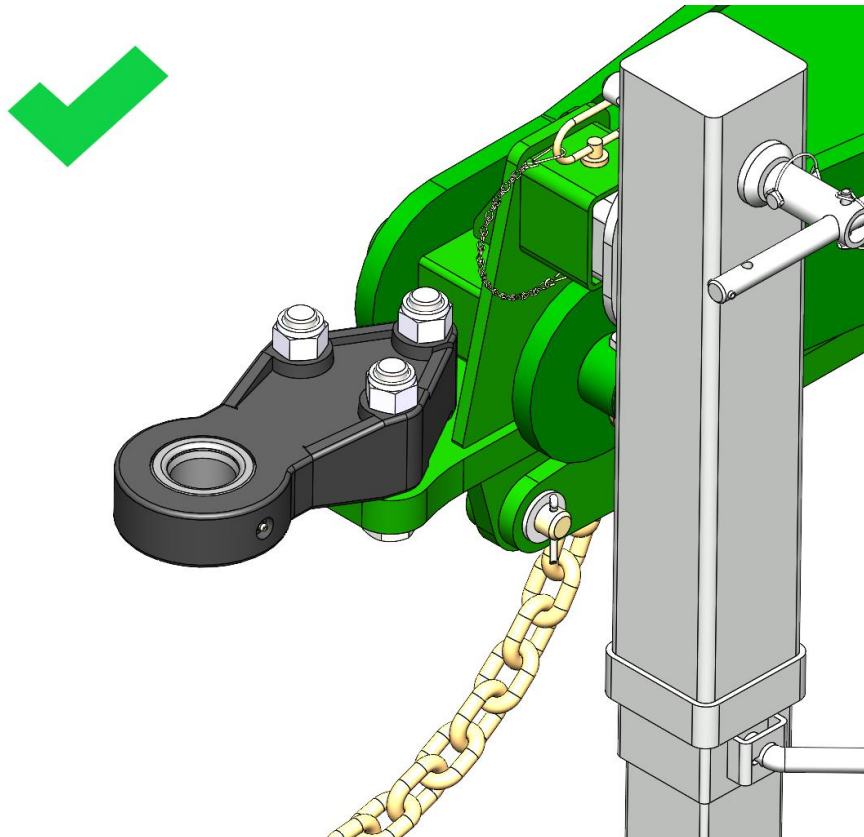

Figure 1 – Correct Mount

Technical Bulletin 090

Bull Pull Tow Hitch – Correct Mount

Here are the possible incorrect positions that should never be used in any possibility as shown in Figure 2, Figure 3, and Figure 4.

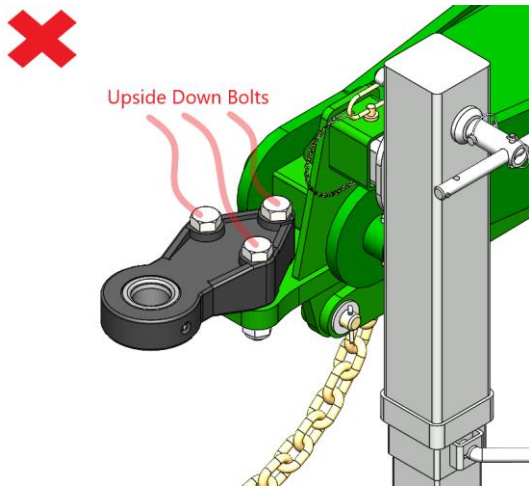

Figure 2 – Upside Down Bolts

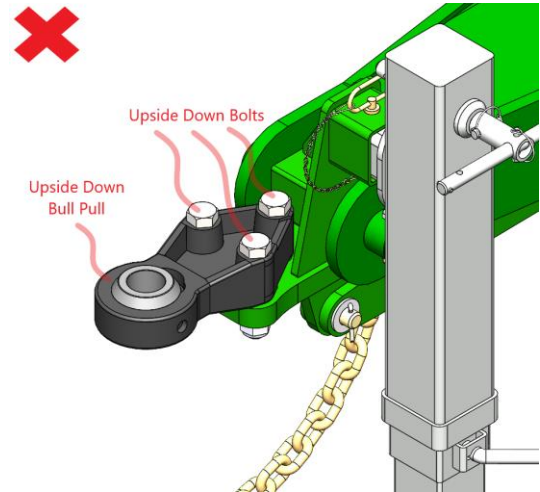

Figure 3 – Upside Down Bolts & Bull Pull

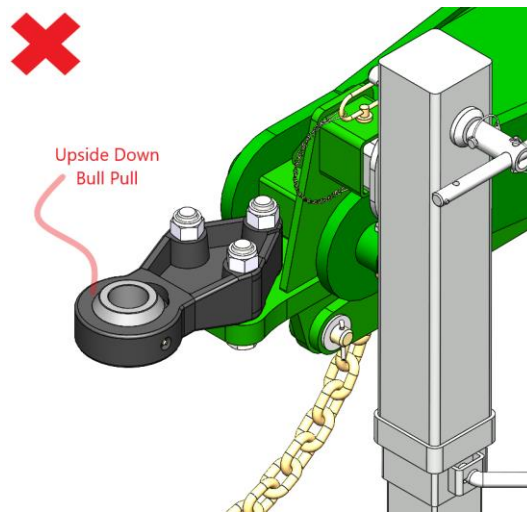

Figure 4 – Upside Down Bull Pull

Bull Pull Tow Hitch – Correct Mount

In any configuration do not use the bull pull at the bottom as shown in Figure 5.

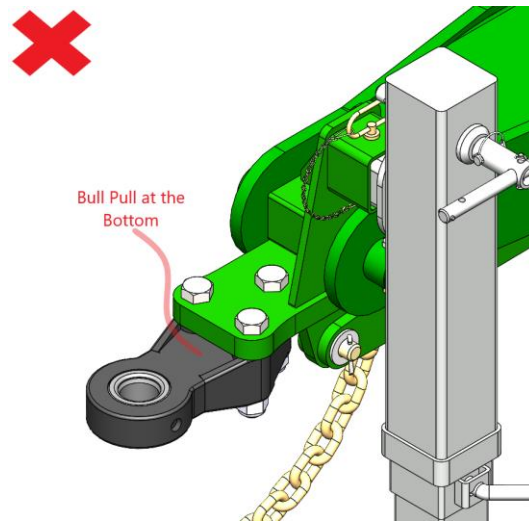

Figure 5 – Bull Pull at the Bottom

If you discover your Bull Pull Tow Hitch has been incorrectly mounted, please reassemble as advised in **Figure 1** and re torque the bolts to the required torque setting of **849 Ft-Lbs / 1151Nm**.

Tow hitch bolts should be checked regularly for wear and torque as part of your regular maintenance routine.

Do not hesitate to contact our Kelly Warranty team directly with any questions:

Kelly Australia
Telephone: +61 8 8667 2253
Email: warranty@kellytillage.com

Hood & Company
Telephone: 417-865-2100
Email: parts@hoodco.com