

This technical bulletin outlines the procedure for fitting part number 0810-RFTT-Kit (Retro fit tail tip kit) to existing machines

Before

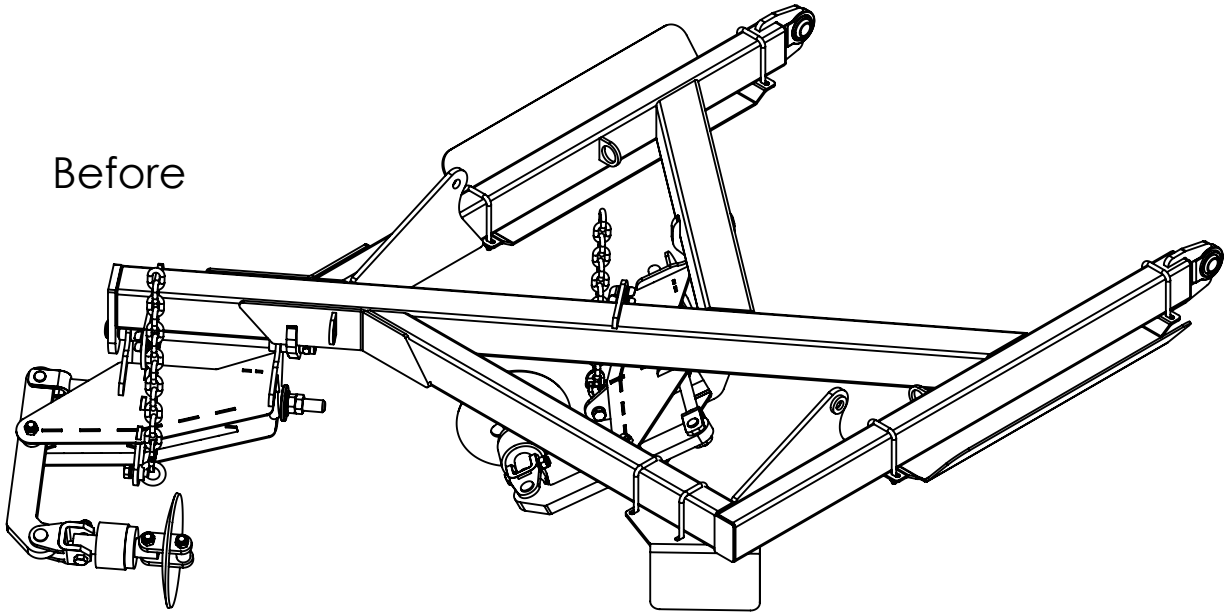

After fitting kit

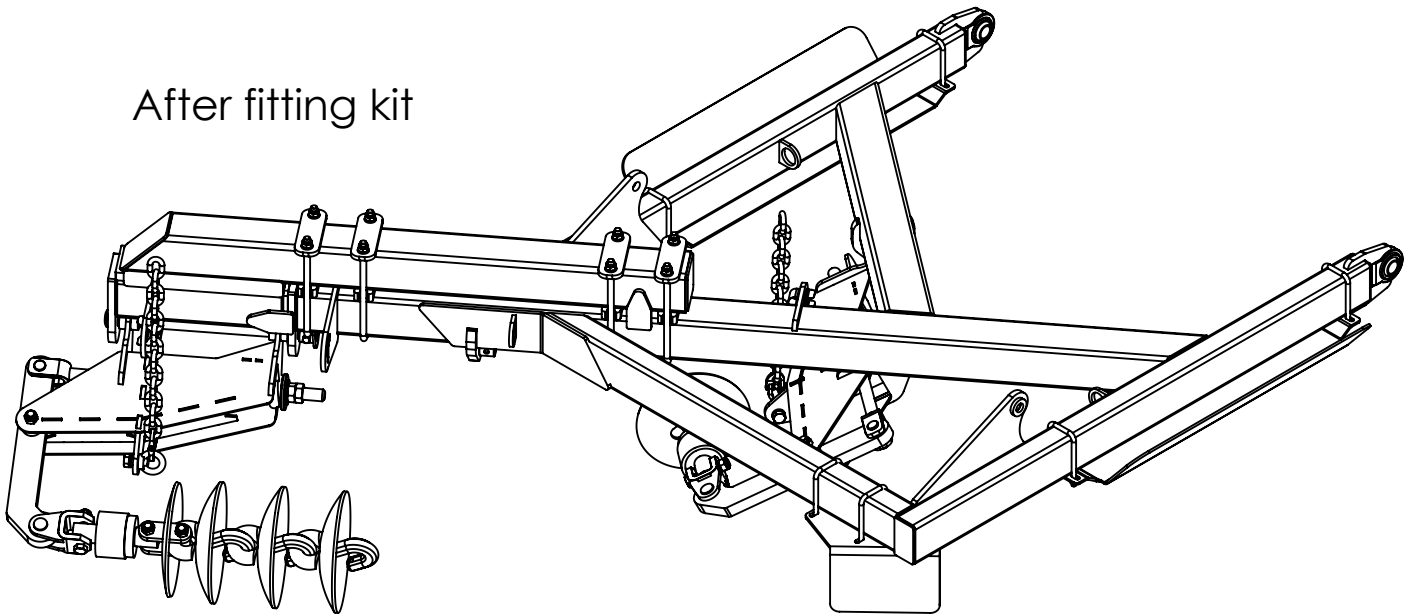

Step 1:

With machine folded out into working position. Disconnect RHR chain from rear swivel.

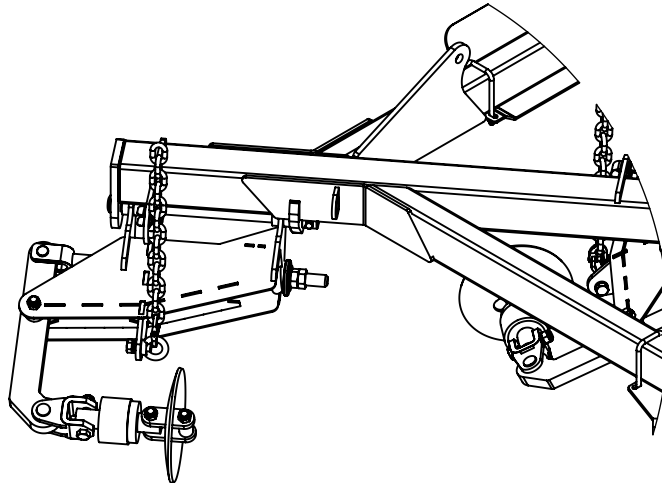

Step 2:

Remove rear tension box by removing the pivot pin and adjuster chain

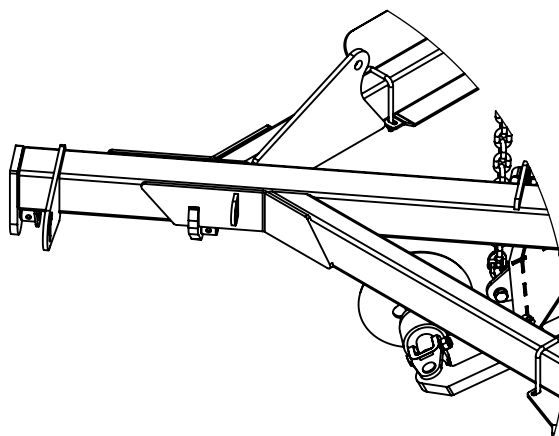

Step 3:

Place new part 0810-RFTT-FAB into position ensuring all mating surfaces are touching as shown below

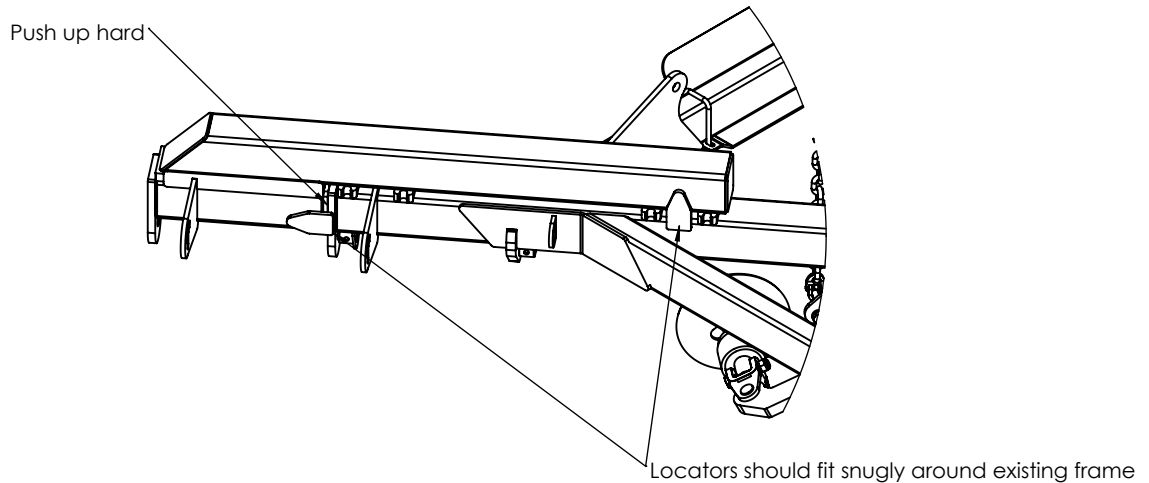

Step 4:

Using the U-Bolts and plates supplied clamp the fram into position as shown below

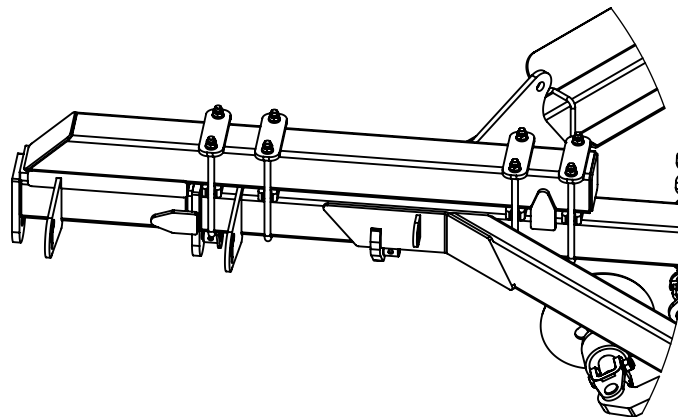

Step 5:

Re fit the chain tension assembly using the existing pivot pin into the new location as shown below

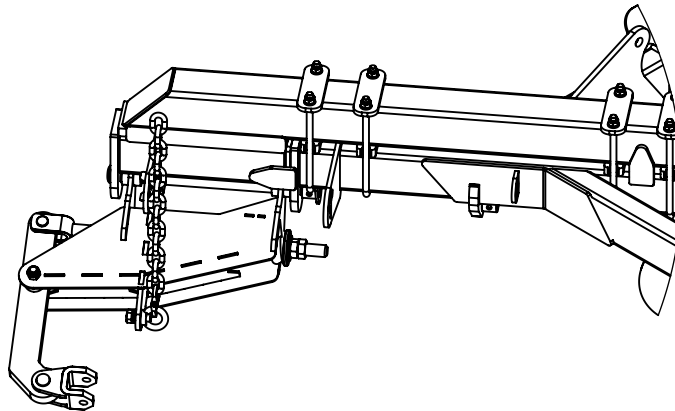

Step 6:

Lock the pivot pin into position using the Locking bush (0810-RFTT-LC) supplied as shown below

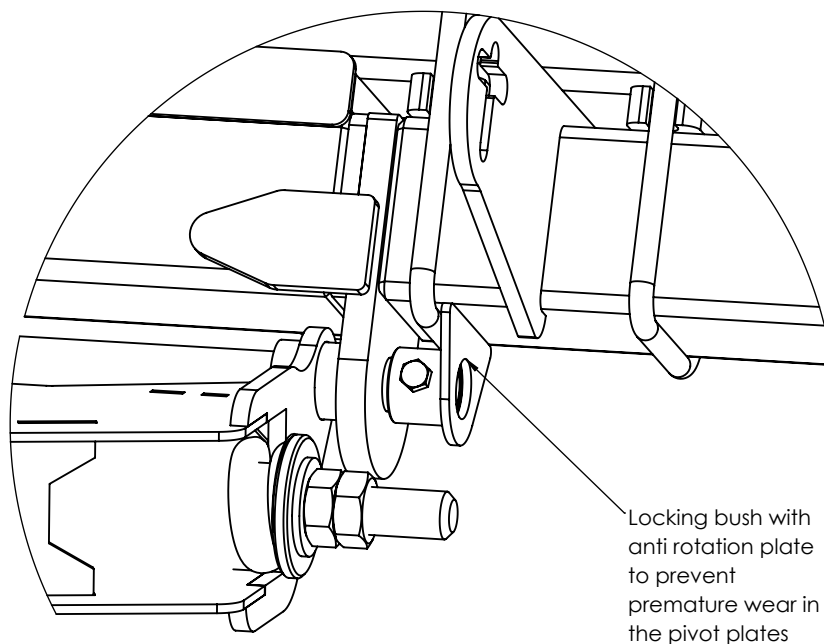

Step 7:

Add the 3 extra chain link discs to the existing chain and reconnect to the swivel

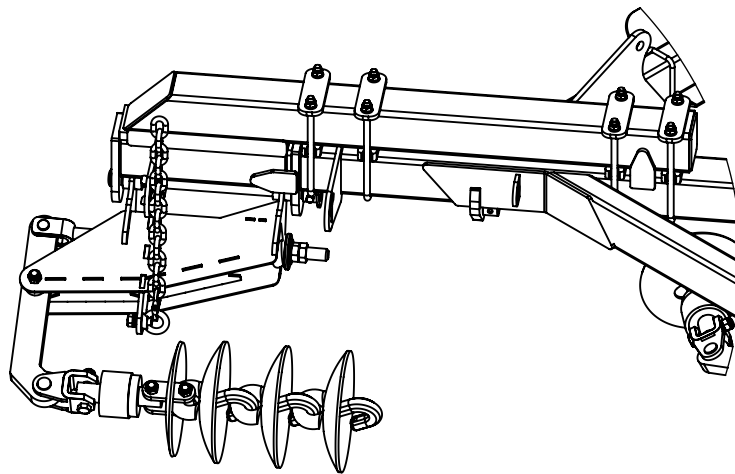

The machine is now ready to be used. This kit adds 3 chain links to the RHR chain allowing more overlap at the rear of the machine.