



Better Tillage. Better Tomorrow.

Assembly Manual

KELLY TILLAGE SYSTEM PRICKLE CHAIN MODULE

KEASM-PCM-C-12052020

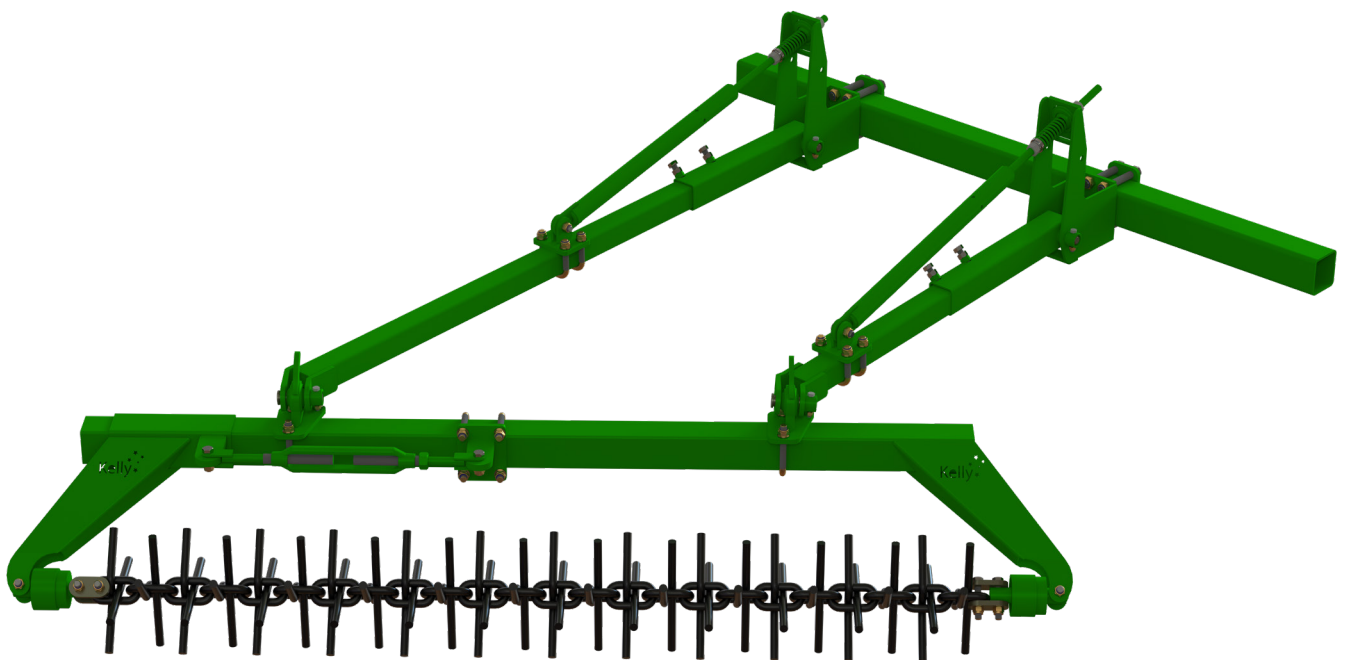

SERIAL NUMBER:



Phone +61 8 8667 2253
Email sales@kellytillage.com
kellytillage.com

Booleroo (Head Office)
684 Kelly Road,
Booleroo Centre SA 5482

Adelaide Office
28 Greenhill Road,
Wayville SA 5034





Thank you for choosing a KELLY product.

We trust that you find the following manual clear and easy to follow. If you should require additional customer support or assistance, please do not hesitate to contact us.

Spare parts can be purchased, as required, through your local dealer or by contacting KELLY directly.

The KELLY team values your feedback. Should you have any difficulties that you wish to raise, suggestions for improvement or modifications that you feel would enhance our products we look forward to hearing from you.

Contact Us

Australia

Booleroo (Head Office)

684 Kelly Road,
Booleroo Centre SA 5482

+61 8 8667 2253

Monday - Friday
8am - 4pm ACDT

Adelaide Office

28 Greenhill Road,
Wayville SA 5034

+61 8 8667 2253

Monday - Friday
8am - 4pm ACDT

Global Locations

Eastern Canada

Leading Edge Equipment
www.leadingedgeequipment.ca

1-519-421-3223

Monday - Friday
8am - 4pm EST

Western Canada

Adair Sales & Marketing Co Inc
www.adairreps.com

1-306-773-0996

Monday - Friday
8am - 5pm CST

United States

Hood & Company

+1 417-865-2100

Monday - Friday
8am - 4pm CST

Europe

kellytillage.com

+61 8 8667 2253

Monday - Friday
8am - 4pm ACDT

Argentina

Giorgi Sa Maquinarias Agricolas
www.giorgi.com.ar

+54 3464 493512

Monday - Friday
8am - 5pm ART

South Africa

Desmond Whitfield CC

+27 82 567 8245

Monday - Friday
8am - 4pm SAST

Contents

Section 1 - Set Up	4
Section 2 - Assembly	6

Legend



This symbol indicates which bag the relevant fasteners are in.



This symbol indicates which bag the relevant hydraulics are in.



This symbol indicates the hydraulics are in a box.

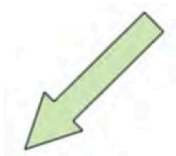

This symbol indicates which way the machine is travelling.



Section 1 - Set Up

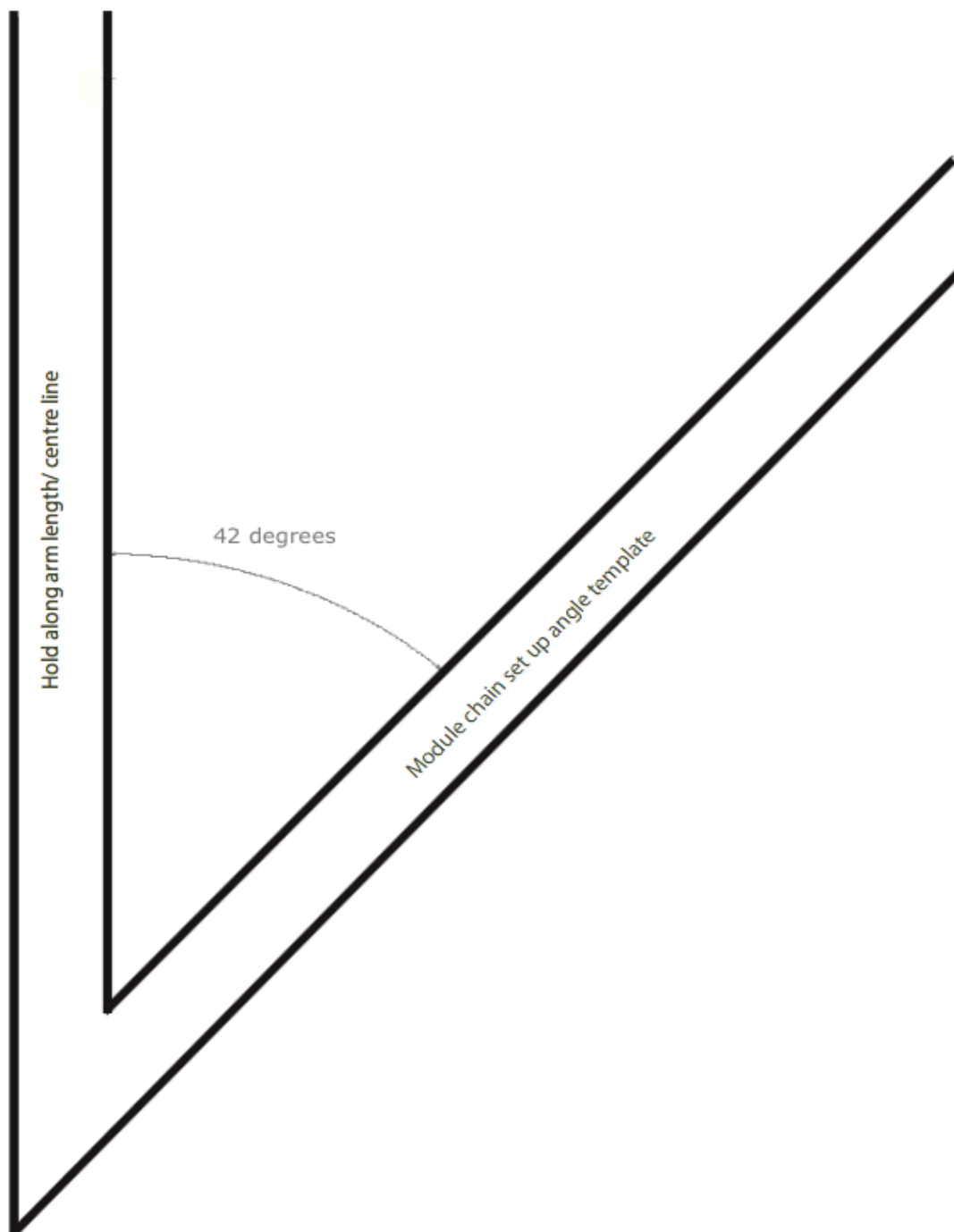

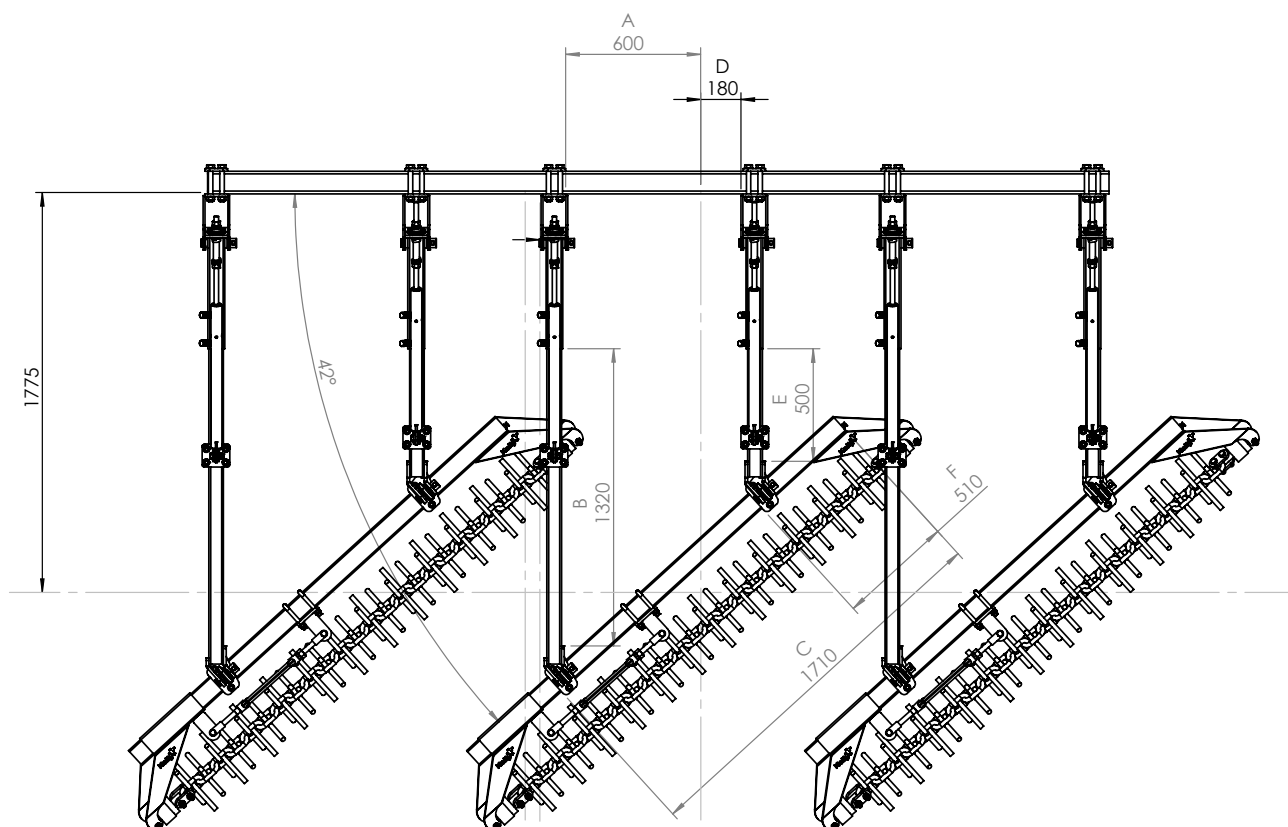

Measurements (mm)						
A	200	300	400	500	600	700
B	1170	1305	1440	1575	1710	1845
C	960	1050	1140	1230	1320	1410
D	80	180	280	380		
E	645	510	375	240		
F	590	500	410	320		

We recommend you start at the middle of your machine and work outwards from the centreline. This ensures that the working width of the modules is achieved.

NOTE:

- Before starting mark these points on cultivator framework and ground
- Measurements are a guide only as mounts may need to be shifted to fit around tynes etc.
- If even number of modules are purchased work the centreline out from the middle two modules where they cross over
- If odd numbers are purchased mark as image above

Section 2 - Assembly

Item No.	Description	Qty	Number
1	Module Mount Arm	1	1110-01
2	M20 x 150 grade 8.8 ZP Bolt	4	0211-20##
3	Nyloc Nut M20	4	0221-NYL## (Nyloc Nut Metric)
4	Module Mt Bolt Plate	1	1100-05
5	Washer Flat M20	4	0231-F

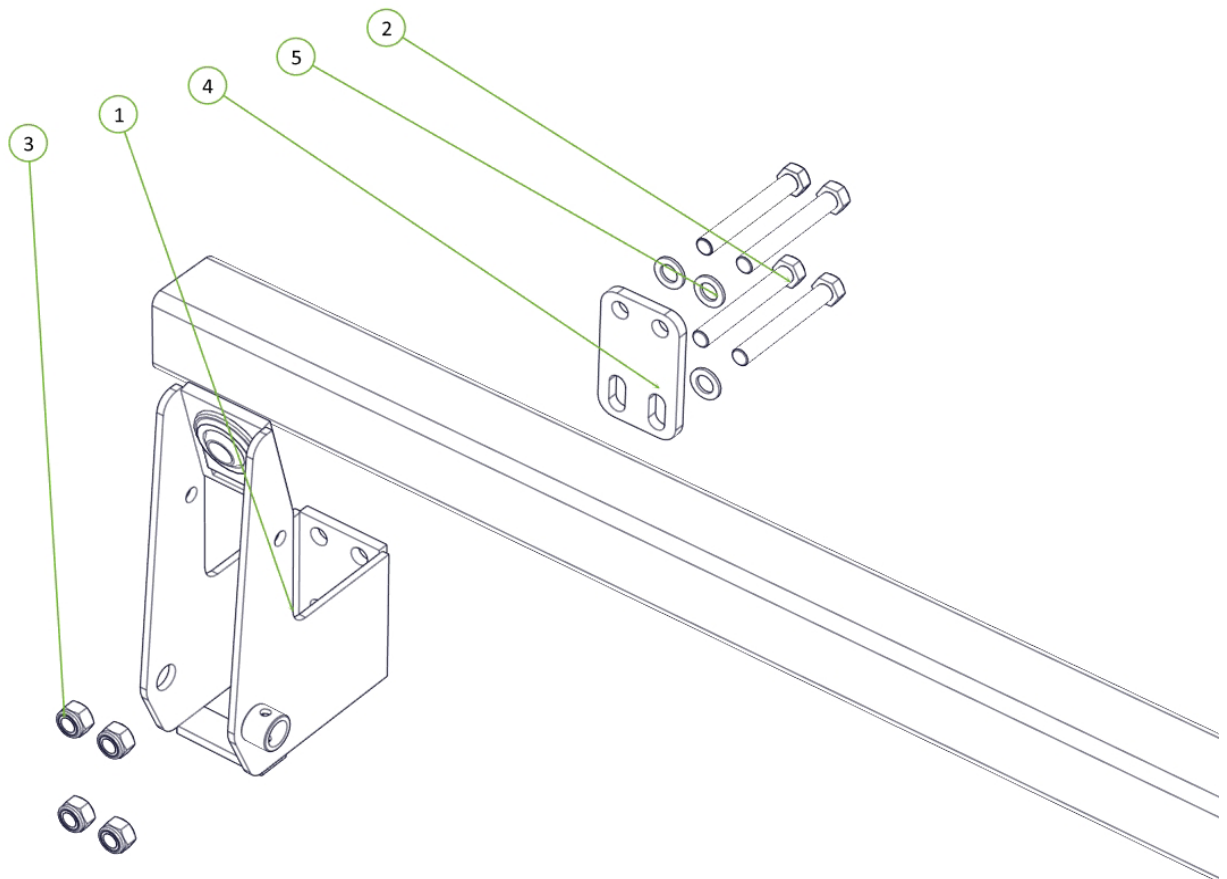

Item No.	Description	Qty	Number
1	Module Mount Arm	1	1110-01
2	Nyloc Nut M20	4	0221-NYL## (Nyloc Nut Metric)
3	Module Mt Bolt Plate	1	1100-05
4	M20 x 150 grade 8.8 ZP Bolt	4	0211-20##
5	Washer Flat M20	4	0231-F

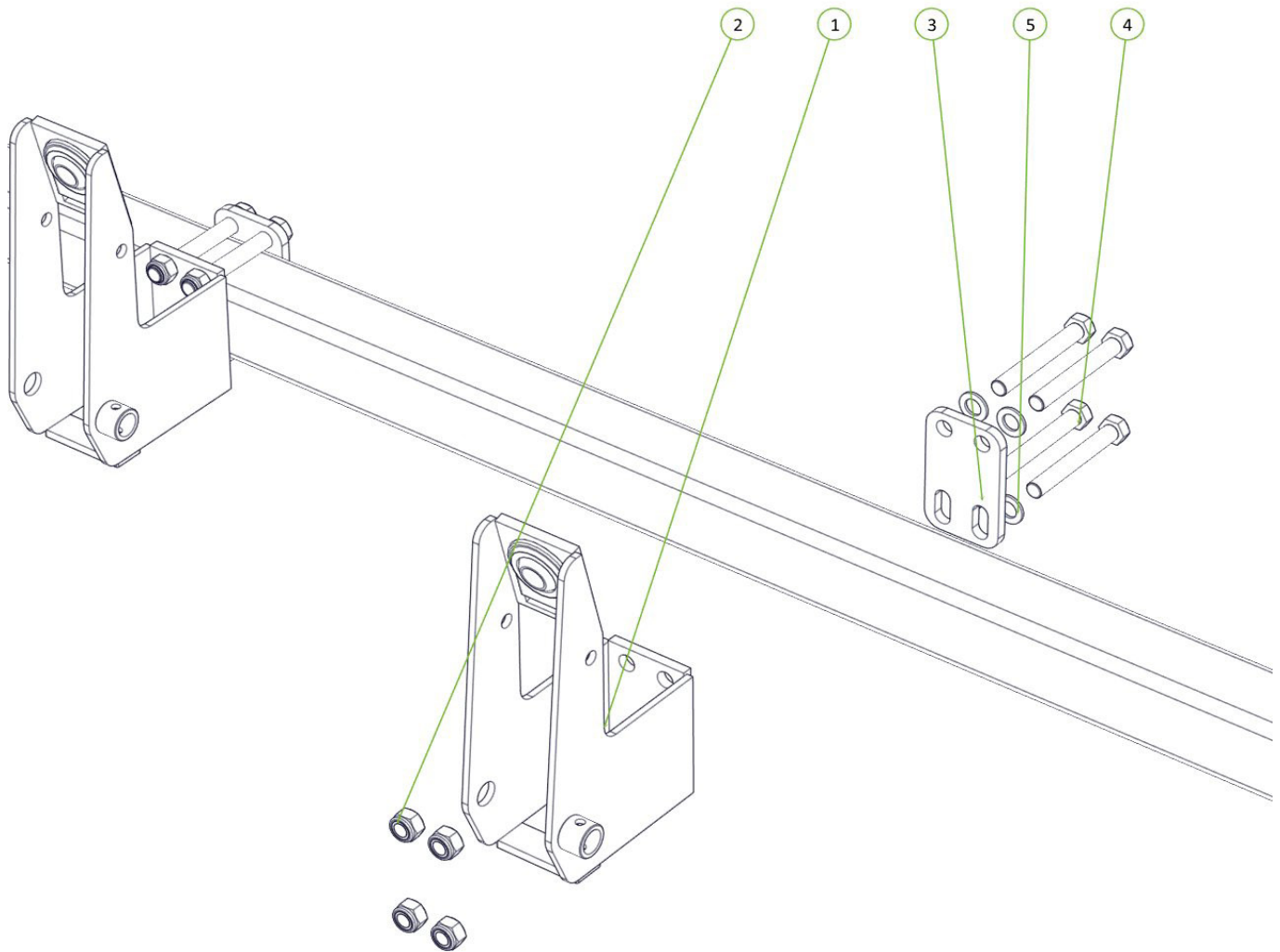

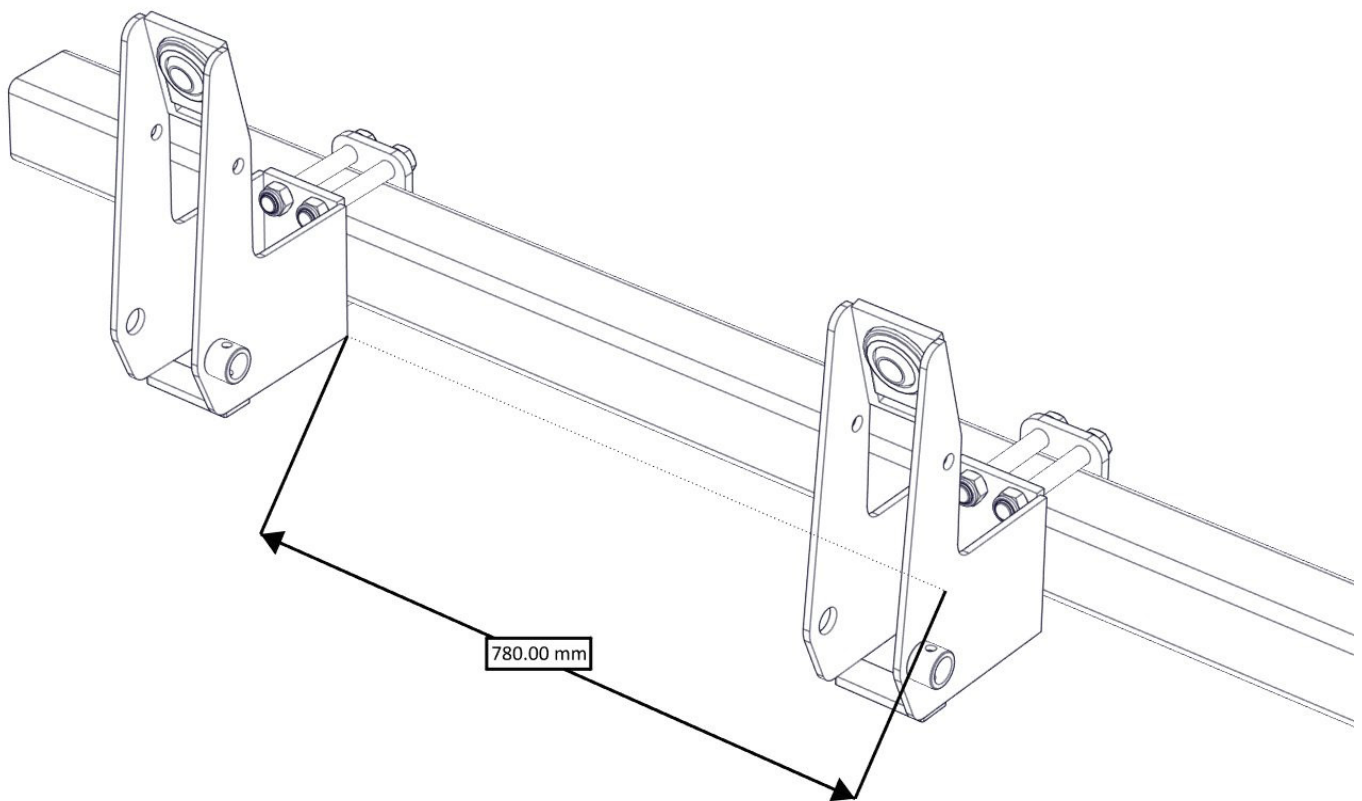
**NOTE:**

- The measurement is a guide only.
- Please see page 5 for a table guide.
- **ONLY LOOSELY ATTACH** - Don't do up fasteners to allow manouverability during set up.

Item No.	Description	Qty	Number
1	Module Pivot Arm	2	1110-02
2	MB ID 28mm x 30mm DU Bush	4	0113-MB 2830DU
3	Module Arm Pivot Pin	2	1101-13
4	M10 x 55 grade 8.8 ZP Bolt	2	0211-10##
5	Nyloc Nut M10	10	0221-NYL10

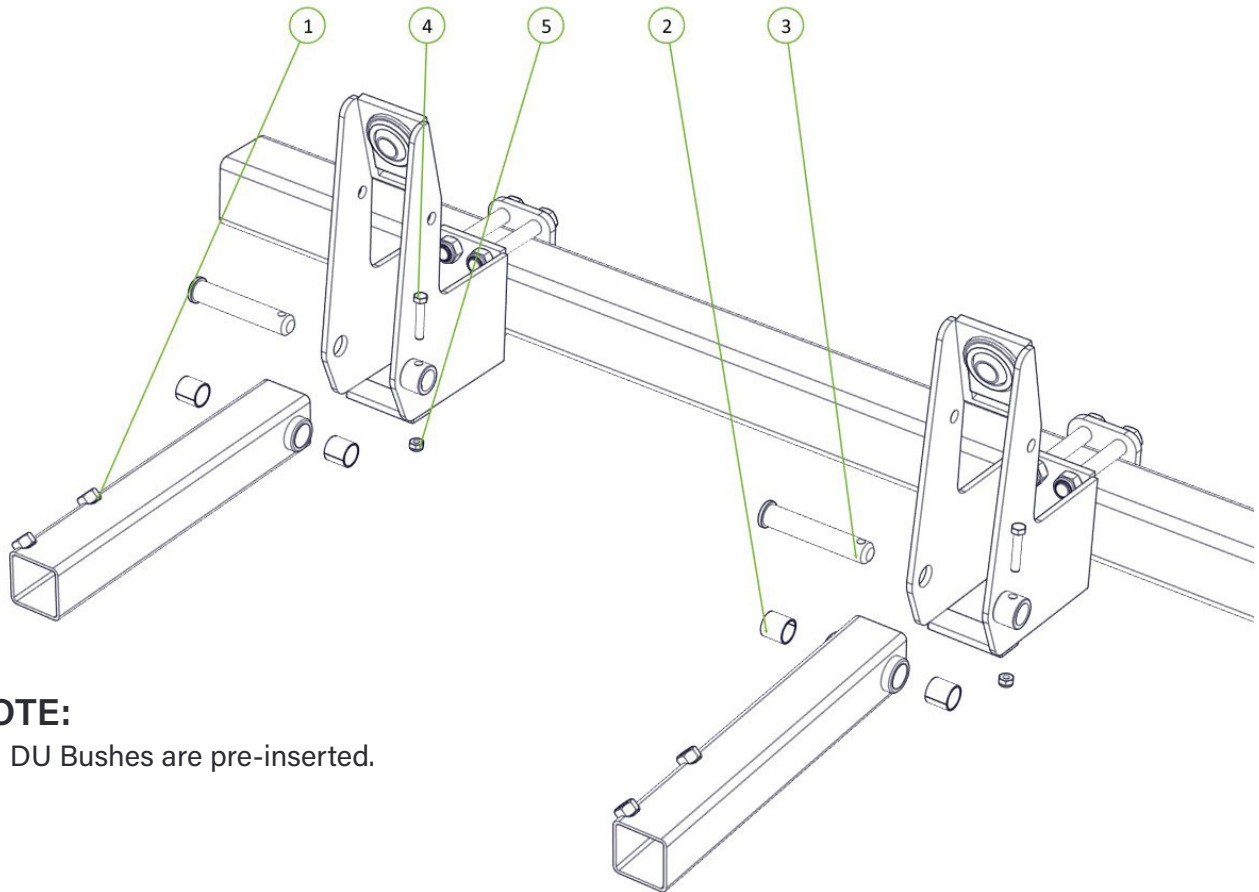

NOTE:

- DU Bushes are pre-inserted.

Item No.	Description	Qty	Number
1	Long Adjusting Arm	1	1110-03
2	M16 x 40 grade 8.8 zp Bolt	2	0211-1655 SET
3	M16 Plain Nut Galv	2	0221-16

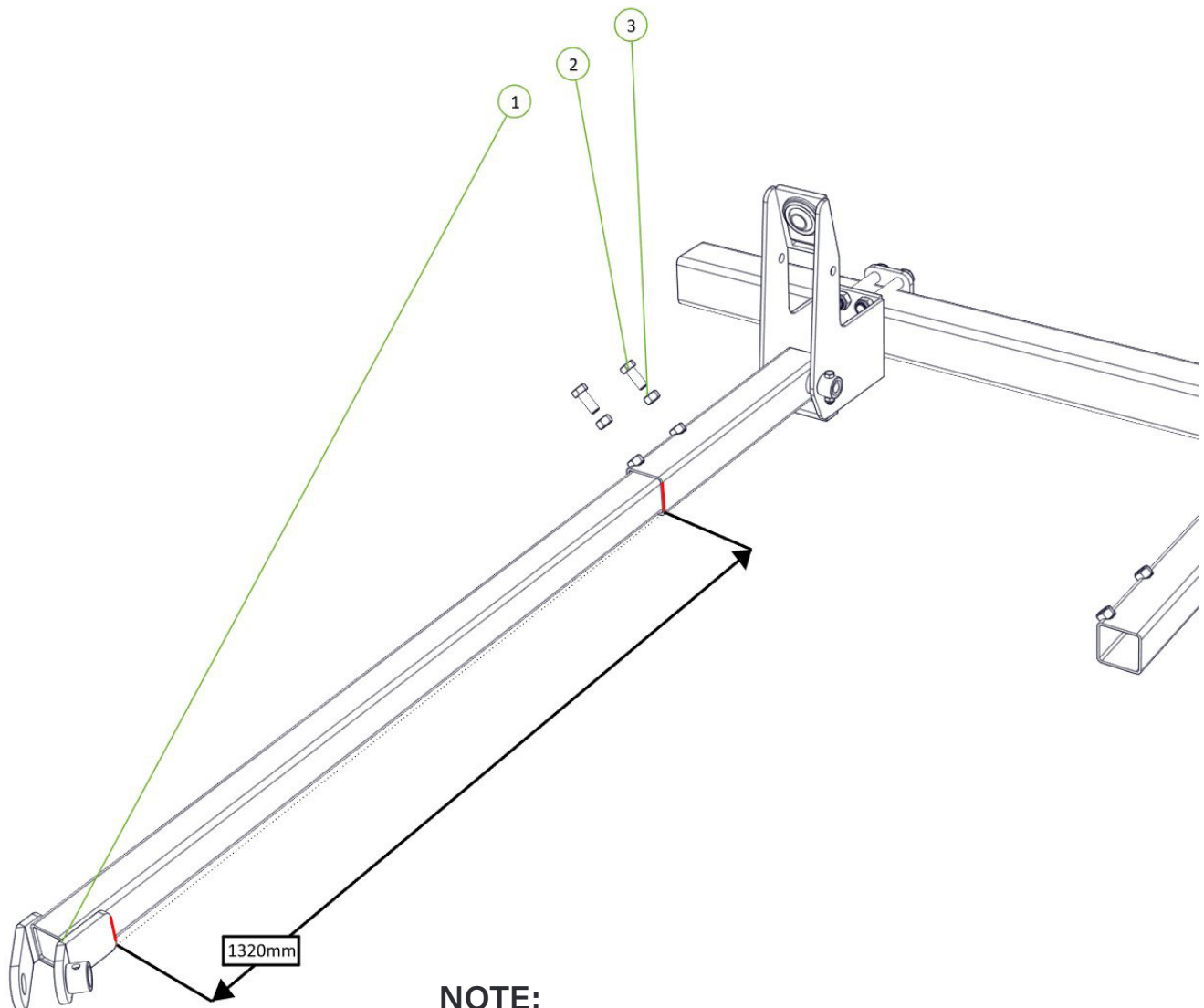
**NOTE:**

- The measurement is a guide only.
- Please see page 5 for a table guide.
- Lock nuts to be tightened once assembly complete.

Item No.	Description	Qty	Number
1	Short Adjusting Arm	1	1110-04
2	M16 x 40 grade 8.8 zp Bolt	2	0211-1655 SET
3	M16 Plain Nut Galv	2	0221-16

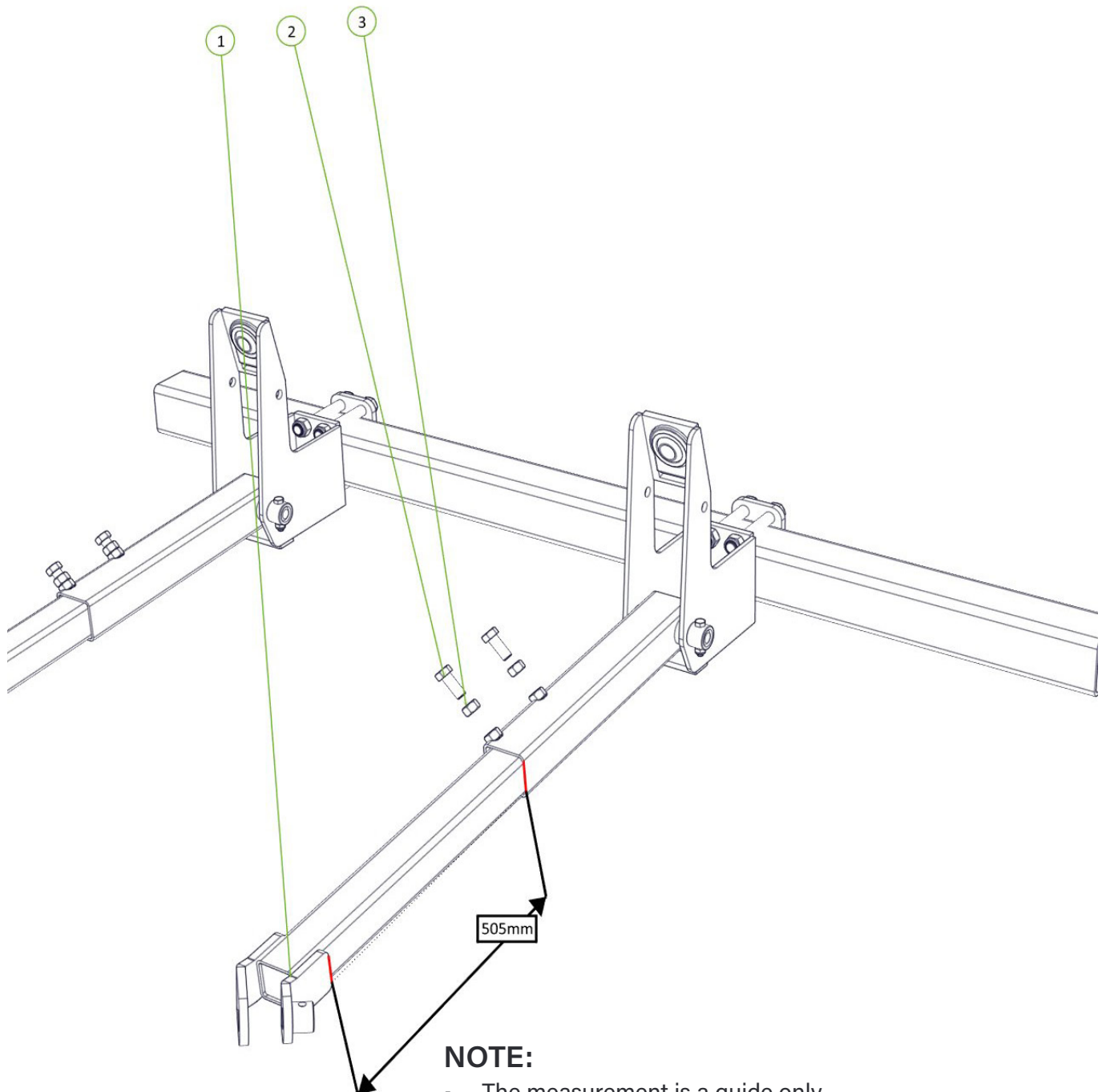
**NOTE:**

- The measurement is a guide only.
- Please see page 5 for a table guide.
- Lock nuts to be tightened once assembly complete.

Item No.	Description	Qty	Number
1	Module Height Adjust Mount	2	1110-05
2	Nyloc Nut M16	8	0221-NYL## (Nyloc Nut Metric)
3	Washer Flat M16	8	0231-F
4	U Bolt M16 x 100 Deep x 70 Wide	4	0271-1610070

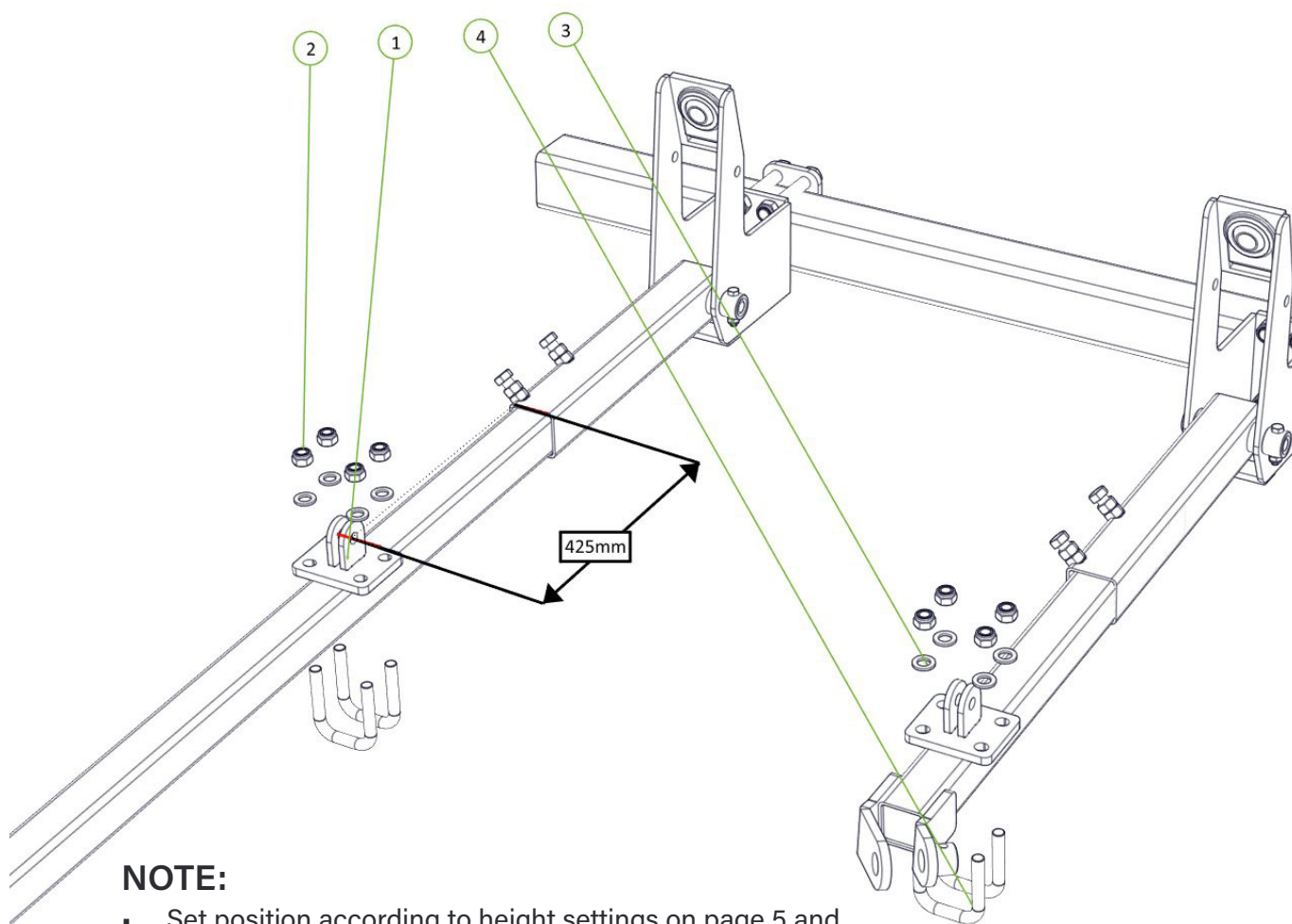

NOTE:

- Set position according to height settings on page 5 and centralise tie rods adjustment range.
- U-Bolts should be tightened.

Item No.	Description	Qty	Number
1	Tie Rod Arm	1	1110-13
2	Module Height Adjust Pipe	1	1110-07
3	Height Adjust Washer	2	1100-18
4	Cultivator Module Spring	1	1101-PCHMOD1.1
5	M20 Plain Nut Galv	2	0221-20
6	M16 x 50 grade 8.8 zp Bolt	1	0211-1655 SET
7	Nyloc Nut M16	1	0221-NYL## (Nyloc Nut Metric)
8	Washer Spring M20	2	0231-S

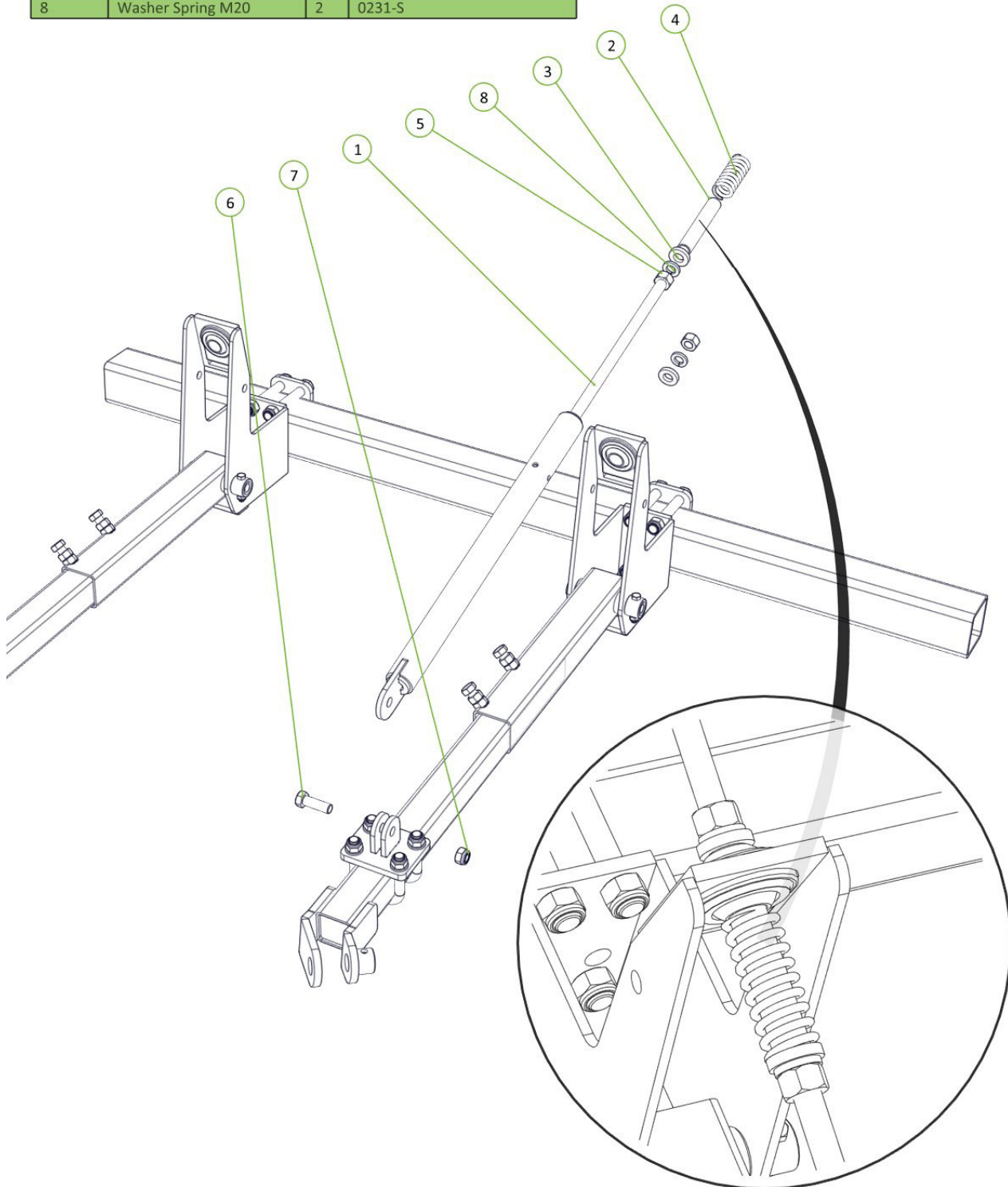

Item No.	Description	Qty	Number
1	Height Adjust Washer	2	1100-18
3	Tie Rod Arm	1	1110-13
4	Module Height Adjust Pipe	1	1110-07
5	M16 x 50 grade 8.8 zp Bolt	1	0211-1655 SET
6	M20 Plain Nut Galv	2	0221-20
7	Nyloc Nut M16	1	0221-NYL## (Nyloc Nut Metric)
8	Washer Spring M20	2	0231-S
9	Cultivator Module Spring	1	1101-PCHMOD1.1

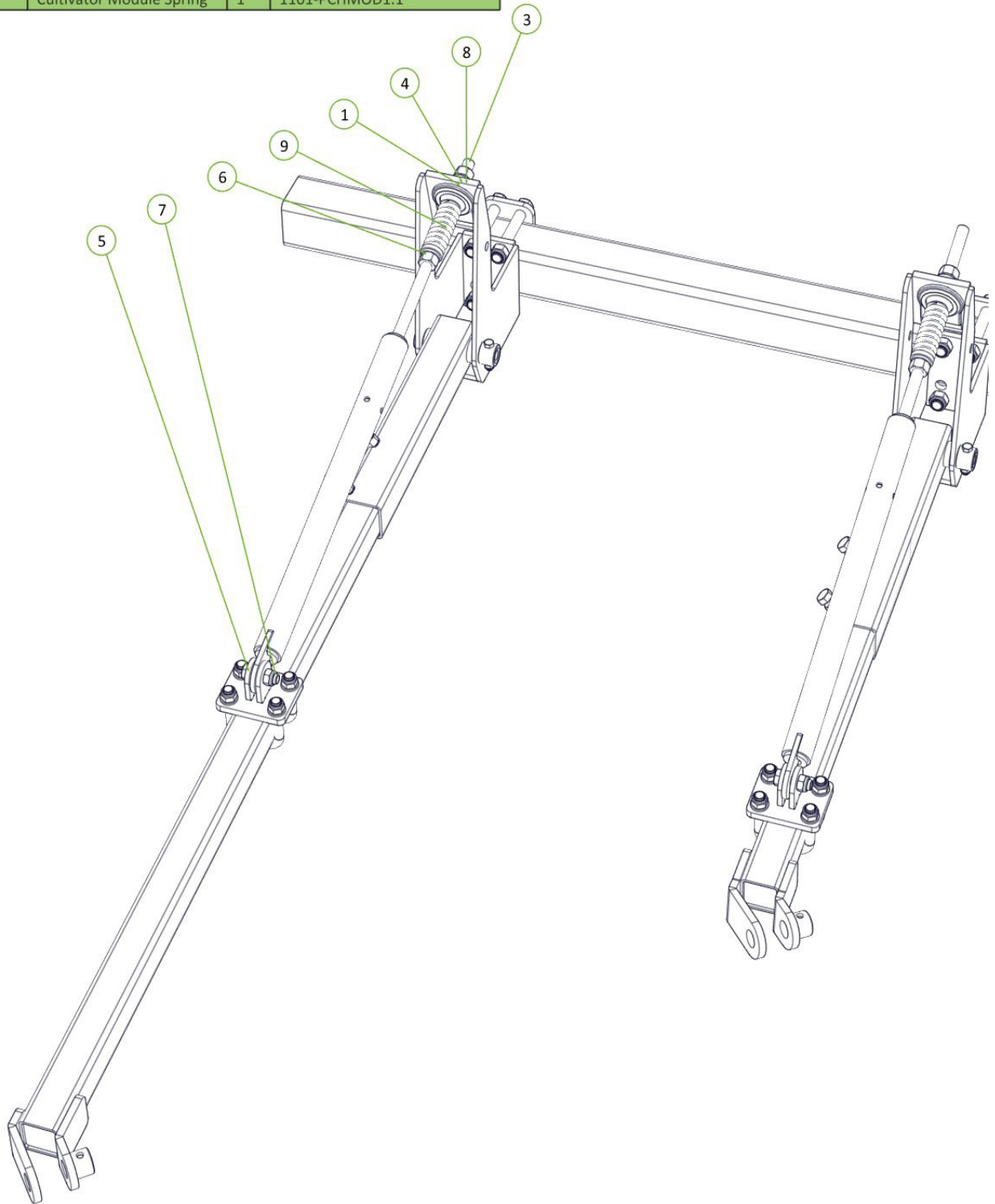

Item No.	Description	Qty	Number
1	Module Bow Pivot	2	1110-08
2	Module Bow Pivot Pin	2	1101-14
3	M10 x 55 grade 8.8 ZP Bolt	2	0211-10##
4	Nyloc Nut M10	2	0221-NYL## (Nyloc Nut Metric)

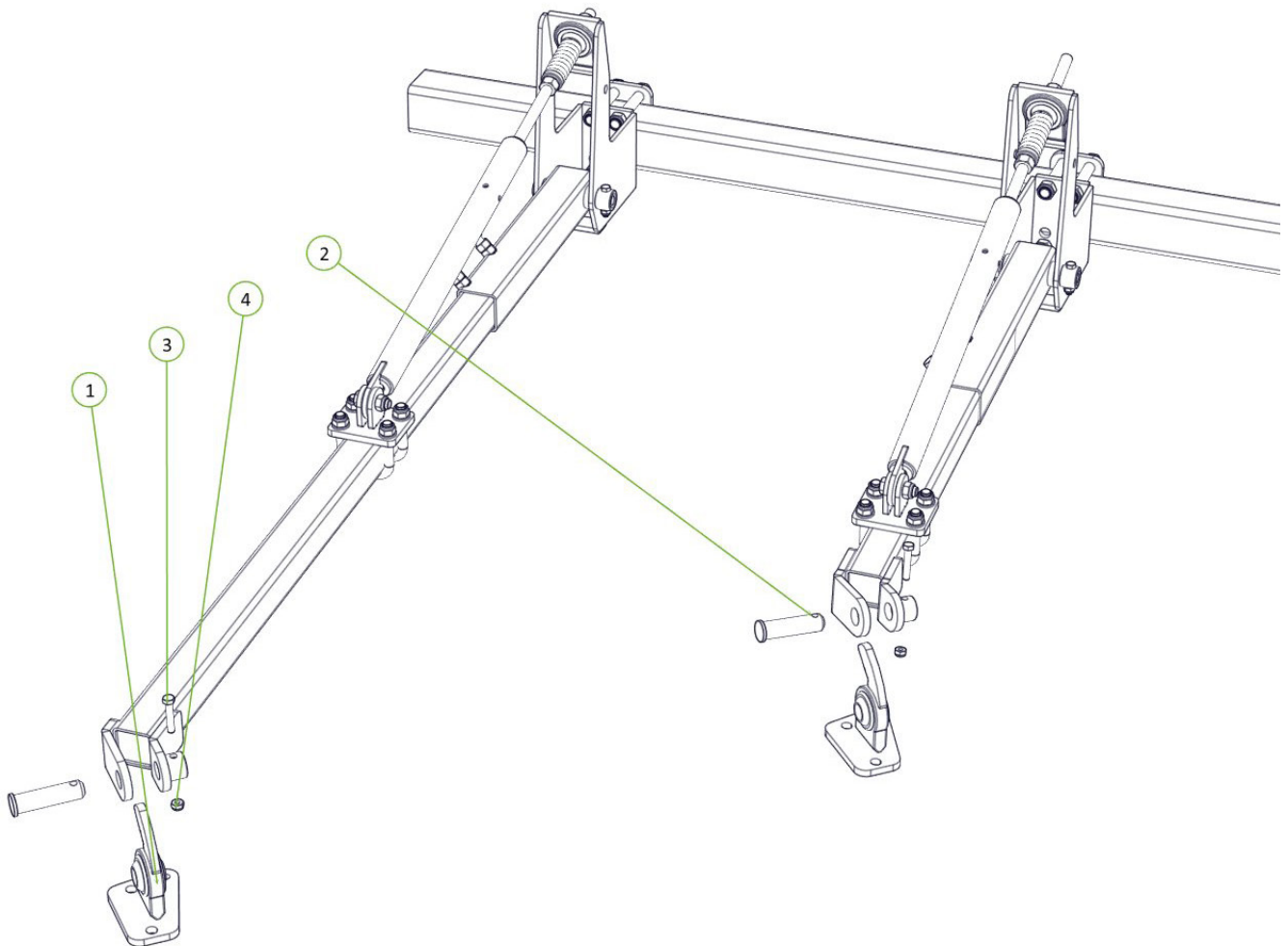

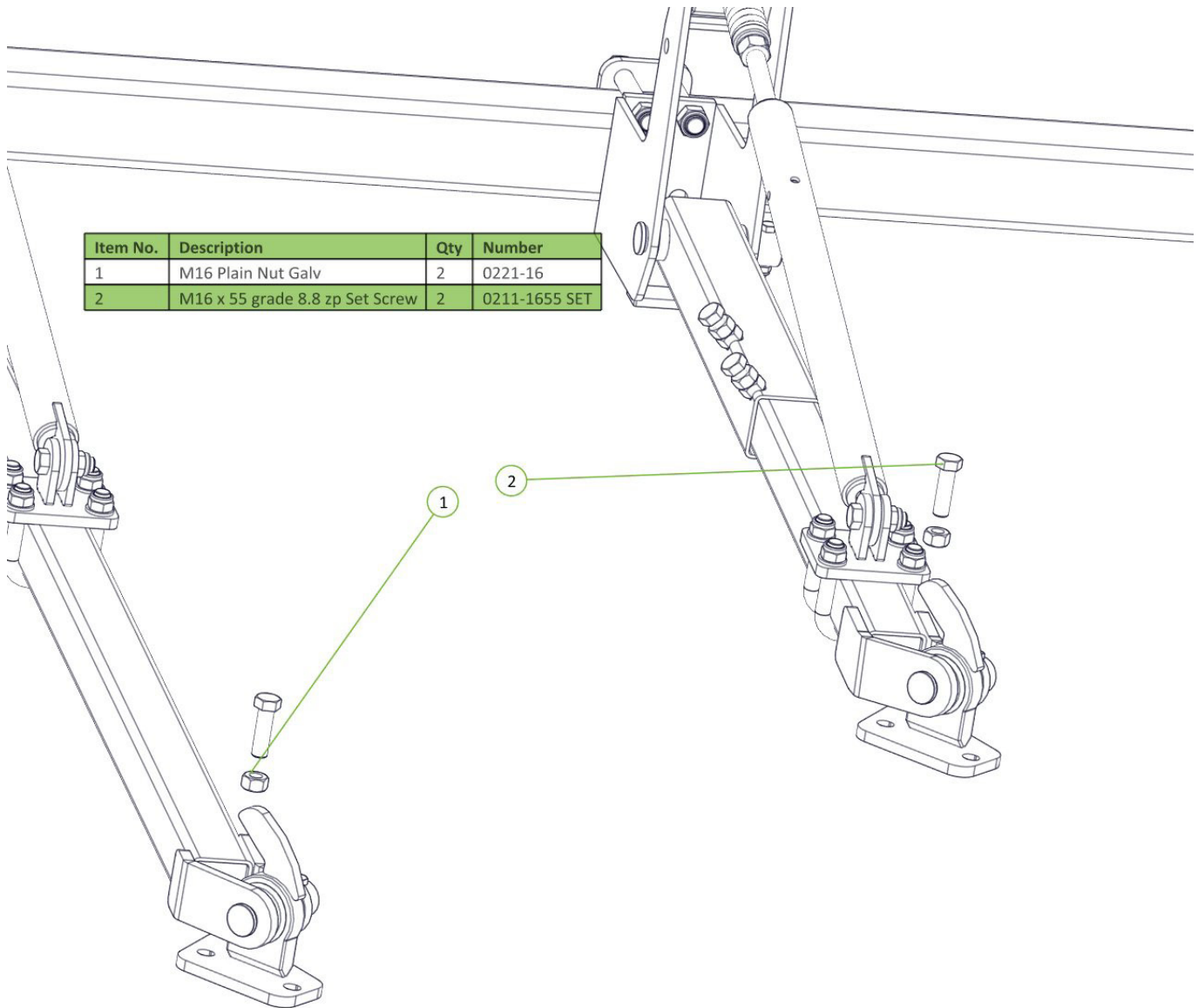
**NOTE:**

- These set screws are to keep the modules level. Set both height adjusters and locks with lock nut.

Item No.	Description	Qty	Number
1	U Bolt M16 x 130 Deep x 95 Wide	2	0271-1613095
2	Nyloc Nut M16	4	0221-NYL## (Nyloc Nut Metric)
3	Washer Flat M16	4	0231-F
4	Cultivator Module Bow	1	1110-09

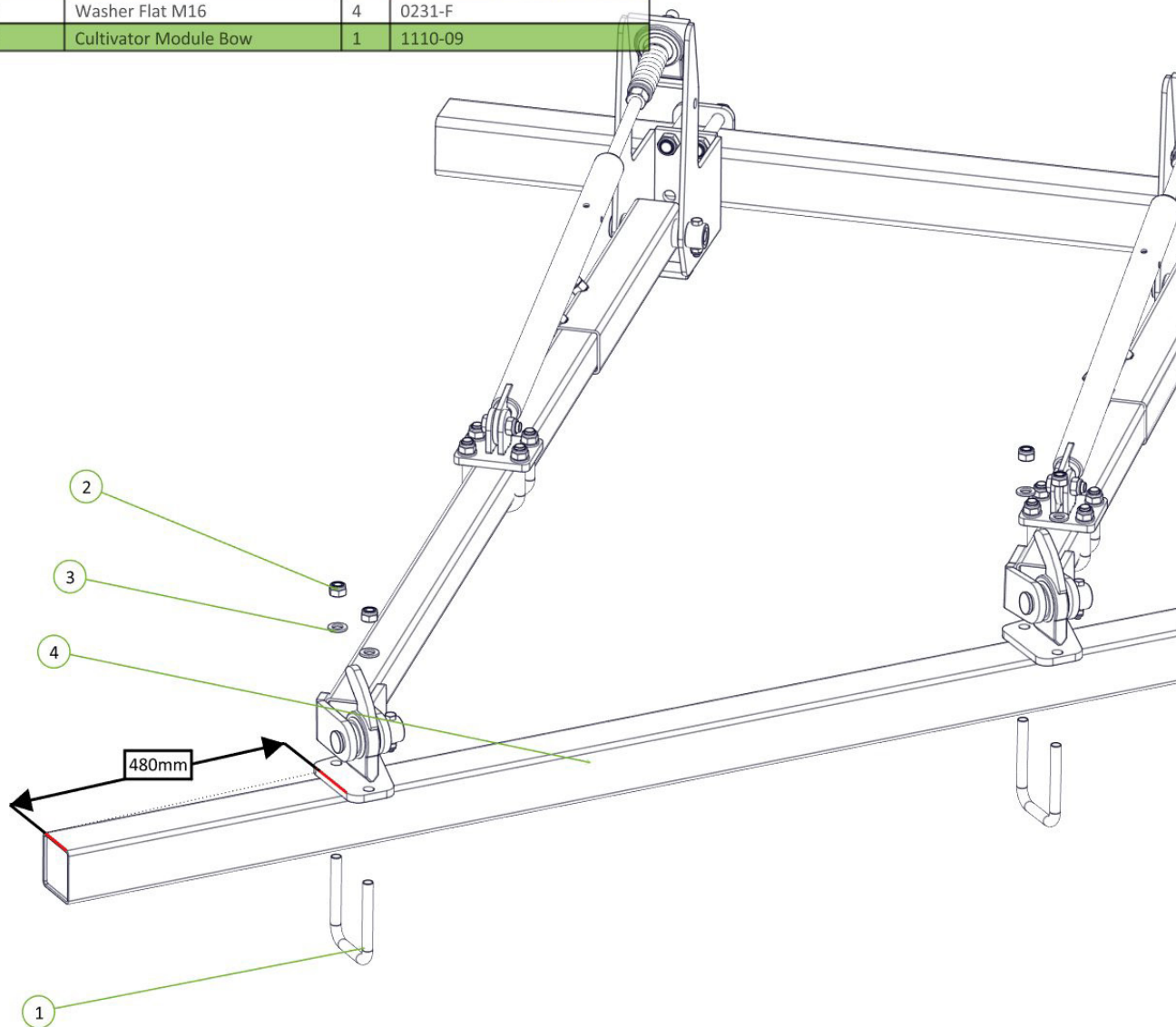
**NOTE:**

- The measurement is a guide only.
- Please see page 5 for setup guide.
- A drum or 400mm block may help with bow positioning.
- To set up correct angle see page 4 for template.

Item No.	Description	Qty	Number
1	Module Tension Mount	1	1110-11
2	Nyloc Nut M16	4	0221-NYL## (Nyloc Nut Metric)
3	Washer Flat M16	4	0231-F
4	U Bolt M16 x 130 Deep x 95 Wide	2	0271-1613095

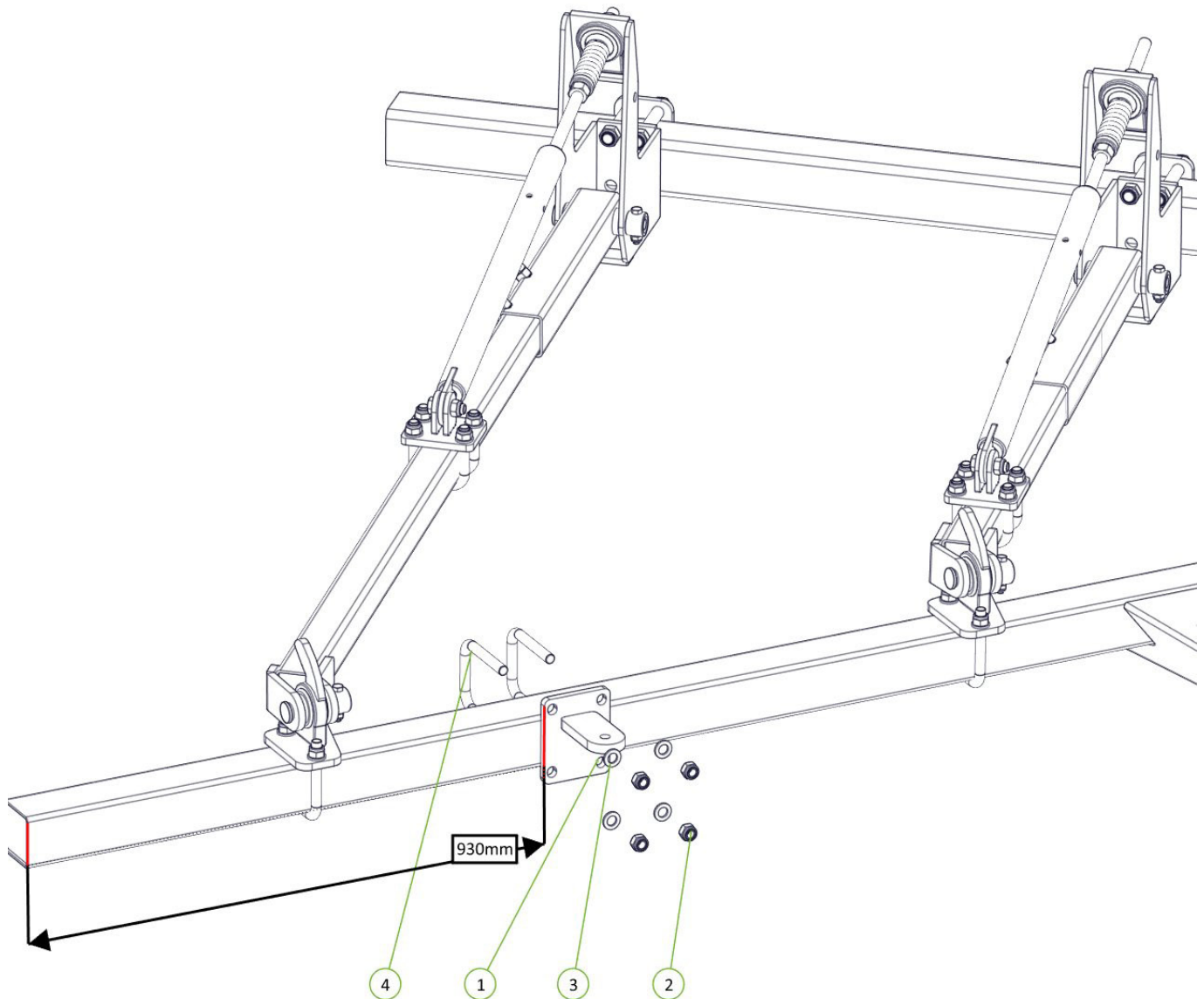

NOTE:

- This can be adjusted to maximise range in turnbuckle, according to chain length and stretch over time.

Item No.	Description	Qty	Number
1	Cultivator Module Slide	1	1110-10
2	M16 x 50 grade 8.8 zp Bolt	2	0211-1655 SET
3	Nyloc Nut M16	2	0221-NYL## (Nyloc Nut Metric)
4	Module Tension Adjustor	1	1110-12

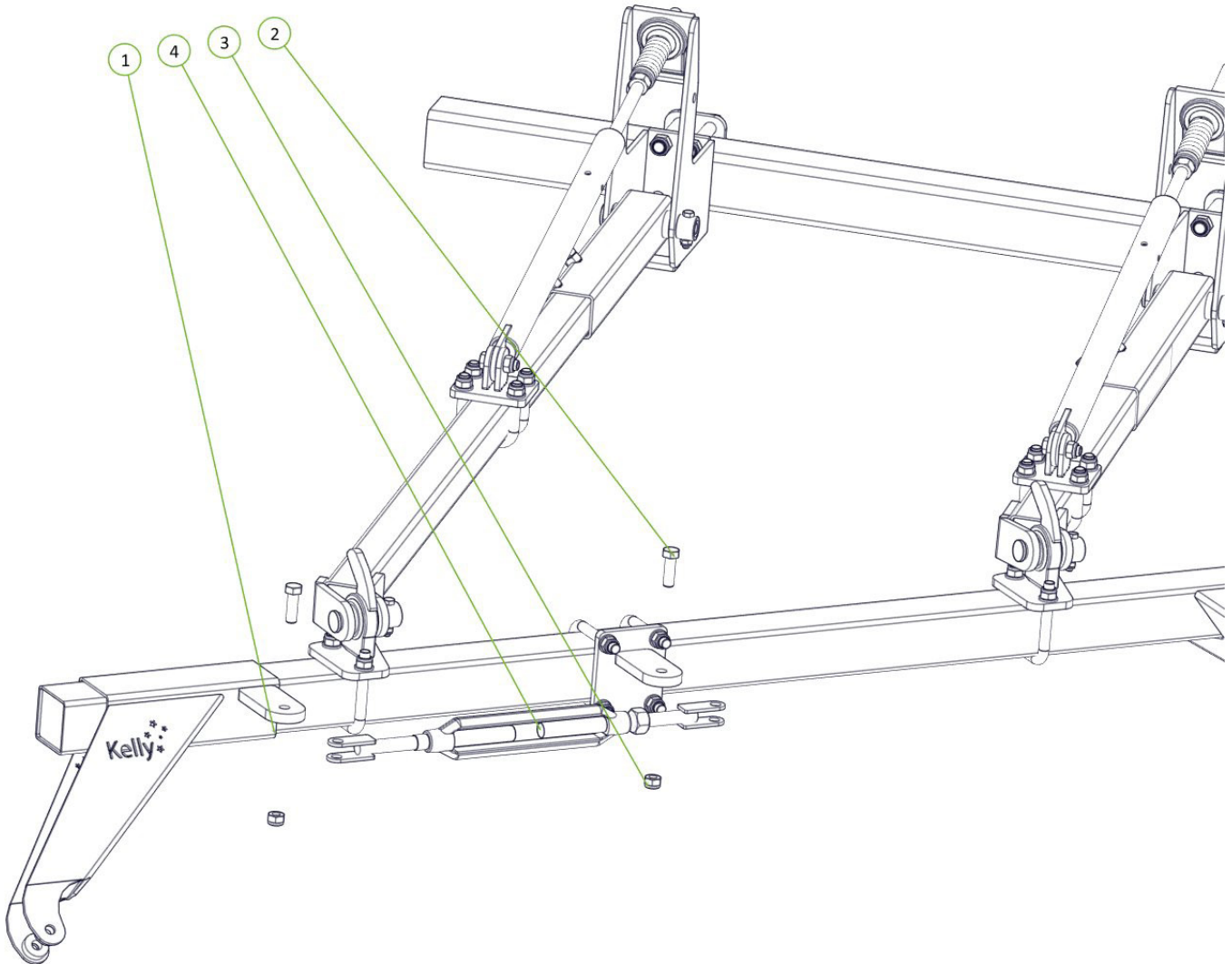

Item No.	Description	Qty	Number
1	M16 x 100 grade 8.8 zp Bolt	2	0211-1655 SET
2	Nyloc Nut M16	2	0221-NYL## (Nyloc Nut Metric)
3	38mm Shaft Swivel Unit	1	0802-PCHB45
4	38mm Shaft Swivel Unit	1	0802-PCHB45

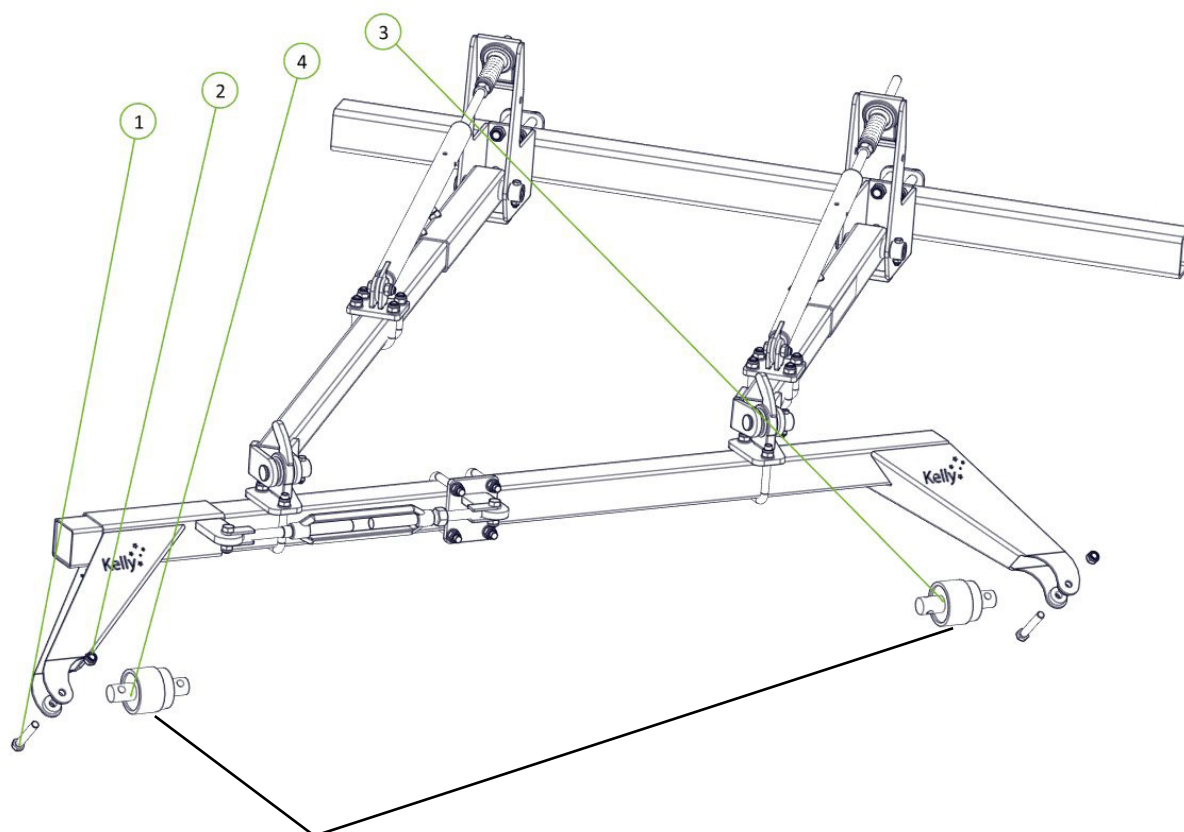

NOTE:

- Please ensure the seals on the swivel bearings are facing to the rear of the machine.

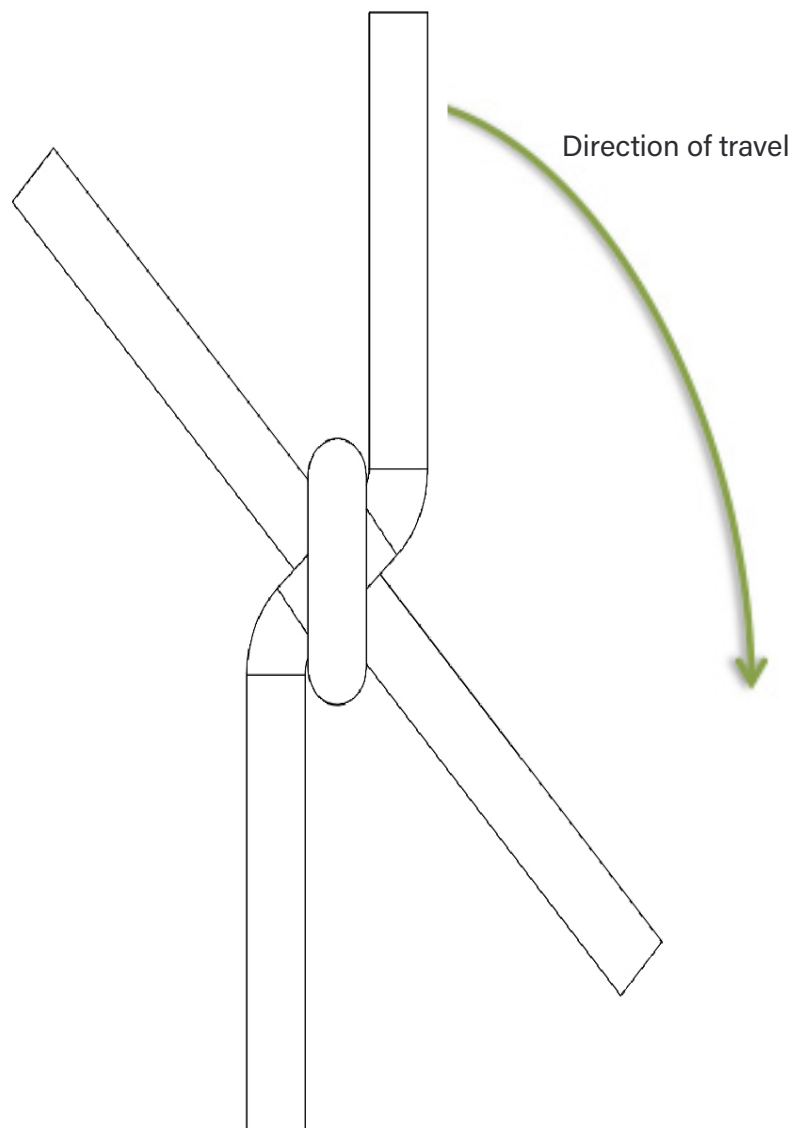
**NOTE:**

- Please ensure chain is put on the correct way. If put on the incorrect way the chain may catch stubble and straw.

Item No.	Description	Qty	Number
1	Prickle Chain Tie Plate	4	0800-82.1
2	Cultivator Module 20mm Prickle Chain (24 Link)	24	0803-PCHCM
3	M16 x 90 grade 8.8 zp Bolt	4	0211-1655 SET
4	Nyloc Nut M16	4	0221-NYL## (Nyloc Nut Metric)

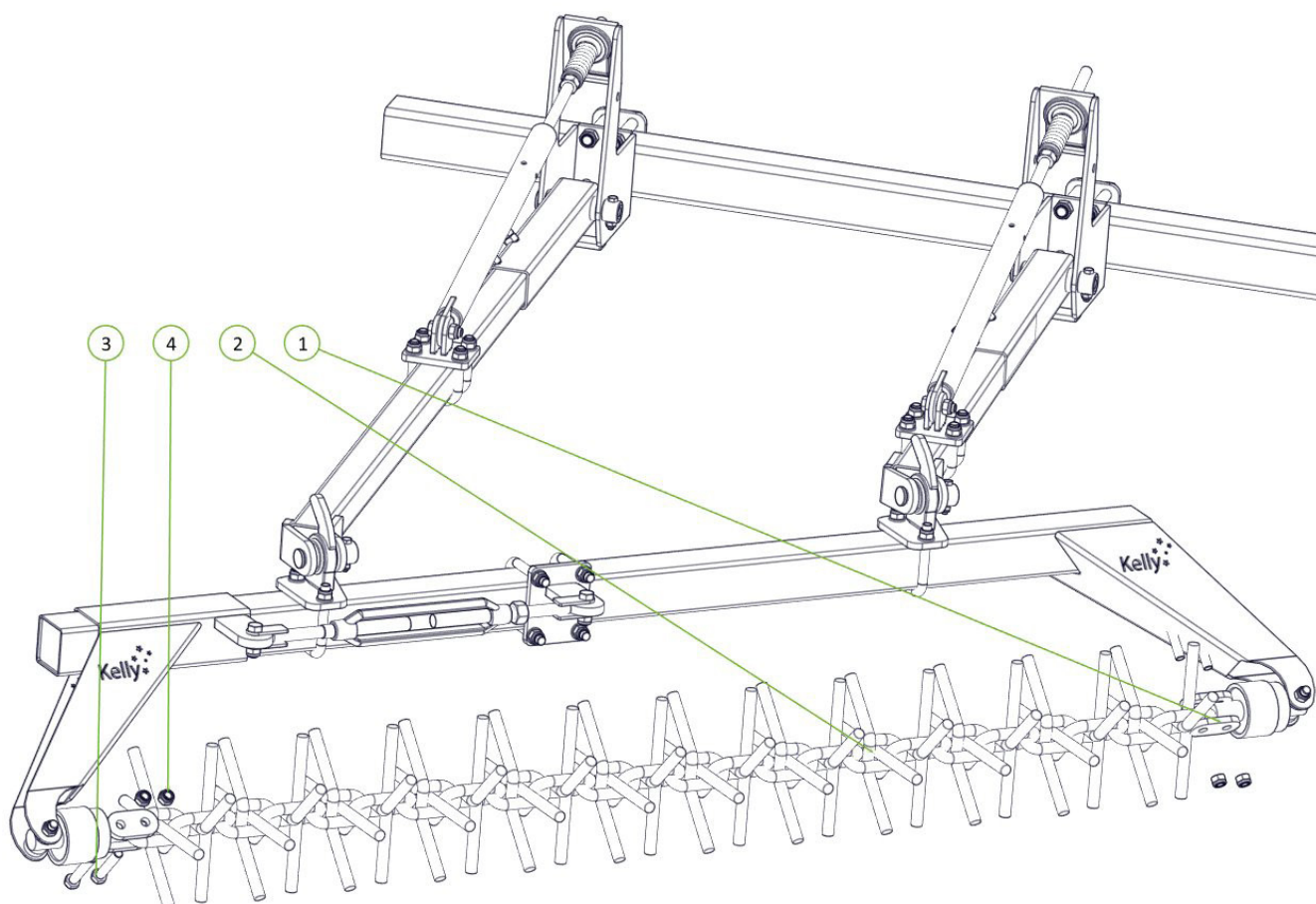

NOTE:

- To tension the screw, turn the buckle out and lock with nut.
- For prickle chain tension ensure chain is tight and links are firmly together, if too loose chain will wear prematurely.
- For correct working height have the seeder bar tines resting on hard ground.
- Please note the spring is not for down pressure and relies on the weight of the module. If lighter tillage is required please set chain higher, if the modules are set too low there is a risk of damage to the tie rod arms.
- As chain wears, if tension adjustment runs out, links become stretched or work. You may need to cur a link out to regain tension.

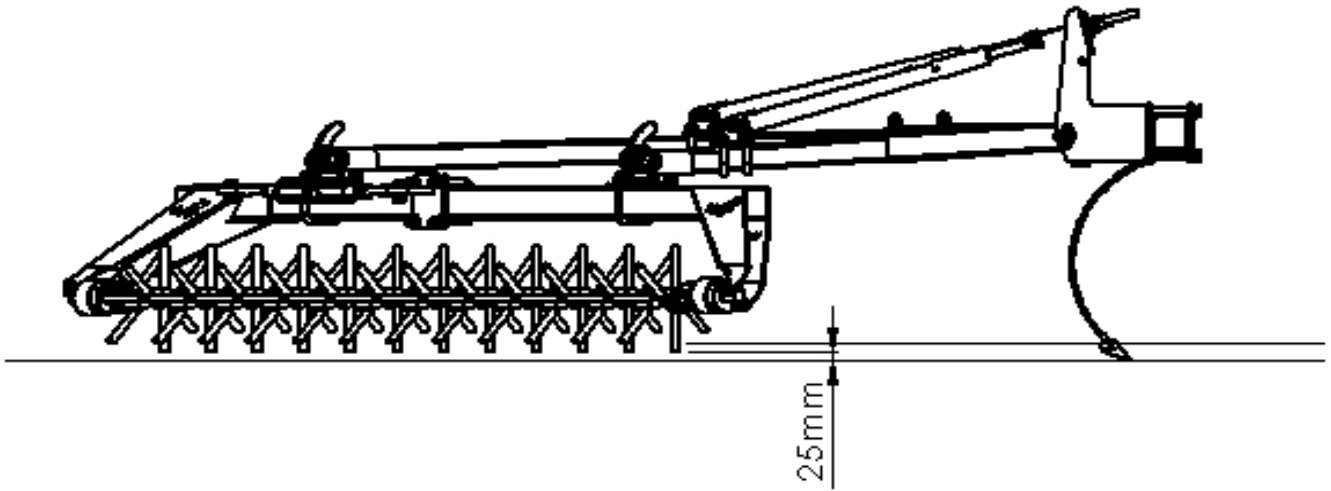

Factory Settings Height Set Up

NOTE:

- For lighter tillage applications, such as canola or vetch (at risk of burring seed too deep) adjust modules accordingly.

Notes

This image shows a single sheet of white paper with horizontal ruling lines. The lines are evenly spaced and run across the width of the page. There are no margins, text, or other markings on the paper.

[illegible]

KEASM-PCM-C-12052020



Phone +61 8 8667 2253
Email sales@kellytillage.com
kellytillage.com

Booleroo (Head Office)
684 Kelly Road,
Booleroo Centre SA 5482

Adelaide Office
28 Greenhill Road,
Wayville SA 5034

