

K4 Fitting Guide

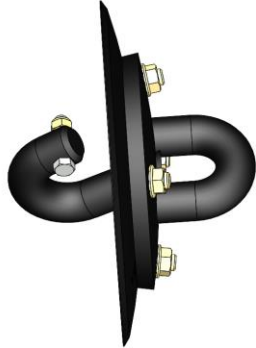

K4 disc assemblies link together with a hook and eye configuration, that is secured with a M12 locking bolt and nut, to prevent unlinking during folding or transport.

All components required to fit the K4 assemblies to your machine are provided in the kit.

FITMENT TIP: Start from the centre of the machine and work toward the wing.

Item	Description	Number	QTY
6	K4 Disc Assembly	0803-K4	1
7	M12 x 55 Bolt	0211-1255	1
8	Nyloc Nut M12	0211-NYL12	1

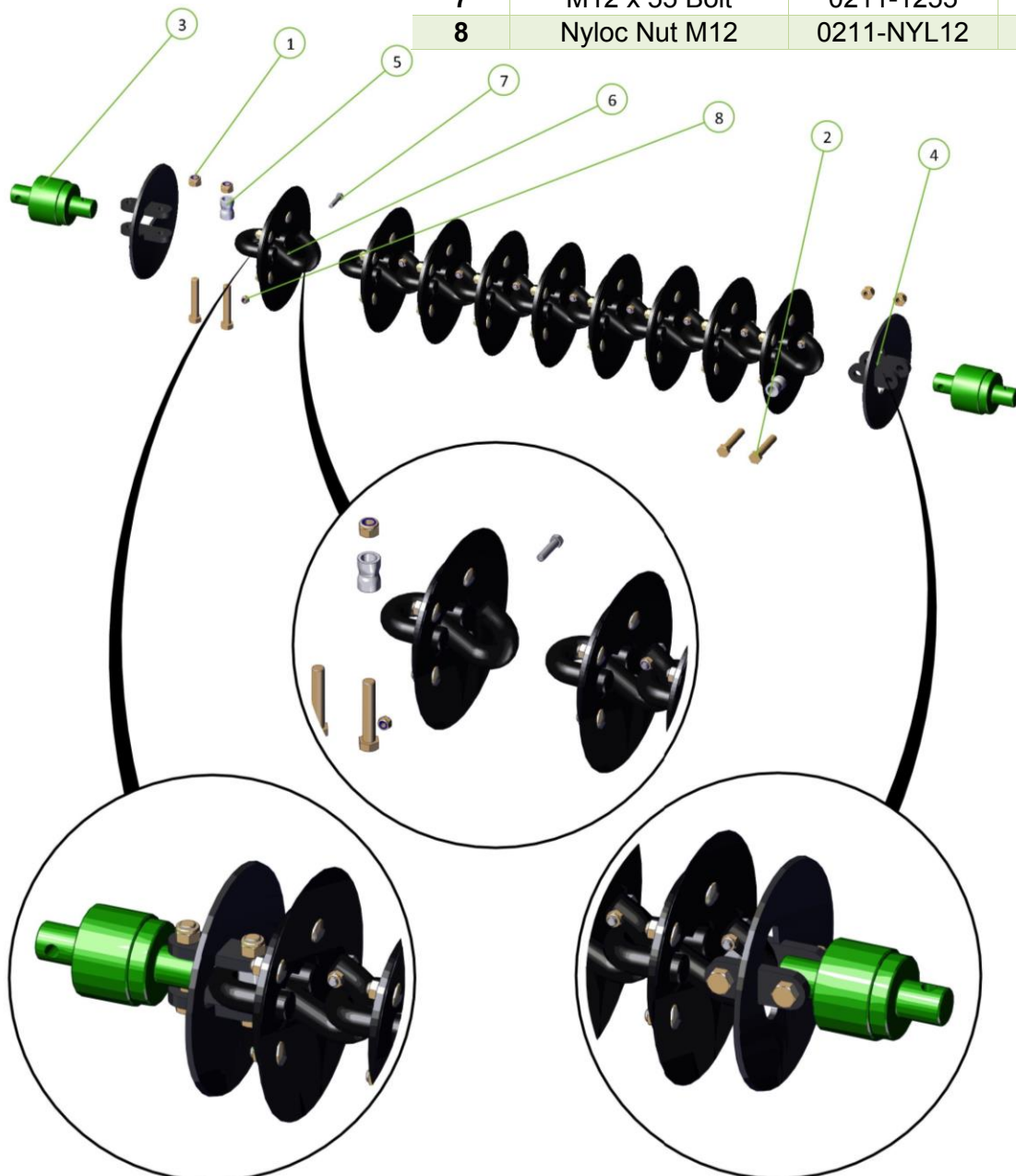

WEIGHTED DISC FOR MODULE CHAINS

For best chain performance, the module chains are to be fitted with weights.

The chain set is supplied with weight pairs and required bolts.

The recommended torque for the bolts is 150-170Nm (110-125ft/lbs).

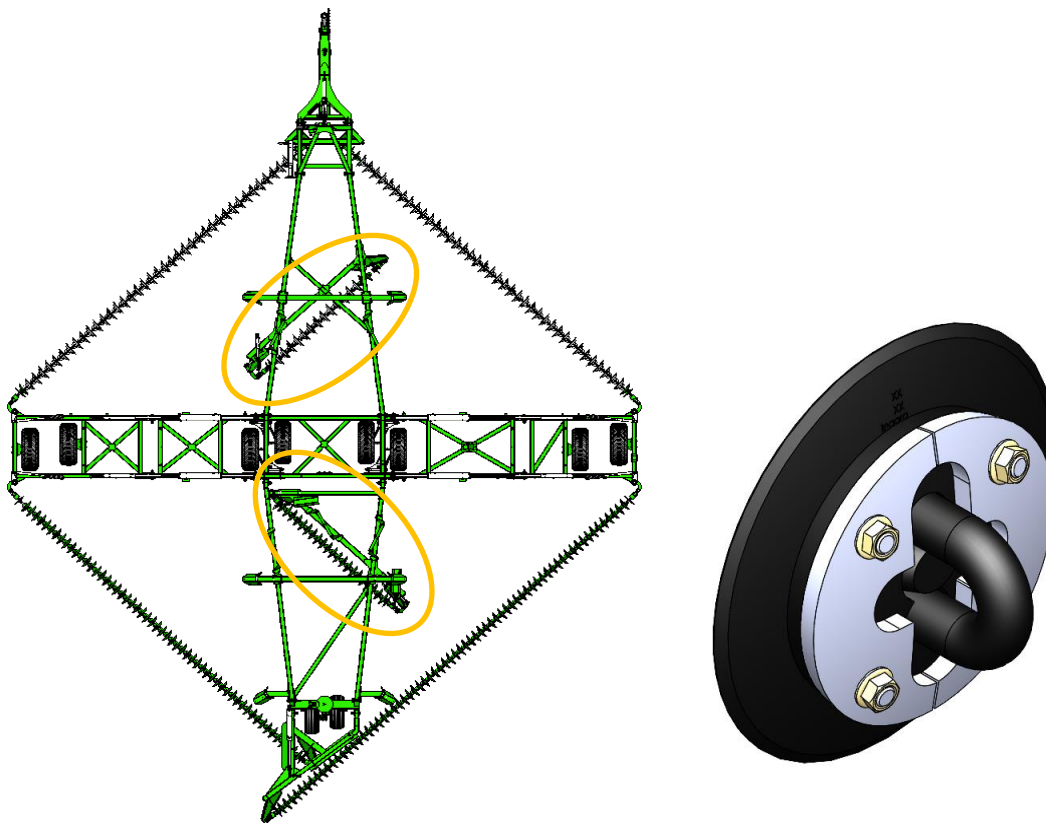

The weight pair (illustrated in grey on the right) are to be added to each of the K4 discs on the shorter module chains

NOTE:

Kelly recommends that weights are fitted to the K4 assemblies prior to installing on the machine to assist with correct bolt alignment.

The chain tension is not affected by the fitment of weights. Refer to Operators Manual for the chain tension setting.

BOLT-ON WEIGHT OPTION

To add weights to your K4 disc assembly is a simple bolt-on procedure.

You will need to replace the bolts with the longer option (item: 0215-CH5-82ZP) provided.

Item	Part Number	Description	QTY
1	0803-K4-344	K4 Weight Pair – 3.44kg	1
2	0215-CH5-82ZP	5/8" x 2" Coach Head Bolt	4

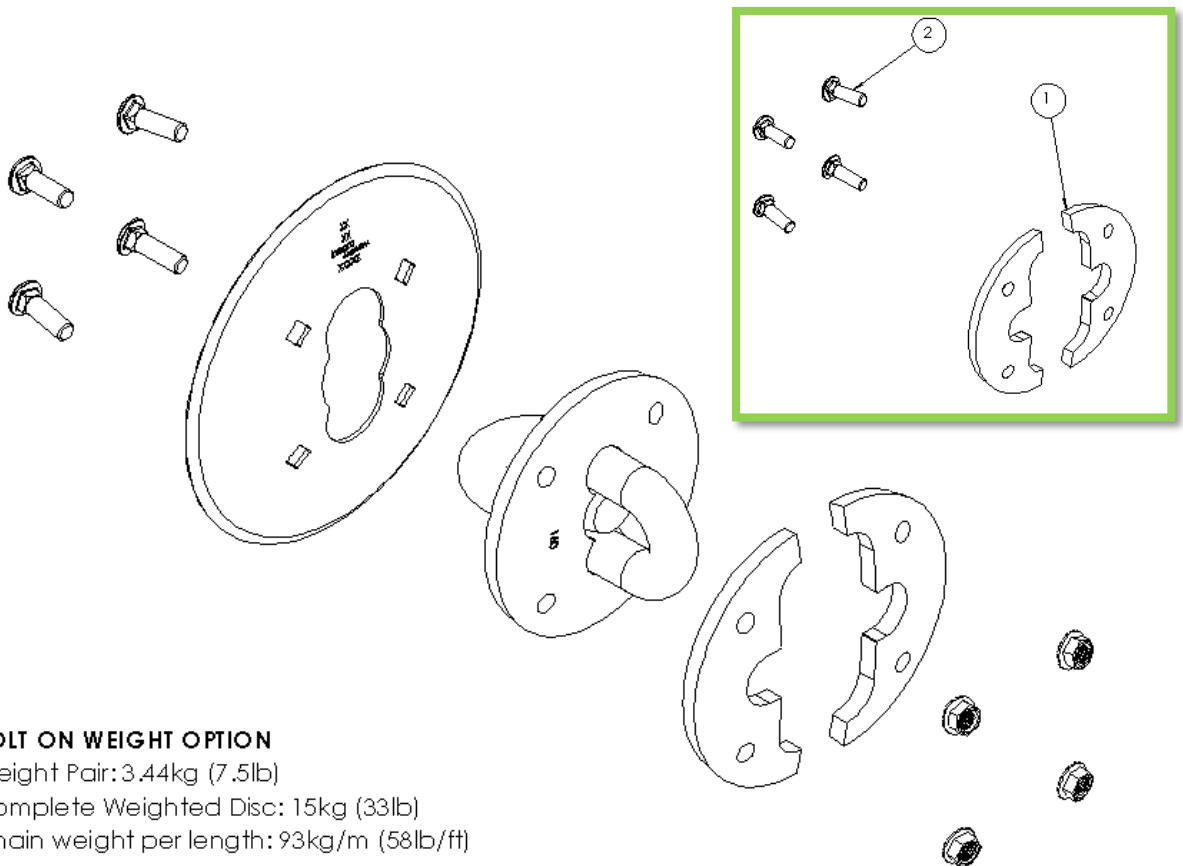

BOLT ON WEIGHT OPTION

Weight Pair: 3.44kg (7.5lb)

Complete Weighted Disc: 15kg (33lb)

Chain weight per length: 93kg/m (58lb/ft)

NOTE

- only *one* pair of weights can be fitted per disc
- the weights must be fitted as a pair

CHAIN TENSION SPRINGS

The performance of the K4 chain is improved when tensioned by a stiffer 24mm spring (0801-K2455350).

If your machine is not fitted with the heavier spring from factory, then they will be provided in your chain kit.

There is one tension spring per chain and they can be found in the following locations:

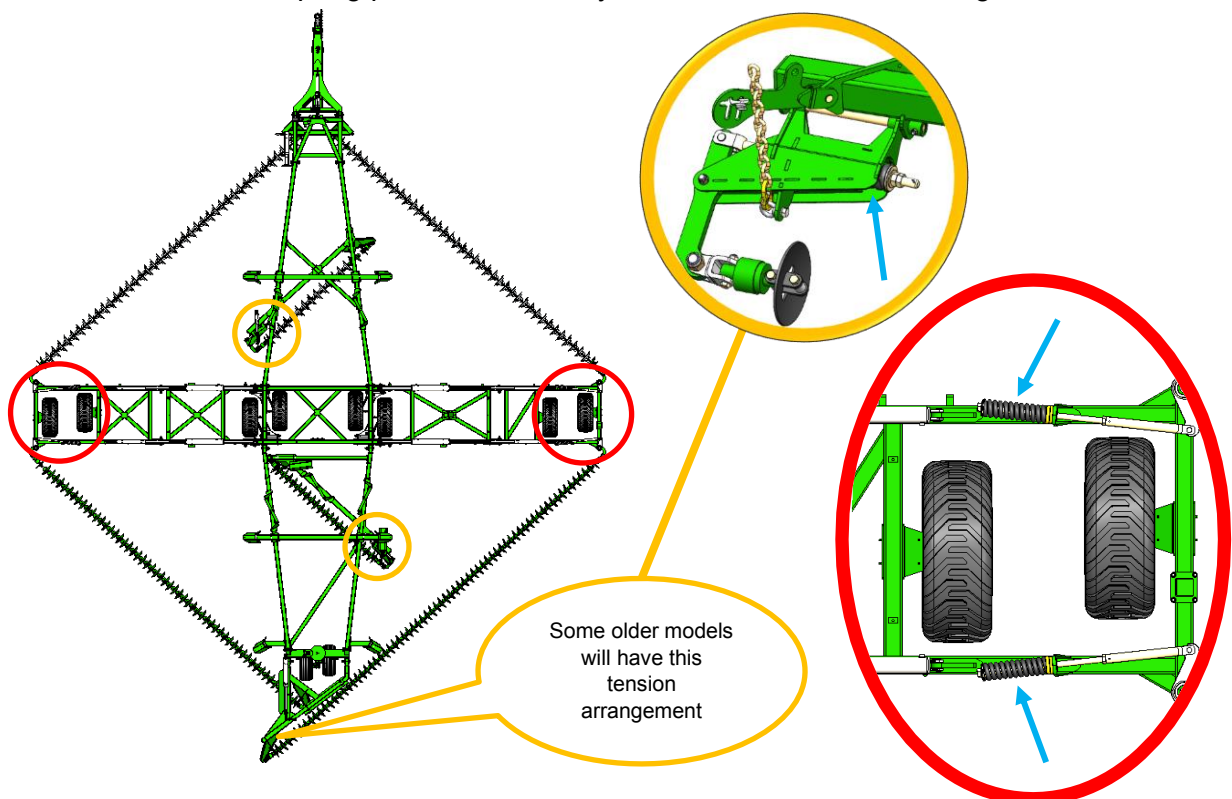

The location of springs to be exchanged (IF new springs are provided for your machine)

For guidance on tensioning your chains, please refer to your Operators Manual.

If you have any questions about correct fitting or spare parts enquiries, please do not hesitate to contact the Kelly Team at sales@kellytillage.com or refer to the Farmer Resources section of our website or your local dealer.

REPLACING DISCS

The K4 discs have discs that can be replaced.

Item	Part Number	Description	QTY
1	0215-CH5-811-2ZP	5/8" x 1 1/2" Coach Head Bolt	4
2	0222-WZ5-8	5/8" Serrated Flange Lock Nut ZP G5	4
3	0803-K4-01	K4 Disc – Smooth D330xR590x4	1
4	0803-K4-160	K4 160mm Link Fabrication	1

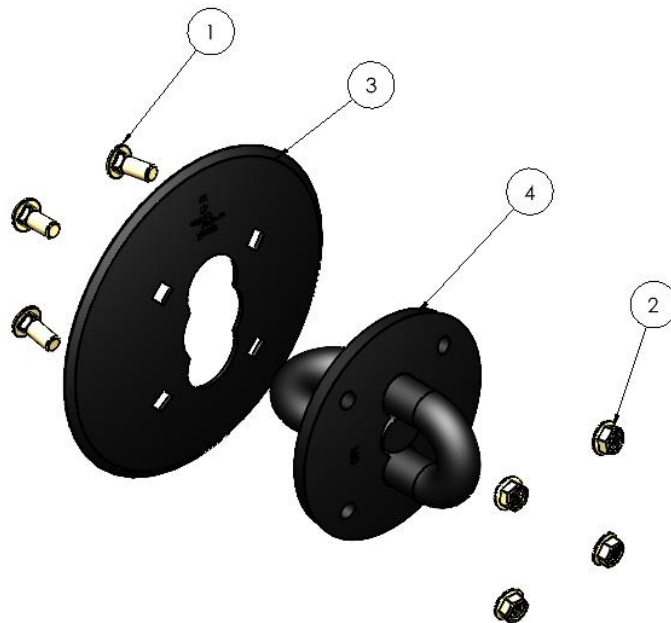

CAUTION

Do not attempt to change over the discs while the chain is under tension. Refer to your Operators Manual for correct chain tensioning procedure.

- ☆ With the chain tension released, the locking bolts can be removed and each assembly can be unlinked from the chain.
- ☆ When reassembling the discs, the recommended torque for the bolts is 150-170Nm (110-125ft/lbs).

FITTING REPLACEMENT DISCS

The assembly of the K4 disc assemblies is made easier with the use of a simple stand, such as illustrated below.



1. Place disc on the stand, concave side facing down
2. Lower the fabricated body through the centre slot in the blade, with the hook facing down.
3. Insert each coach head bolt from the underside. The head of the bolt will engage with the holes to prevent rotation.
4. Secure each serrated flange nut to finger tight.
5. With all four bolts in place, use a spanner or socket to achieve a fastening torque of 150-170Nm (110-125ft/lbs).